

**TRANSTECNO**<sup>TM</sup>  
THE MODULAR GEARMOTOR

**PU**

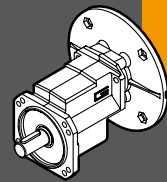

***RIDUTTORI AD INGRANAGGI MONOSTADIO***  
***SINGLE STAGE HELICAL GEARBOXES***



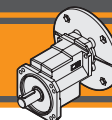

<b>Indice</b>	<b>Index</b>	Pag. Page
Caratteristiche tecniche	<i>Technical features</i>	<b>F2</b>
Designazione	<i>Classification</i>	<b>F2</b>
Sensi di rotazione	<i>Direction of rotation</i>	<b>F2</b>
Lubrificazione	<i>Lubrication</i>	<b>F3</b>
Carichi radiali	<i>Radial loads</i>	<b>F3</b>
Simbologia	<i>Symbols</i>	<b>F3</b>
Dati tecnici	<i>Technical data</i>	<b>F3</b>
Motori applicabili	<i>IEC Motor adapters</i>	<b>F4</b>
Dimensioni	<i>Dimensions</i>	<b>F4</b>

Questa sezione annulla e sostituisce ogni precedente edizione o revisione. Qualora questa sezione non Vi sia giunta in distribuzione controllata, l'aggiornamento dei dati ivi contenuto non è assicurato. **In tal caso la versione più aggiornata è disponibile sul nostro sito internet [www.transtecno.com](http://www.transtecno.com)**

*This section replaces any previous edition and revision. If you obtained this catalogue other than through controlled distribution channels, the most up to date content is not guaranteed. **In this case the latest version is available on our web site [www.transtecno.com](http://www.transtecno.com)***

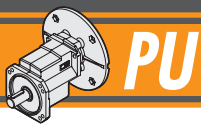

# RIDUTTORI AD INGRANAGGI CILINDRICI MONOSTADIO SINGLE STAGE HELICAL GEARBOXES

## Caratteristiche tecniche

I riduttori monostadio ad ingranaggi cilindrici della serie PU hanno le seguenti caratteristiche principali:

- Carcassa, flangia entrata e flangia uscita in pressofusione di alluminio;
- Ingranaggi rettificati;
- Lubrificazione permanente con olio sintetico.

## Technical features

PU range single stage helical gearbox has the following main features:

- Die-cast aluminum housings, input and output flanges;
- Ground-hardened helical gears;
- Permanent synthetic oil long-life lubrication.

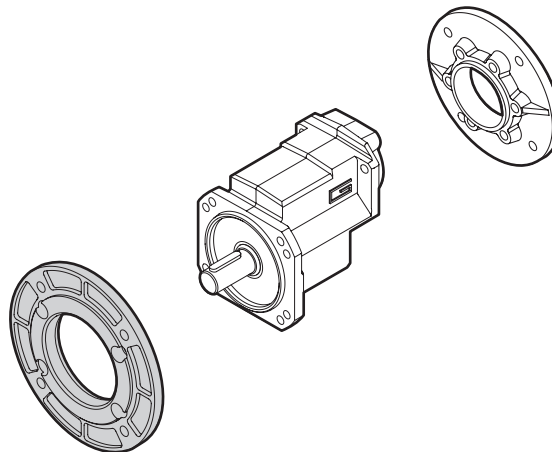

## Designazione

## Classification

RIDUTTORE / GEARBOX						
PU	01	FT1	5.70	71	B5	O3
Tipo Type	Grandezza Size	Versione Version	Rapporto Ratio	IEC 	Forma costruttiva Version	Diam. Albero uscita Output shaft diam.
	01	U FT1 FT2 FT3	5.70 8.57	63 71 80	B5 B14	vedi tabelle see tables

MOTORE / MOTOR				
0.25kW	4p	3ph	50Hz	T1
Potenza Power	Poli Poles	Fasi Phases	Frequenza Frequency	Pos. morsettiere Terminal box pos.
Vedi tabelle See tables	2p 4p 6p 8p	1ph 3ph	50Hz 60Hz	T1 (Std)  T4 T3

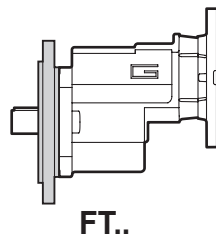
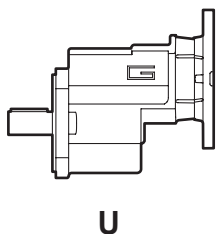

## Sensi di rotazione

## Direction of rotation

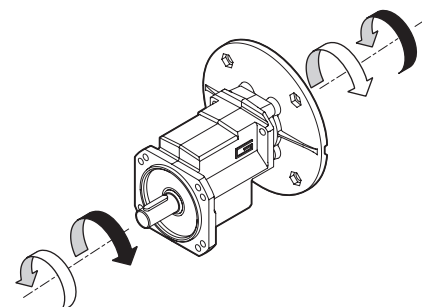

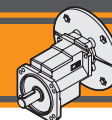

**Lubrificazione**

**Lubrication**

Tutti i riduttori della serie PU sono forniti completi di lubrificante sintetico viscosità 320, pertanto possono essere installati in qualunque posizione di montaggio e non necessitano di manutenzione.

Permanent synthetic oil long-life lubrication (viscosity grade 320) makes it possible to use PU range in all mounting positions.

**Carichi radiali**

**Radial loads**

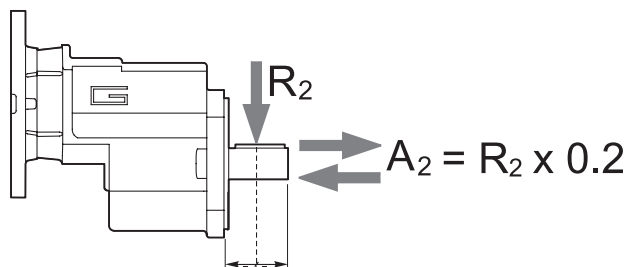

n <sub>2</sub> [min <sup>-1</sup> ]	R <sub>2</sub> [N]
	PU 01
500	643
400	693
300	763
250	810
200	873
150	961
100	1100



**Simbologia**



**Symbols**

- n<sub>1</sub> [min<sup>-1</sup>] Velocità in ingresso / *Input speed*
- n<sub>2</sub> [min<sup>-1</sup>] Velocità in uscita / *Output speed*
- i Rapporto di riduzione / *Ratio*
- P<sub>1</sub> [kW] Potenza in entrata / *Input power*
- M<sub>2</sub> [Nm] Coppia nominale in uscita in funzione di P<sub>1</sub> / *Output torque referred to P<sub>1</sub>*
- sf Fattore di servizio / *Service factor*
- R<sub>2</sub> [N] Carico radiale ammissibile in uscita / *Permitted output radial load*
- A<sub>2</sub> [N] Carico assiale ammissibile in uscita / *Permitted output axial load*

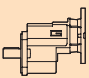
**Dati tecnici**

**Technical data**

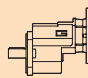
P <sub>1</sub> [kW]	n <sub>2</sub> [min <sup>-1</sup> ]	M <sub>2</sub> [Nm]	sf	i		
<b>0.18</b>						
63A4 (1400 min <sup>-1</sup> )	246 163	6.7 10.0	7.5 5.0	5.70 8.57	PU01 PU01	B5/B14 B5/B14
<b>0.22</b>						
63B4 (1400 min <sup>-1</sup> )	246 163	8.2 12.3	6.1 4.1	5.70 8.57	PU01 PU01	B5/B14 B5/B14
<b>0.25</b>						
71A4 (1400 min <sup>-1</sup> )	246 163	9.4 14	5.3 2.8	5.70 8.57	PU01 PU01	B5/B14 B5/B14
<b>0.37</b>						
71B4 (1400 min <sup>-1</sup> )	246 163	14 21	3.6 1.9	5.70 8.57	PU01 PU01	B5/B14 B5/B14

P <sub>1</sub> [kW]	n <sub>2</sub> [min <sup>-1</sup> ]	M <sub>2</sub> [Nm]	sf	i		
<b>0.55</b>						
71C4 (1400 min <sup>-1</sup> )	246 163	21 31	2.4 1.3	5.70 8.57	PU01 PU01	B5/B14 B5/B14
80A4 (1400 min <sup>-1</sup> )	246 163	21 31	2.4 1.3	5.70 8.57	PU01 PU01	B5/B14 B5/B14
<b>0.75</b>						
80B4 (1400 min <sup>-1</sup> )	246 163	28 42	2.4 0.9	5.70 8.57	PU01 PU01	B5/B14 B5/B14
<b>1.1</b>						
80B4 (1400 min <sup>-1</sup> )	246	41	1.2	5.7	PU01	B5/B14

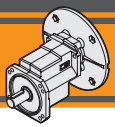

**PU**

**RIDUTTORI AD INGRANAGGI CILINDRICI MONOSTADIO**  
**SINGLE STAGE HELICAL GEARBOXES**

**Motori applicabili**

**IEC Motor adapters**

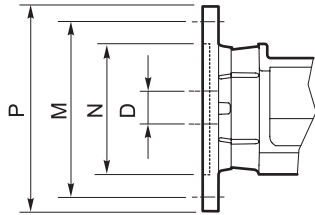

	IEC	N	M	P	D	i (rapporto / ratio)	
						5.70	8.57
<b>PU01</b>	<b>80 B5</b>	130	165	200	19		
	<b>80 B14</b>	80	100	120	19		
	<b>71 B5</b>	110	130	160	14	<b>B</b>	
	<b>71 B14</b>	70	85	105	14		
	<b>63 B5</b>	95	115	140	11	<b>BS</b>	
	<b>63 B14</b>	60	75	90	11		

**Dimensioni**

**Dimensions**

**PU01 U**

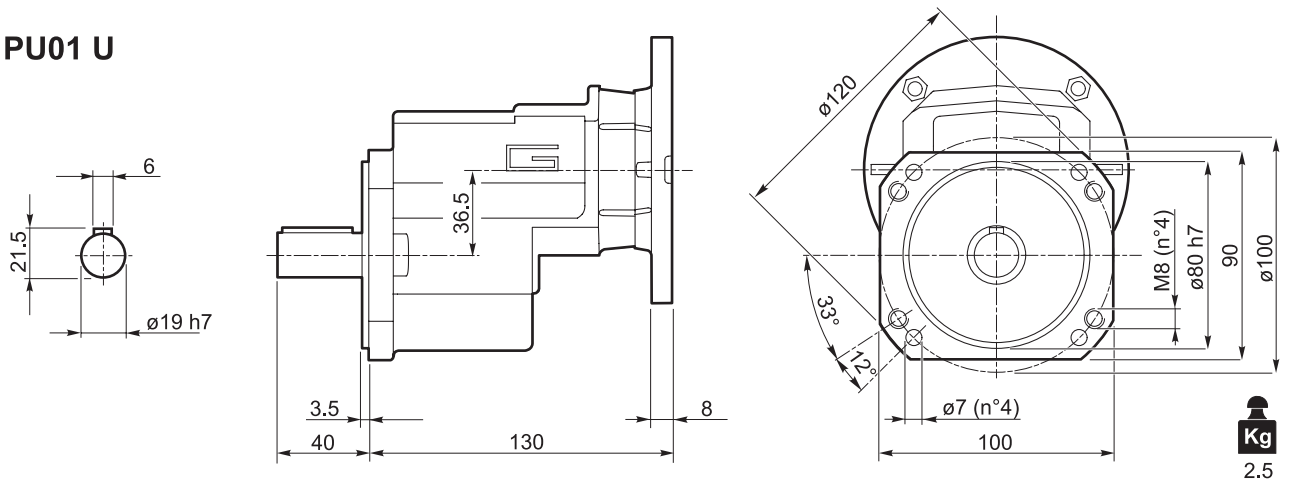

**PU01 FT..**

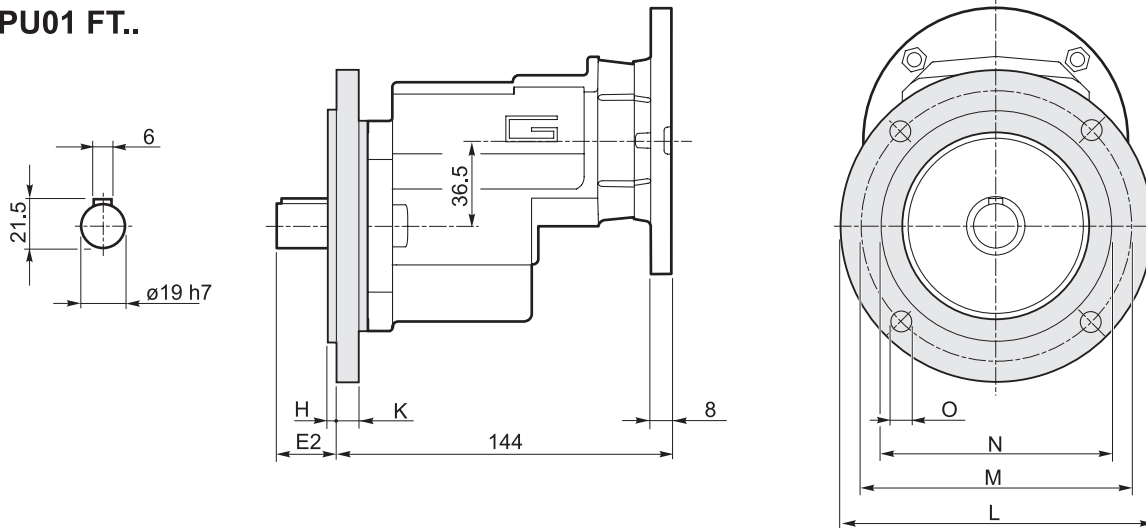

		Versione / Version							Peso / Weight [kg]
		E <sub>2</sub>	H	K	L	M	N f7	O	
<b>PU01</b>	<b>FT1</b>	26	3	10	140	115	95	M8	0.3
	<b>FT2</b>	26	3.5	10	160	130	110	9	0.4
	<b>FT3</b>	26	3.5	10	200	165	130	11	0.5

## HEADQUARTERS



TRANSTECNO SRL  
Via Caduti di Sabbiano, 11 D/E  
40011 Anzola Emilia (BO) - ITALY  
Tel. +39.051.6425811  
Fax +39.051.734943  
info@transtecno.com  
www.transtecno.com

## MANUFACTURING PLANT



HANGZHOU TRANSTECNO  
POWER TRANSMISSIONS CO; LTD  
26, No.1 Street  
Hangzhou Economic  
& Technological  
Development Area  
Hangzhou - CHINA  
Tel. +86.571.86921603  
Fax +86.571.86921810  
info-china@transtecno.com  
www.transtecno.cn

## SALES OFFICES & WAREHOUSES



GEARTECNO ITALIA SRL  
Via Ferrari, 27/11  
41043 Fraz. Corlo,  
Formigine (MO) - ITALY  
Tel. +39.059.557522  
Fax +39.059.557439  
info@geartecno.com  
www.geartecno.com



GEARTECNO HOLLAND B.V.  
De Stuwdam 43  
ind. terrein Wieken/Vinkenhoeft  
3815 KM Amersfoort  
THE NETHERLANDS  
Tel. +31.(0)33.4519505  
Fax +31.(0)33.4519506  
info@geartecno.nl  
www.geartecno.nl

  
**TRANSTECNO**<sup>TM</sup>  
THE MODULAR GEARMOTOR

[www.transtecno.com](http://www.transtecno.com)

## SALES OFFICES



SALES OFFICE BRAZIL  
Rua Dr. Freire Alemão 155 / 402  
CEP. 90450-060  
Auxiliadora Porto Alegre-RS-BRAZIL  
Tel. +55.51.3251.5447  
Fax +55.51.3251.5447  
Mobile +55 51 811 45 962  
braziloffice@transtecno.com  
www.transtecno.com.br



SALES OFFICE OCEANIA  
Unit 7, 387-393 Old Geelong  
Road, Hoppers Crossing,  
Victoria 3029 - AUSTRALIA  
Tel. +61.03.9369.9774  
Fax +61.03.9369.9775  
Mobile +61.0438.060.997  
oceaniaoffice@transtecno.com



SALES OFFICE SPAIN  
C/Major, Nr.1  
17256 Fontclara - SPAIN  
Tel. +34.626141978  
spainoffice@transtecno.com  
www.transtecno.es



SALES OFFICE EASTERN  
EUROPE & MIDDLE EAST  
St. Magnolienweg 4  
D-31860 Emmerthal - GERMANY  
Tel. +49.5151.963076  
Fax +49.5151.963076  
Mobile +49.172.4044907  
emeoffice@transtecno.com



SALES OFFICE USA  
509 10th St Alton, Iowa,  
51003 - USA  
Tel: +1 712-540-9080  
usaoffice@transtecno.com



SALES OFFICE SOUTH KOREA  
D-248, Namdong Industrial  
Complex 631,  
Gojan-dong Namdong-gu Incheon,  
KOREA  
Tel. +82 70 8288 2107  
Fax. +82 32 815 2107  
Mobile: +82 10 5094 2107  
koreaoffice@transtecno.com



SALES OFFICE GUANGZHOU  
Room 832, Wannu International  
No.167,  
Linhe west road, Guangzhou City,  
CHINA  
Tel:+ 86 20 38776057  
Fax: + 86 20 38776127  
Mobile: + 86.139.25169633  
guangzhouoffice@transtecno.com