

### UniGard™

Pin and Sleeve IEC Connectors . . . . .	78
Safety, Performance and Durability . . . . .	79
The UniGard™ Difference . . . . .	80
Global Configuration Standards . . . . .	81
UniGard™ Watertight and Splashproof Pin and Sleeve Devices IP67 and IP44. . . . .	82-85
UniGard™ Watertight Pin and Sleeve Devices IP67. . . . .	86, 87
UniGard™ IEC 309 Safety Interlock . . . . .	88-90, 95, 100
IEC International Connections. . . . .	91, 92
North American Amperages—UniGard™ Series Specifications . . . . .	93
International Amperages—UniGard™ Series Specifications . . . . .	94
UniGard™ Series IP44 Dimensions. . . . .	96
UniGard™ Series IP67 Dimensions . . . . .	97-98
UniGard™ IEC 309 Boxes and Adapters. . . . .	99
Cross-Reference Ordering Guide . . . . .	101
Product Cross-Reference . . . . .	102

# Russellstoll®

## UniGard™ Pin and Sleeve IEC Connector

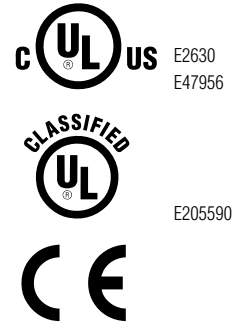

**Beverage  
Plants**



**Construction  
Sites**



**Food  
Processing**

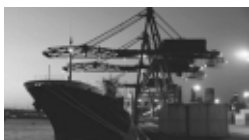

**Marine and  
Shipboard**



**Pulp &  
Paper Mills**



**Chemical  
Plants**

### ***Safety, Performance and Durability... In A Snap!***

#### **Extensive Product Family**

- Safe and reliable, portable electrical connections.
- Wide variety of Plugs, Connectors, Receptacles, Inlets and Mounting Boxes.
- Watertight (IP67) and Splashproof (IP44) versions available.
- 20, 30, 60 and 100 Amp ratings for small, medium or large current loads.
- cULus Listed for North American ratings.
- UL classified to IEC 309-1 and IEC 309-2 for North American and International ratings.
- Complete interchangeability with all manufacturers' IEC 309-1 and IEC 309-2 devices.
- Meets IEC 309 global configurations for safety in industrial applications.

#### **Watertight**

- Watertight design and construction meet stringent IP67 internal protection standards.
- Rugged thermoplastic housings resist impact or abuse and provide excellent corrosion resistance.
- Unique Thomas & Betts strain relief grip and sealing system assure superior cable retention and watertight conductor termination.
- Ideal for outdoor, wet, marine and washdown applications.
- Unique 75% faster assembly with EZ Klik™ handle locking, and EZ Tite™ cable grip system.

#### **Splashproof**

- Suitable for indoor use where splashing liquids and other contaminants may interfere with electrical connections.
- Ideal for most heavy commercial applications and light industrial applications.
- Available in 20 and 30 Amp ratings.

### EZ Klik™ locking mechanism



#### Self-Aligning Solid Contacts

- Self-aligning Nickel plated full-round pins and sleeves for maximum cool contact area.
- Sleeve pressure rings ensure constant surface contact force.
- Nickel plating offers maximum corrosion resistance for any use.

#### Screw Collars Stay Put

Turreted grip allows for easy handling.

#### The Easy Way

EZ Klik™ locking feature on all 20/30A plugs and connectors.

#### 75% Faster Cable Assembly EZ Tite™ System

- One-piece cable gland.
- Nylon locking screw prevents loosening.
- Easy hand assembly of cable gland, Grip Tite™ 6-Finger clamp and onion-ring bushing.

#### Safe Connections Standard

Ground contacts make first, break last for safe connections even under load.

#### Combination Flap/Screw Cover

- Integral neoprene gasket for IP67 Watertight protection.
- Standard flap cover for IP44 Splashproof protection.
- Unique flex hinge design.

#### Neoprene Cable Bushing

- Onion ring design.
- Universal fit capability.

#### Solid Neoprene Gasket In Handle

#### Grip Tite™ 6-Finger Clamp

Provides superior cable retention.

#### Secure Grip Handle

- Tapered shoulder (20 and 30A).
- Ribbed shoulder (60 and 100A).

#### Raised Ground Terminal

Ensures safe connections every time.

#### Fast and Easy Wiring

- Unique, one-way terminal access.
- Clearly marked terminal connections.

#### Double Secure Wiring

Dual, combination point terminal screws for failsafe connections.

#### Standard Interface / World Ready Full International Compliances

EN60309

UL Classification to IEC 309-1 and IEC 309-2.

cULus Listing: UL 1682/1686 and CSA C22.2 No. 182.1.

CE conforms to EC Low Voltage Directive.

North American and Global Voltage Polarization "clock positions" available in all standard ratings.



#### Safe Voltage Selections

One-Piece contact carriers with Full-Colour IEC standard voltage-phasing. Coding ensures correct product application every time.

## Features

---



### No Tools, No Screws Necessary

- EZ Klik™ locking handle saves 75% on assembly time.
- Unique EZ Klik™ assembly feature on 20 and 30 Amp plugs and connectors makes installation and inspection fast and reliable.
- Captured gaskets in handles seal out water, chemicals and dust.



### Easy Action Single-Wiring Point Access Saves Time Wiring

- All terminal screws face in same direction allowing installer to make safe and secure conductor terminations in 30% less time than other devices.
- Rugged, corrosion free thermoplastic housings are colour-coded for safe and reliable connections to all other mating type/polarizations, with raised ground terminal standard.



### Simple Cable Clamping

- Threaded EZ Tite™ cable gland on 20 and 30 Amp devices makes assembly fast and easy.
- One-piece lock screw clamps locking hold, with no external metal contact possible. (20 and 30 Amp devices)

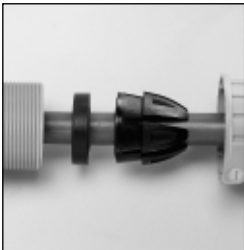

### Unique Fast Assembly

- One-piece EZ Tite™ cable gland with locking screw loads to cable followed by Grip Tite™ 6-Finger cable clamp/grip piece.
- Watertight onion ring bushing fits a wide variety of outside diameters.



### Watertight and Grip Tite™ Safety

- Grip Tite™ flexible 6-finger clamp teeth holds well beyond all agency test pullout forces.
- No internal clamps required.
- Available in all amperages.

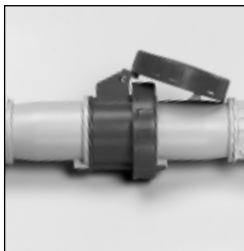

### The Performance Connection

- Watertight spring-loaded covers with high-strength flex-hinge screw covers on IP67 devices.
- Flap covers on IP44 splashproof styles.
- Safety, performance and durability for all IEC 309 applications worldwide.



# 16 Amp

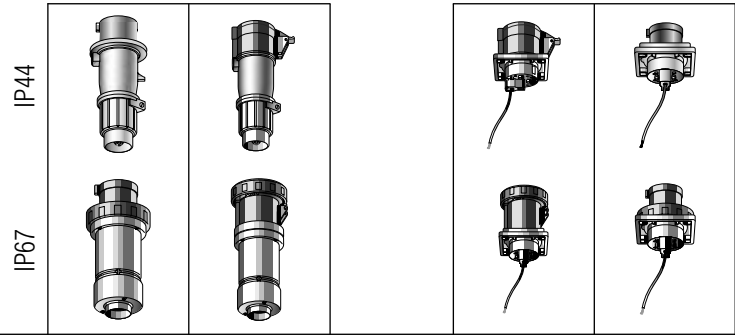

	Poles & Wires	Configuration			Voltage/ Colour Coding	Plug	Connector	Cable O.D. Range Inches	Receptacle*	Inlet*
		Receptacle/ Connector	Plug/ Inlet	Clock Hour						
<b>16 Amp IP44</b>	2P3W			4h	110V	RS316P4S	RS316C4S	.57-.71	RS316R4S	RS316B4S
	2P3W			6h	250V	RS316P6S	RS316C6S	.57-.71	RS316R6S	RS316B6S
	3P4W			6h	380-415V	RS416P6S	RS416C6S	.57-.71	RS416R6S	RS416B6S
	4P5W			6h	220-240/ 380-415V	RS516P6S	RS516C6S	.57-.71	RS516R6S	RS516B6S

<b>16 Amp IP67</b>	2P3W			4h	110V	RS316R4W	RS316P4W	.57-.71	RS316C4W	RS316B4W
	2P3W			6h	240V	RS316R6W	RS316P6W	.57-.71	RS316C6W	RS316B6W
	3P4W			6h	380-415V	RS416R6W	RS416P6W	.57-.71	RS416C6W	—
	4P5W			6h	220/380V 240/415V	RS516R6W	RS516P6W	.57-.71	RS516C6W	RS516B6W

\*See Page 99 for back box/mounting options.

■ Red is for Euro.

■ Blue is for devices supplied in North America.

Colour difference does not affect mating.

Contact your Regional Sales Office for inlet/receptacle mounting components.

UL Listing E2630, E47956

UL Classification E205590

### Liquidtight Conduit Adapter Kit

2LTK4C50 16A 3 & 4W 1/2" NPT

3LTK4C75 16A 5W 3/4" NPT

## UniGard™ Watertight and Splashproof Pin and Sleeve Devices IP67 and IP44

# 20 Amp



IP67 Shown

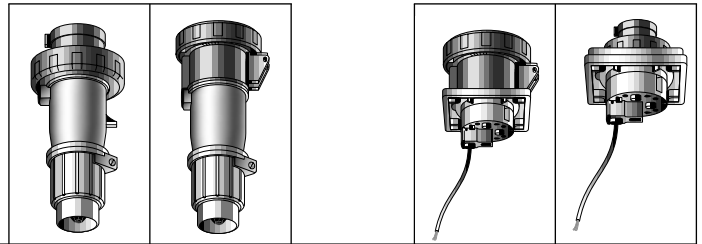

	Poles & Wires	Configuration			Voltage/ Colour Coding	Plug	Connector	Cable O. D. Range Inches	Receptacle*	Inlet*
		Receptacle/ Connector	Plug/ Inlet	Clock Hour						
<b>WATERTIGHT IP67</b>	2P3W			4h	125	RS320P4W	RS320C4W	.57-.71	RS320R4W	RS320B4W
	2P3W			6h	250	RS320P6W	RS320C6W	.57-.71	RS320R6W	RS320B6W
	2P3W			5h	277	RS320P5W	RS320C5W	.57-.71	RS320R5W	RS320B5W
	2P3W			7h	480	RS320P7W	RS320C7W	.57-.71	RS320R7W	RS320B7W
	3P4W			12h	125/250	RS420P12W	RS420C12W	.57-.71	RS420R12W	RS420B12W
	3P4W			9h	3Ø250	RS420P9W	RS420C9W	.57-.71	RS420R9W	RS420B9W
	3P4W			7h	3Ø480	RS420P7W	RS420C7W	.57-.71	RS420R7W	RS420B7W
	3P4W			5h	3Ø600	RS420P5W	RS420C5W	.57-.71	RS420R5W	RS420B5W
	4P5W			9h	3ØY120/208	RS520P9W	RS520C9W	.57-.71	RS520R9W	RS520B9W
	4P5W			7h	3ØY277/480	RS520P7W	RS520C7W	.57-.71	RS520R7W	RS520B7W
	4P5W			5h	3ØY347/600	RS520P5W	RS520C5W	.57-.71	RS520R5W	RS520B5W

IP44 Construction: No screw collars on male devices; female devices have flap covers only.

<b>SPLASHPROOF IP44</b>	2P3W			4h	125	RS320P4S	RS320C4S	.57-.71	RS320R4S	RS320B4S
	2P3W			6h	250	RS320P6S	RS320C6S	.57-.71	RS320R6S	RS320B6S
	2P3W			5h	277	RS320P5S	RS320C5S	.57-.71	RS320R5S	RS320B5S
	3P4W			12h	125/250	RS420P12S	RS420C12S	.57-.71	RS420R12S	RS420B12S
	3P4W			9h	3ph.250	RS420P9S	RS420C9S	.57-.71	RS420R9S	RS420B9S
	4P5W			9h	3ph.120/208	RS520P9S	RS520C9S	.57-.71	RS520R9S	RS520B9S

\*See Page 99 for back box/mounting options.

UL Listing E2630, E47956  
UL Classification E205590

### Liquidtight Conduit Adapter Kit

2LTK4C50 20A 3 & 4W 1/2" NPT

3LTK4C75 20A 5W 3/4" NPT

# Russellstoll®

## UniGard™ Watertight and Splashproof Pin and Sleeve Devices IP67 and IP44

# 30 Amp



IP67 Shown

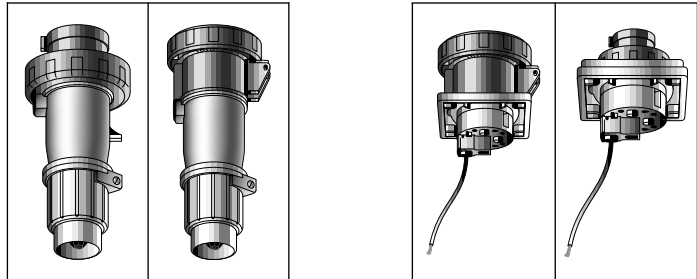

	Poles & Wires	Configuration			Voltage/ Colour Coding	Plug	Connector	Cable O.D. Range Inches	Receptacle*	Inlet*
		Receptacle/ Connector	Plug/ Inlet	Clock Hour						
<b>WATERTIGHT IP67</b>	2P3W			4h	125	RS330P4W	RS330C4W	.675-.91	RS330R4W	RS330B4W
	2P3W			6h	250	RS330P6W	RS330C6W	.675-.91	RS330R6W	RS330B6W
	2P3W			7h	480	RS330P7W	RS330C7W	.675-.91	RS330R7W	RS330B7W
	3P4W			12h	125/250	RS430P12W	RS430C12W	.675-.91	RS430R12W	RS430B12W
	3P4W			9h	3Ø250	RS430P9W	RS430C9W	.675-.91	RS430R9W	RS430B9W
	3P4W			7h	3Ø480	RS430P7W	RS430C7W	.675-.91	RS430R7W	RS430B7W
	3P4W			5h	3Ø600	RS430P5W	RS430C5W	.675-.91	RS430R5W	RS430B5W
	4P5W			9h	3ØY120/208	RS530P9W	RS530C9W	.675-.91	RS530R9W	RS530B9W
	4P5W			7h	3ØY277/480	RS530P7W	RS530C7W	.675-.91	RS530R7W	RS530B7W
	4P5W			5h	3ØY347/600	RS530P5W	RS530C5W	.675-.91	RS530R5W	RS530B5W

IP44 Construction: No screw collars on male devices; female devices have flap covers only.

<b>SPLASHPROOF IP44</b>	2P3W			4h	125	RS330P4S	RS330C4S	.675-.91	RS330R4S	RS330B4S
	2P3W			6h	250	RS330P6S	RS330C6S	.675-.91	RS330R6S	RS330B6S
	2P3W			5h	277	RS330P5S	RS330C5S	.675-.91	RS330R5S	RS330B5S
	3P4W			12h	125/250	RS430P12S	RS430C12S	.675-.91	RS430R12S	RS430B12S
	3P4W			9h	3ph.250	RS430P9S	RS430C9S	.675-.91	RS430R9S	RS430B9S
	4P5W			9h	3ph.120/208	RS530P9S	RS530C9S	.675-.91	RS530R9S	RS530B9S

\*See Page 99 for back box/mounting options.

UL Listing E2630, E47956  
UL Classification E205590

### Liquidtight Conduit Adapter Kit

3LTK4C50	30A 3 & 4W ½" NPT
3LTK4C10	30A 3 & 4W 1" NPT
3LTK4C75	30A 3 & 4W ¾" NPT
3LTK5C75	30A 5W ¾" NPT
3LTK5C10	30A 5W 1" NPT

## UniGard™ Watertight and Splashproof Pin and Sleeve Devices IP67 and IP44

# 32 Amp

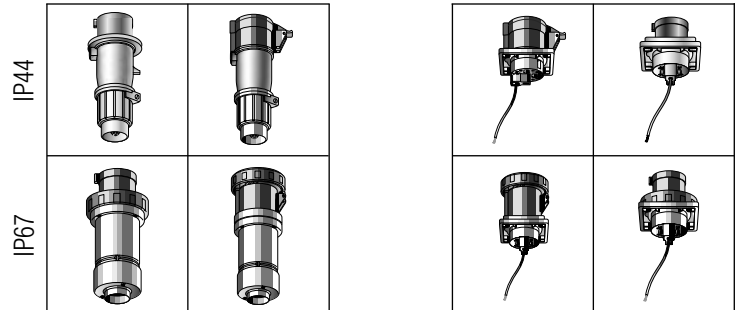

	Poles & Wires	Configuration			Voltage/ Colour Coding	Plug	Connector	Cable O.D. Range Inches	Receptacle*	Inlet*
		Receptacle/ Connector	Plug/ Inlet	Clock Hour						
<b>32 Amp IP44</b>	2P3W			4h	110V	RS332P4S	RS332C4S	.675-.91	RS332R4S	RS332B4S
	2P3W			6h	250V	RS332P6S	RS332C6S	.675-.91	RS332R6S	RS332B6S
	3P4W			6h	380-415V	RS432P6S	RS432C6S	.675-.91	RS432R6S	RS432B6S
	3P4W			3h	380-440V	Special Application – Contact your Regional Sales Office				
	4P5W			6h	220-240/380-415V	RS532P6S	RS532C6S	.675-.91	RS532R6S	RS532B6S

<b>32 Amp IP67</b>	2P3W			4h	110V	RS332P4W	RS332C4W	.675-.91	RS332R4W	RS332B4W
	2P3W			6h	250V	RS332P6W	RS332C6W	.675-.91	RS332R6W	RS332B6W
	3P4W			6h	380-415V	RS432P6W	RS432C6W	.675-.91	RS432R6W	RS432B6W
	3P4W			3h	380-440V	Special Application – Contact your Regional Sales Office				
	4P5W			6h	220-240/380-415V	RS532P6W	RS532C6W	.675-.91	RS532R6W	RS532B6W

\*See Page 99 for back box/mounting options.

■ Red is for Euro.

■ Blue is for devices supplied in North America.

Colour difference does not affect mating.

Contact your Regional Sales Office for inlet/receptacle mounting components.

UL Listing E2630, E47956

UL Classification E205590

### Liquidtight Conduit Adapter Kit

3LTK4C50 32A 3 & 4W ½" NPT

3LTK4C10 32A 3 & 4W 1" NPT

3LTK4C75 32A 3 & 4W ¾" NPT

3LTK5C75 32A 5W ¾" NPT

3LTK5C10 32A 5W 1" NPT

# Russellstoll®

## UniGard™ Watertight Pin and Sleeve Devices IP67

# 60 Amp

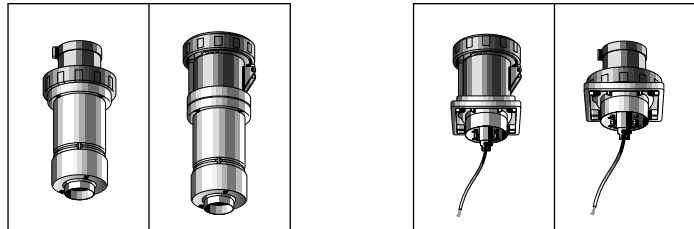

	Poles & Wires	Configuration			Voltage/ Colour Coding	Plug	Connector	Cable O.D. Range Inches	Receptacle*	Inlet*
		Receptacle/ Connector	Plug/ Inlet	Clock Hour						
<b>WATERTIGHT IP67</b>	2P3W			4h	125	RS360P4W	RS360C4W	.937-1.375	RS360R4W	RS360B4W
	2P3W			6h	250	RS360P6W	RS360C6W	.937-1.375	RS360R6W	RS360B6W
	2P3W			5h	277	RS360P5W	RS360C5W	.937-1.375	RS360R5W	RS360B5W
	2P3W			7h	480	RS360P7W	RS360C7W	.937-1.375	RS360R7W	RS360B7W
	2P3W			3h	250DC	RS360P3W	RS360C3W	.937-1.375	RS360R3W	RS360B3W
	3P4W			12h	125/250	RS460P12W	RS460C12W	.937-1.375	RS460R12W	RS460B12W
	3P4W			9h	3Ø250	RS460P9W	RS460C9W	.937-1.375	RS460R9W	RS460B9W
	3P4W			7h	3Ø480	RS460P7W	RS460C7W	.937-1.375	RS460R7W	RS460B7W
	3P4W			5h	3Ø600	RS460P5W	RS460C5W	.937-1.375	RS460R5W	RS460B5W
	4P5W			9h	3ØY120/208	RS560P9W	RS560C9W	.937-1.375	RS560R9W	RS560B9W
	4P5W			7h	3ØY277/480	RS560P7W	RS560C7W	.937-1.375	RS560R7W	RS560B7W
	4P5W			5h	ØY347/600	RS560P5W	RS560C5W	.937-1.375	RS560R5W	RS560B5W

All UniGard 60 & 100 Amp devices ship standard with IEC 309-1 configuration center "pilot" pin/sleeve used for auxiliary contact service. Special construction without these pilots is available.

### Liquidtight Conduit Adapter Kit\*

**6LTK5C10** 60A 5W 1" NPT

\*Additional sizes available on request.

# 63 Amp



<b>63 Amp IP67</b>	2P3W			6h	250V	RS363P6W	RS363C6W	.937-1.375	RS363R6W	RS363B6W
	3P4W			6h	380-415V	RS463P6W	RS463C6W	.937-1.375	RS463R6W	RS463B6W
	4P5W			6h	220-240/ 380-415V	RS563P6W	RS563C6W	.937-1.375	RS563R6W	RS563B6W

\*See Page 99 for back box/mounting options.

■ Red is for Euro.

■ Blue is for devices supplied in North America. Colour difference does not affect mating.

Colour difference does not affect mating.

Contact your Regional Sales Office for inlet/receptacle mounting components.

UL Listing E2630, E47956  
UL Classification E205590

### Liquidtight Conduit Adapter Kit\*

**6LTK5C10** 63A 5W 1" NPT

\*Additional sizes available on request.

# Russellstoll®

## UniGard™ Watertight Pin and Sleeve Devices IP67

# 100 Amp

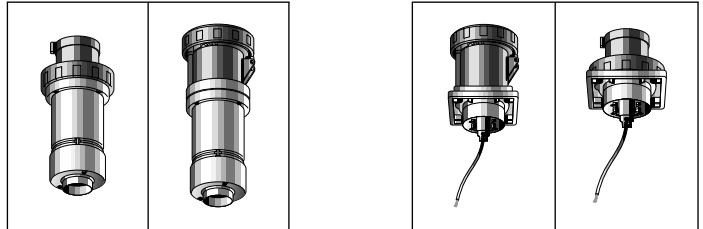

	Poles & Wires	Configuration			Voltage/ Colour Coding	Plug	Connector	Cable O.D. Range Inches	Receptacle*	Inlet*
		Receptacle/ Connector	Plug/ Inlet	Clock Hour						
WATERTIGHT IP67	2P3W**			6h	250	RS3100P6W	RS3100C6W	1.2650-1.790	RS3100R6W	RS3100B6W
	2P3W**			7h	480	RS3100P7W	RS3100C7W	1.2650-1.790	RS3100R7W	RS3100B7W
	3P4W			12h	125/250	RS4100P12W	RS4100C12W	1.2650-1.790	RS4100R12W	RS4100B12W
	3P4W			9h	3Ø250	RS4100P9W	RS4100C9W	1.2650-1.790	RS4100R9W	RS4100B9W
	3P4W			7h	3Ø480	RS4100P7W	RS4100C7W	1.2650-1.790	RS4100R7W	RS4100B7W
	3P4W			5h	3Ø600	RS4100P5W	RS4100C5W	1.2650-1.790	RS4100R5W	RS4100B5W
	4P5W			9h	3ØY120/208	RS5100P9W	RS5100C9W	1.2650-1.790	RS5100R9W	RS5100B9W
	4P5W			7h	3ØY277/480	RS5100P7W	RS5100C7W	1.2650-1.790	RS5100R7W	RS5100B7W
	4P5W			5h	ØY347/600	RS5100P5W	RS5100C5W	1.2650-1.790	RS5100R5W	RS5100B5W

\*\*Alternate vendor supplied item; construction features will vary from specs in this catalogue. Full IEC approval and mating guaranteed.  
All UniGard 60 & 100 Amp devices ship standard with IEC 309-1 configuration center "pilot" pin/sleeve used for auxillary contact service.  
Special construction without these pilots is available.

UL Listing E2630, E47956  
UL Classification E205590

# 125 Amp



125 Amp IP67	2P3W**			6h	250V	RS3125P6W	RS3125C6W	1.265-1.790	RS3125R6W	RS3125B6W
	3P4W			6h	380-415V	RS4125P6W	RS4125C6W	1.265-1.790	RS4125R6W	RS4125B6W
	4P5W			6h	220-240/ 380-415V	RS5125P6W	RS5125C6W	1.265-1.790	RS5125R6W	RS5125B6W

\*\*See Page 99 for back box/mounting options.

\*\*Alternate vendor supplied item; construction features will vary from specs in this catalogue. Full IEC approval and mating guaranteed.

■ Red is for Euro.

■ Blue is for devices supplied in North America.

Colour difference does not affect mating.

Contact your Regional Sales Office for inlet/receptacle mounting components.

UL Listing E2630, E47956  
UL Classification E205590

# Russellstoll®

## UniGard™ IEC 309 Safety Interlock

Integral UL 489 22kAIC  
Circuit Breaker OR  
Switched Interlocked  
Receptacle

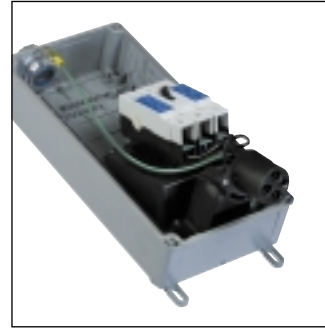

Top or Side  
Conduit Entry

Gasketed UL Type-4X  
Construction

Auxiliary  
Switch  
and/or  
Trip Frame  
Ratings  
Available

Bottom Conduit Entry –  
Optional 30/60A  
Location

5 Mounting  
Points for  
3 or 4 Tab  
Mounting

Adjustable  
Mounting Tabs  
fit any existing  
mounting!

External  
DIN Rail  
Hard-Points



Sturdy Bright Red EZ  
Handle (Vertical - on)  
Lock-off & Lock-on  
Positions

UL94 V0-5VA  
Flame Rated  
Housing &  
External  
Components

Voltage &  
Polarization  
Labeled and  
Colour Coded

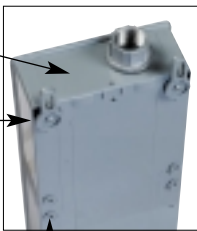

IP67 Colour Coded  
Flap Screw Cap  
IP44 splashproof  
also available

Accepts UniGard™  
Plugs and all  
Approved  
IEC 309 lines

# Russellstoll®

## UniGard™ IEC 309 Safety Interlock



### New IEC 309 Safety Interlock – The UniGard™ Difference

#### The Only True Circuit Breaker Interlocked IEC 309 Receptacle – (Outlet)

- Circuit breaker integrated interlock mechanism.
- UL 489 listed 22kAIC protection.
- Alternate trip ratings available.
- Auxiliary switch option.

OR

#### Switched-only Version



- Rugged UL listed switch.
- Proven performance components.
- Available up to 600 VAC, 4p5w + auxiliary contacts capable.

#### Watertight—IP67

- “W” suffixes (UL Type 4X construction).
- Rugged thermoplastic housings resist impact or abuse and provide excellent corrosion resistance.
- Rugged V0-5VA Flameproof Housings.
- Ideal for outdoor, wet, marine and washdown applications.
- Unique industry-first circuit breaker interlock.
- US: 20, 30, 60, & 100 Amp sizes.
- International: 16, 32, 63, 125 Amp sizes.

#### Splashproof—IP44

- “S” suffixes (NEMA 3R construction).
- Suitable for indoor use where splashing liquids and other contaminants may interfere with electrical connections.
- Ideal for most heavy commercial applications and light industrial applications.
- US 20 & 30 & 60A ratings.
- International 16, 32 and 63A ratings.

#### Protection and Safety in Power Delivery



- Red vertical **ON** indication.
- Lock on **and** Lock off positions.
- Branch circuit load and operation protection, or switched-only version (shown).

#### Mount It Anywhere



- Swivel 3 or 4 point tab variable footprint for flexible mounting.
- Fits in web of 8" I-Beams.

#### Wire It Up, Sideways or Down



- Top, side, and bottom entry.
- Industry standard entry sizes.

Top & Bottom	Top	Side Entry
20/30 Amp	60/100 Amp	All



E211951  
E47955



# Russellstoll®

## UniGard™ IEC 309 Safety Interlock

### New Russellstoll® UniGard™ IEC 309 Circuit Breaker Interlocked Receptacle

16/20A, 30/32A, 60/63A and 100/125A International and U.S. Ratings

IN ALL STANDARD VOLTAGE POLARIZATIONS:

Range	Colour Code	Usage (N. Amer., R.O.W. Euro)	2p3w	3p4w	4p5w
110-130V	Yellow	N. Amer. / Euro.	4h	4h	-
208-250V	Blue	N. Amer. / Euro.	6h	9h	9h
380-415V	Red	Euro.	9h	6h/3h (spec)	6h
500V +	Black	N. Amer. / Euro.	-	5h	5h
277/480V	Red	N. Amer. (black-Euro.)	7h	7h	7h
277V	Grey	N. Amer.	5h	-	-
125/250V	Orange	N. Amer.	-	12h	-
250/440V	Red	Latin America / N. Amer.	-	11h	11h/3h
to 600V, to 400Hz	Green	N. Amer. / Euro.	2h	2h	2h

Contact T&B for other special polarizations.

### Specifications for Any New or Replacement Project

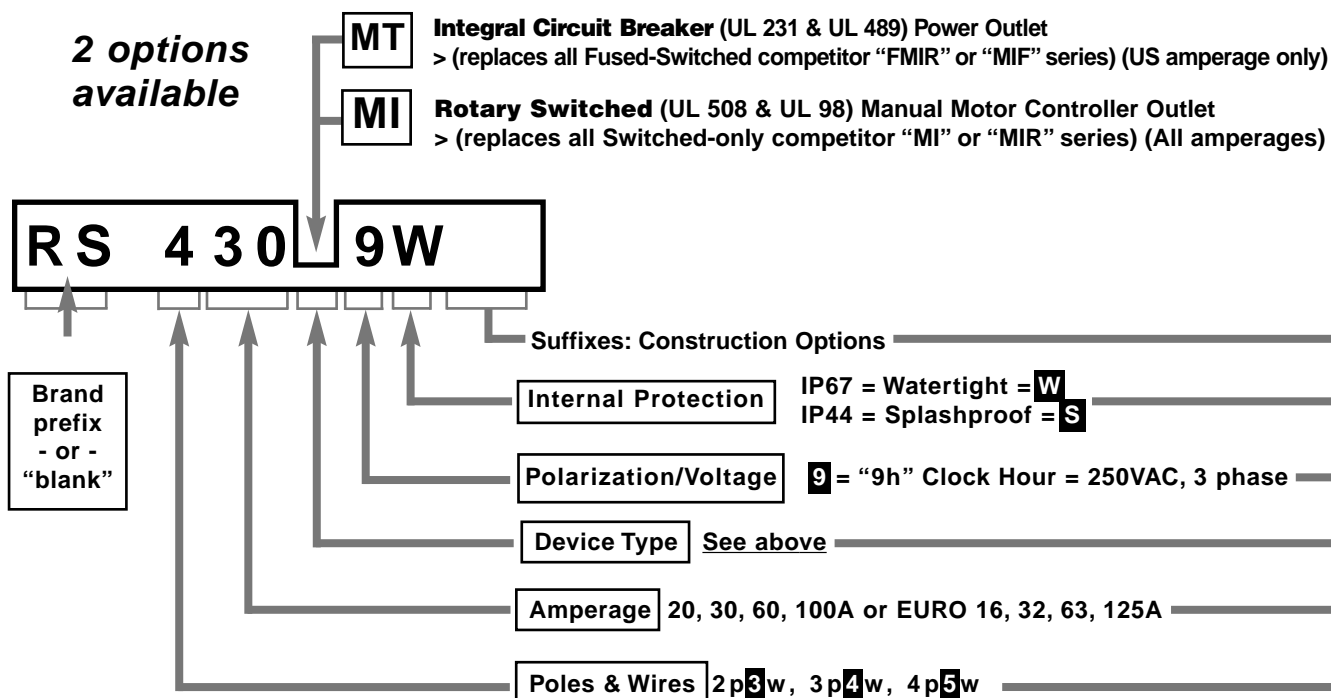

### Characteristics Defined by the CEI70-1—IEC144—UTE C 20-010—DIN40050 Standards

**Table 1**

First Digit—Protection against persons—touching and ingress of solid foreign objects			Second Digit—Protection against the penetration of liquids								
			IP_0	IP_1	IP_2	IP_3	IP_4	IP_5	IP_6	IP_7	IP_8
Non protected											
IP_0		Without protection	<b>IP 00</b>								
IP_1		Protection against touching with the hand and solid objects greater than 50 mm dia.	<b>IP 10</b>	<b>IP 11</b>	<b>IP 12</b>						
IP_2		Protection against touching with the finger and solid objects greater than 12 mm dia.	<b>IP 20</b>	<b>IP 21</b>	<b>IP 22</b>	<b>IP 23</b>					
IP_3		Protection against touching with tools, wires, etc. more than 2.5 mm thick and solid objects greater than 2.5 mm dia.	<b>IP 30</b>	<b>IP 31</b>	<b>IP 32</b>	<b>IP 33</b>	<b>IP 34</b>				
IP_4		Protection against touching with tools, wires, etc. more than 1 mm thick and solid objects greater than 1 mm dia.	<b>IP 40</b>	<b>IP 41</b>	<b>IP 42</b>	<b>IP 43</b>	<b>IP 44</b>				
IP_5		Unlimited protection against contact with live parts and damaging deposits of dust	<b>IP 50</b>				<b>IP 54</b>	<b>IP 55</b>			
IP_6		Unlimited protection against contact with live parts and any penetration of dust	<b>IP 60</b>					<b>IP 65</b>	<b>IP 66</b>	<b>IP 67</b>	<b>IP 68</b>

In some countries a third digit (for mechanical security) is added.

**Table 2**

NEMA designation	Intended Use and Description	Construction Requirements
3	Outdoor use primarily to provide a degree of protection against rain, sleet, windblown dust and damage from external ice formation.	Splashproof (IP44)
4	Indoor and outdoor use primarily to provide a degree of protection against windblown dust and rain, splashing water, hose-directed water and damage from external ice formation.	Watertight (IP67)
4X	Indoor and outdoor use primarily to provide a degree of protection against corrosion, windblown dust and rain, splashing water, hose-directed water and damage from external ice formation.	Watertight (IP67)
6	Indoor and outdoor use primarily to provide a degree of protection against hose-directed water, and the entry of water during occasional temporary submersion at a limited depth and damage from external ice formation.	Watertight (IP67)
12, 12X	Indoor use primarily to provide a degree of protection against circulating dust, falling dirt, and dripping non-corrosive liquids.	Splashproof (IP44)

This information is provided only as a general guide. No specific recommendation is intended. As each application may vary, testing should be conducted by the user in the intended environment.

RUSSELLSTOLL® UNIGARD™

# Russellstoll®

## IEC International Connections

### Installation Information

**Table 1 — Cable and Conductor Strip Length**

		Device Rating			
North American International		20A 16A	30A 32A	60A 63A	100A 125A
Outer Jacket Strip Length	inch	2	2½	3	4
	mm	50	63	76	102
Conductor Strip Length	inch	½	½	¾	1½
	mm	12	12	19	28
Pilot Conductor Strip Length	inch			7/16	5/8
	mm			11	16

**Table 2 — Maximum Torque applied to terminal screws**

		Device Rating			
North American International		20A 16A	30A 32A	60A 63A	100A 125A
Torque Terminal Screw	lb.-in.	7.1	7.1	17.6	35.3
	N-m	0.8	0.8	2	4
Torque Pilot Screw	lb.-in.			7.1	7.1
	N-m			0.8	0.8

**Table 4 — Metric and AWG/MCM conductor size equivalents**

Conductor Size		Amperage (A)
mm²	AWG/MCM	
1,0	18	0-8
1,5	16	8-12
2,5	14	12-15
2,5	12	15-20
4,0	10	20-25
6,0	10	25-32
10	8	32-50
16	6	50-65
25	4	65-85
35	3	85-100
35	2	100-115
50	1	115-130
50	1/0	130-150
70	2/0	150-175
95	3/0	175-200
95	4/0	200-225
120	250	225-250
150	300	250-275
185	350	275-300
185	400	300-350
240	500	350-400

**Table 3 — Cable and Conductor Range**

Amps		Poles and Wires	From AWG	To Type	Cord Grip Range						
					From Type	To Type	With Cable Gland		With Cable Sleeve		
							North American	International	North American	International	
16	20	2P3W	16	S	10	S	inch	0.275-0.530	0.275-0.530	0.275-0.675	0.275-0.675
							mm	7-13.5	7-13.5	7-17	7-17
							inch	0.395-0.825	0.275-0.630	0.315-0.800	0.315-0.800
30	32	3P4W	16	S	10	S	mm	10-21	7-16	8-20	8-20
							inch	0.395-0.825	0.275-0.630	0.315-0.800	0.315-0.800
							mm	10-21	7-16	8-20	8-20
60*	63*	2P3W	12	S	8	S	inch	0.395-0.825	0.395-0.825	0.590-0.950	0.435-0.950
							mm	10-21	10-21	15-24	11-24
							inch	0.650-1.10	0.395-0.825	0.590-0.950	0.435-0.950
100*	125*	3P4W	12	S	8	S	mm	16.5-28	10-21	15-24	11-24
							inch	0.650-1.10	0.395-0.825	0.590-0.950	0.435-0.950
							mm	16.5-28	10-21	15-24	11-24
60*	63*	4P5W	8	S	4	S or W	inch	0.650-1.50	0.650-1.50	0.635-1.30	0.600-1.30
							mm	16.5-38	16.5-38	16-33	15-33
							inch	0.650-1.50	0.650-1.50	0.635-1.30	0.600-1.30
100*	125*	2P3W	6	S or W	2/0	S or W	mm	16.5-38	16.5-38	16-33	15-33
							inch	0.950-1.90	0.950-1.90		
							mm	24-48	24-48		
100*	125*	3P4W	6	S or W	2/0	S or W	inch	0.950-1.90	0.950-1.90		
							mm	24-48	24-48		
							inch	0.950-1.90	0.950-1.90		
100*	125*	4P5W	6	S or W	2/0	S or W	mm	24-48	24-48		
							inch	0.950-1.90	0.950-1.90		
							mm	24-48	24-48		

\* Pilot conductor 16 to 18 AWG

### Performance - Electrical

Dielectric Voltage Withstand	3000 Volts for 1 minute (fixed devices) 2200 Volts for 1 minute (portable devices)
Maximum Working Voltage	600VAC/250VDC (minimum creepage and clearances per UL 840)
Current Interrupting/Load Breaking	Tested to 150% of full rated current for circuit interrupting
Temperature Rise	Maximum 30°C rise at full rated current after 50 cycles overload at 150% rated load at 0.75-pf
Horsepower Ratings	Per NEC 430-151b reference for non-interrupting ratings
Endurance with Load Per IEC 309-1 Clause 21	20 Amp: 5000 cycles; Load only 30 Amp: 1000 cycles - Alternating load 60 Amp: 1000 cycles - Alternating load 100 Amp: 250 cycles - Alternating load

### Performance - Mechanical

Cold (-25°C) Impact Resistance	Per UL 1682 Section 34 and IEC 309-1 Clause 24
Cable O.D. Accommodation	Round portable service cord from 0.57" O.D. through 1.79" O.D.
Terminal Identification	In accordance with UL 1682 standards and IEC 309-1: as L1-L2-L3-N-G
Cable Pull-Out Force	Per UL 1682 Section 33 and IEC 309-1 Clause 23
Product Identification	Molded-in product trademark(s) and UL approved product label

### Performance - Environmental

Moisture Resistance	Per IEC 309-1; Watertight flap/screw cover on IP67 devices or splashproof flap cover on IP44 devices
Flammability	All components V1 or better per UL94, V0 product ratings available
Operating Temperatures	Maximum Continuous 90°C/194°F, Minimum -25°C/-13°F
Chemical Resistance	Resists standard industrial hydrocarbons, acids, bases and solvents
Corrosion Resistance	All metallic components stainless steel or nickel plated brass Sleeve pressure rings of zinc plated steel

### Materials

Housing	Valox®
Contact Carriers	Valox®
Cable Gland Nut	Valox®
Cable Bushing	Solid neoprene, onion ring type
O-Ring, Seals & Gaskets	Solid neoprene
Pins & Sleeves	Nickel plated brass
Sleeve Pressure Ring	Zinc plated steel
Terminal Screws	Nickel plated steel
Flap/Screw Cover Springs	Stainless steel
EZ Cliik™ Spring	Stainless steel
Mounting Flanges	Valox®
Cast Enclosures/Adapters	2 Layer electrostatic epoxy coated, copper-free aluminum enclosures (Euro style nonmetallic Valox® also available)

(Valox® is a registered trademark of GE)

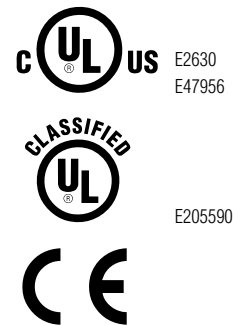

# Russellstoll®

## International Amperages—UniGard™ Series Specifications

### Performance - Electrical

---

Dielectric Voltage Withstand	3000 Volts for 1 minute per IEC 309-1, Clause 19
Maximum Working Voltage	690VAC/250VDC (minimum creepage and clearances per IEC)
Current Interrupting/Load Breaking	Tested to 125% rated current at 110% rated voltage per IEC 309-1 clause 20.
Temperature Rise	Maximum 50°C rise at rated current per IEC 309-1 Clause 22, Table 8
Endurance with Load Per IEC 309-1 Clause 21	16 Amp: 5000 cycles; Load only 32 Amp: 1000 cycles - Alternating load 63 Amp: 1000 cycles - Alternating load 100 Amp: 250 cycles - Alternating load

### Performance - Mechanical

---

Cold (-25°C) Impact Resistance	Per IEC 309-1 Clause 24; (-25°C) with 75cm drop
Cable O.D. Accommodation	Round portable service cords from 14.5mm O.D. through 50mm O.D.
Terminal Identification	In accordance with IEC 309-1 standards; as L1-L2-L3-N-G
Cable Pull-Out Force	In accordance with IEC 309-1, Clause 23
Product Identification	Molded-in product Trademark(s) and CE Mark on packaging

### Performance - Environmental

---

Moisture Resistance	Per IEC 309-1; Watertight flap/screw cover on IP67 devices or flap cover on IP44 devices
Flammability	Per IEC 695-2-1; Housing glow wire tested to 650°C; Contact carrier insert tested to 850°C
Operating Temperatures	Maximum Continuous 90°C/194°F, Minimum -25°C/-13°F with impact
Chemical Resistance	Resists standard industrial hydrocarbons, acids, bases and solvents
Corrosion Resistance	All metallic components stainless steel or nickel plated brass Sleeve pressure rings of zinc plated steel
UV Resistance	External Thermoplastic components are UV stabilized IP67 Series 2 is suitable for outdoor use

### Materials

---

Housing	Valox®
Contact Carriers	Valox®
Cable Gland Nut	Valox®
Cable Bushing	Solid neoprene, onion ring type
O-Ring, Seals & Gaskets	Solid neoprene
Pins & Sleeves	Nickel plated brass
Sleeve Pressure Ring	Zinc plated steel
Terminal Screws	Nickel plated steel
Flap/Screw Cover Springs	Stainless steel
EZ Cliik™ Spring	Stainless steel
Mounting Flanges	Valox®
Cast Enclosures/Adapters	2 Layer Electrostatic epoxy coated, copper-free aluminum enclosures (Euro style nonmetallic Valox® available)



E205590



(Valox® is a registered trademark of GE)

### Specifications: IEC 309 Interlocked Receptacles – North American Standards

#### Performance - Electrical

Dielectric Voltage Withstand	3,000 Volts
Maximum Working Voltage	480 Volts RMS (circuit breaker version)
Voltage	600 Volts RMS (switch version)
Current Interrupting	Certified for current interrupting at full rated current and voltage.
Short-circuit Current Rating	10,000 RMS symmetrical amperes
Operations	Mechanical: 10,000 cycles Electrical: 6,000 cycles
HP Ratings (switch version)	Complies with NEC 430-151 ratings.
Circuit Breaker UL Listed Interrupting Rating	22,000 AIC

#### Performance - Mechanical

Cold (-35°C) Impact Resistance	In accordance with UL 746C
Wiring Accommodations	Suitable for metallic conduit. Conduit entry locations at enclosure top and bottom (60A & 100A top only).
Terminal Identification	In accordance with UL, CSA and IEC 309 conventions.
Product Identification	Identification, ratings and colour-code in accordance with UL, CSA and IEC 309 requirements.
Lockout/Tagout	ON and OFF lockout/tagout capability at switch handle. Complies with OSHA Reg. 29CFR 1910.147
Mounting	External adjustable feet.

#### Performance - Environmental

Moisture Resistance	Screw cap version: UL type 4X, IP67 Flap cap version: IP44
Flammability	UL94-5VA & V0 classifications
Operating Temperatures	Maximum Continuous: 60°C (140°F) Minimum Continuous: -40°C (-40°F)
UV Resistance	UV stabilized material
Chemicals	Resists most standard industrial hydrocarbons, acids, bases and solvents.

#### Materials

Enclosure (all exterior components)	UL94-5VA/V0, UV stabilized, impact modified Valox.
Contact Carrier	Molded arc resistant UL94-V0 thermoplastic.
Gaskets	Neoprene or EPDM
Contacts (sleeves)	Nickel plated brass
Hardware (screws & springs)	Steel with zinc-plated blue chromate or nickel plating.

#### Approvals & Compliances

UL 508 & UL 98 (switch version), UL 231 & UL 489 (circuit breaker version), UL 1682

CSA C22.2 No. 14, 182.1

IEC 309-1, -2



# Russellstoll®

## UniGard™ Series IP44 Dimensions

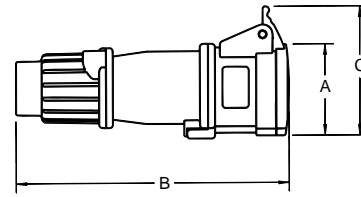
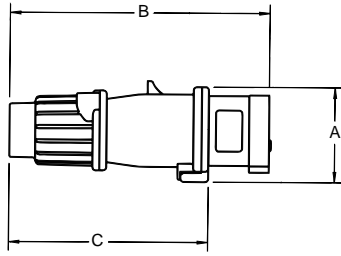

### Plug IP44

Cat. No.	A		B		C		Cord Grip Range	
	inches	mm	inches	mm	inches	mm	inches	mm
16/20A 2P3W	2.26	58	6.20	157	4.76	121	.570-.710	14-18
16/20A 3P4W	2.52	64	6.47	164	5.04	128	.570-.710	14-18
16/20A 4P5W	2.85	73	7.02	178	5.58	142	.570-.710	14-18
30/32A 2P3W	2.85	73	7.37	187	5.58	142	.675-.910	17-23
30/32A 3P4W	2.85	73	7.37	187	5.58	142	.675-.910	17-23
30/32A 4P5W	3.13	80	8.15	207	6.36	162	.675-.910	17-23

### Connector IP44

Cat. No.	A		B		C		Cord Grip Range	
	inches	mm	inches	mm	inches	mm	inches	mm
16/20A 2P3W	2.18	55	6.53	166	3.07	78	.570-.710	14-18
16/20A 3P4W	2.43	62	6.83	173	3.33	85	.570-.710	14-18
16/20A 4P5W	2.81	71	7.41	188	3.79	96	.570-.710	14-18
30/32A 2P3W	2.81	71	7.81	198	3.79	96	.675-.910	17-23
30/32A 3P4W	2.81	71	7.81	198	3.79	96	.675-.910	17-23
30/32A 4P5W	3.09	79	8.62	219	4.17	106	.675-.910	17-23

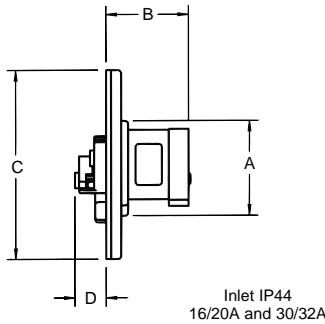

Inlet IP44  
16/20A and 30/32A

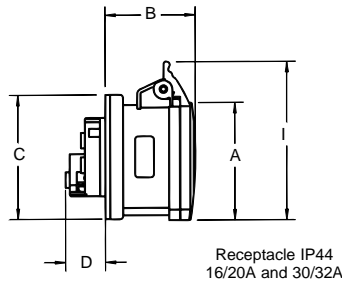

Receptacle IP44  
16/20A and 30/32A

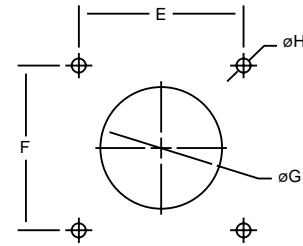

### Inlet IP44

Cat. No.	A		B		C		D		E		F		G		H	
	inches	mm	inches	mm	inches	mm	inches	mm	inches	mm	inches	mm	inches	mm	inches	mm
16/20A 2P3W	2.26	58	1.96	50	4.50	114	.75	19	3.87	98	3.87	98	2.38	60	.282	7.2
16/20A 3P4W	2.52	64	1.96	50	4.50	114	.75	19	3.87	98	3.87	98	2.38	60	.282	7.2
16/20A 4P5W	2.85	73	1.96	50	4.50	114	.75	19	3.87	98	3.87	98	2.38	60	.282	7.2
30/32A 2P3W	2.85	73	2.32	59	4.50	114	1.32	34	3.87	98	3.87	98	2.38	60	.282	7.2
30/32A 3P4W	2.85	73	2.32	59	4.50	114	1.32	34	3.87	98	3.87	98	2.38	60	.282	7.2
30/32A 4P5W	3.13	80	2.32	59	4.50	114	1.32	34	3.87	98	3.87	98	2.38	60	.282	7.2

### Receptacle IP44

Cat. No.	A		B		C		D		E		F		G		H		I	
	inches	mm	inches	mm	inches	mm	inches	mm	inches	mm	inches	mm	inches	mm	inches	mm	inches	mm
16/20A 2P3W	2.18	55	2.11	54	2.97	76	0.94	24	2.36	60	2.36	60	2.38	60	.219	5.5	3.07	78
16/20A 3P4W	2.43	62	2.13	54	2.97	76	0.94	24	2.36	60	2.36	60	2.38	60	.219	5.5	3.33	85
16/20A 4P5W	2.81	71	2.17	55	2.97	76	0.94	24	2.36	60	2.36	60	2.38	60	.219	5.5	3.79	96
30/32A 2P3W	2.81	71	2.56	65	2.97	76	1.52	39	2.36	60	2.36	60	2.38	60	.219	5.5	3.79	96
30/32A 3P4W	2.81	71	2.56	65	2.97	76	1.52	39	2.36	60	2.36	60	2.38	60	.219	5.5	3.79	96
30/32A 4P5W	3.09	79	2.60	66	2.97	76	1.52	39	2.36	60	2.36	60	2.38	60	.219	5.5	4.17	106

# Russellstoll®

## UniGard™ Series IP67 Dimensions

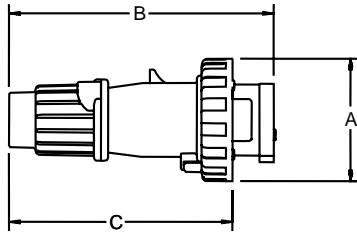

### Plug IP67 16/20A and 30/32A

Cat. No.	A		B		C		Cord Grip Range	
	inches	mm	inches	mm	inches	mm	inches	mm
16/20A 2P3W	2.87	73	6.20	157	5.23	133	.570-.710	14-18
16/20A 3P4W	3.17	81	6.47	164	5.51	140	.570-.710	14-18
16/20A 4P5W	3.48	88	7.02	178	6.06	154	.570-.710	14-18
30/32A 2P3W	3.66	93	7.37	187	6.13	156	.675-.910	17-23
30/32A 3P4W	3.66	93	7.37	187	6.13	156	.675-.910	17-23
30/32A 4P5W	3.96	101	8.15	207	6.91	176	.675-.910	17-23

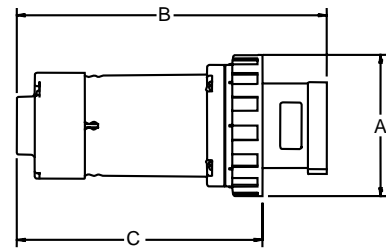

### Plug IP67 60/63A and 100/125A

Cat. No.	A		B		C		Cord Grip Range	
	inches	mm	inches	mm	inches	mm	inches	mm
60/63A 2P3W	4.41	112	9.68	246	7.67	195	.937-1.375	24-35
60/63A 3P4W	4.41	112	9.68	246	7.67	195	.937-1.375	24-35
60/63A 4P5W	4.41	112	9.68	246	7.67	195	.937-1.375	24-35
100/125A 3P4W	5.06	129	12.16	309	9.83	250	1.265-1.790	32-45
100/125A 4P5W	5.06	129	12.16	309	9.83	250	1.265-1.790	32-45

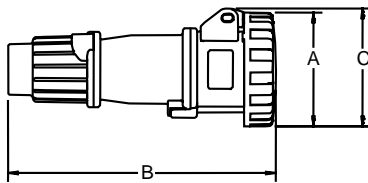

### Connector IP67 16/20A and 30/32A

Cat. No.	A		B		C		Cord Grip Range	
	inches	mm	inches	mm	inches	mm	inches	mm
16/20A 2P3W	2.87	73	6.75	171	2.97	75	.570-.710	14-18
16/20A 3P4W	3.17	81	7.04	179	3.28	83	.570-.710	14-18
16/20A 4P5W	3.48	88	7.62	194	3.75	95	.570-.710	14-18
30/32A 2P3W	3.66	93	8.04	204	4.04	103	.675-.910	17-23
30/32A 3P4W	3.66	93	8.04	204	4.04	103	.675-.910	17-23
30/32A 4P5W	3.96	101	8.83	224	4.03	102	.675-.910	17-23

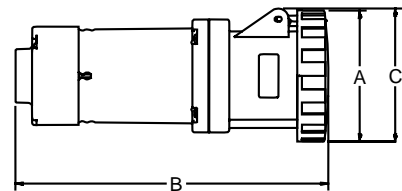

### Connector IP67 60/63A and 100/125A

Cat. No.	A		B		C		Cord Grip Range	
	inches	mm	inches	mm	inches	mm	inches	mm
60/63A 2P3W	4.41	112	10.52	267	4.47	114	.937-1.375	24-35
60/63A 3P4W	4.41	112	10.52	267	4.47	114	.937-1.375	24-35
60/63A 4P5W	4.41	112	10.52	267	4.47	114	.937-1.375	24-35
100/125A 3P4W	5.06	129	12.80	325	5.06	129	1.265-1.790	32-45
100/125A 4P5W	5.06	129	12.80	325	5.06	129	1.265-1.790	32-45

# Russellstoll®

## UniGard™ Series IP67 Dimensions

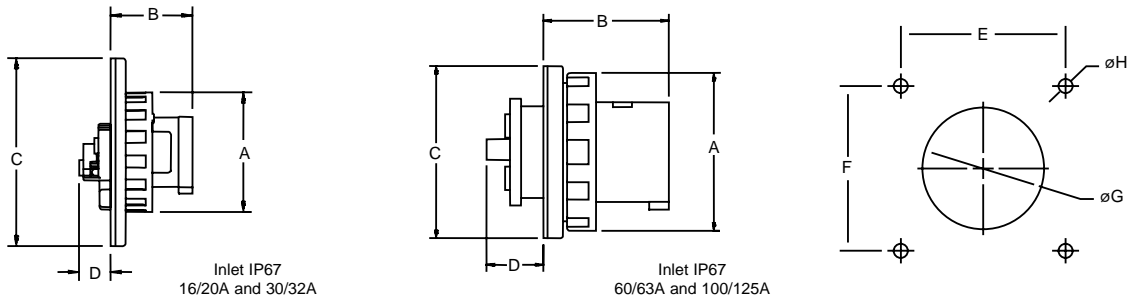

### Inlet IP67 16/20A and 30/32A

Cat. No.	A		B		C		D		E		F		G		H	
	inches	mm	inches	mm	inches	mm	inches	mm	inches	mm	inches	mm	inches	mm	inches	mm
16/20A 2P3W	2.87	73	1.96	50	4.50	114	.75	19	3.87	98	3.87	98	2.38	60	.282	7.2
16/20A 3P4W	3.17	81	1.96	50	4.50	114	.75	19	3.87	98	3.87	98	2.38	60	.282	7.2
16/20A 4P5W	3.48	88	1.96	50	4.50	114	.75	19	3.87	98	3.87	98	2.38	60	.282	7.2
30/32A 2P3W	3.66	93	2.32	59	4.50	114	1.32	34	3.87	98	3.87	98	2.38	60	.282	7.2
30/32A 3P4W	3.66	93	2.32	59	4.50	114	1.32	34	3.87	98	3.87	98	2.38	60	.282	7.2
30/32A 4P5W	3.96	101	2.32	59	4.50	114	1.32	34	3.87	98	3.87	98	2.38	60	.282	7.2

### Inlet IP67 60/63A and 100/125A

Cat. No.	A		B		C		D		E		F		G		H	
	inches	mm	inches	mm	inches	mm	inches	mm	inches	mm	inches	mm	inches	mm	inches	mm
60/63A 2P3W	4.41	112	3.44	87	4.50	114	1.68	43	3.87	98	3.87	98	3.25	83	.282	7.2
60/63A 3P4W	4.41	112	3.44	87	4.50	114	1.68	43	3.87	98	3.87	98	3.25	83	.282	7.2
60/63A 4P5W	4.41	112	3.44	87	4.50	114	1.68	43	3.87	98	3.87	98	3.25	83	.282	7.2
100/125A 3P4W	5.06	129	3.88	99	5.50	140	1.94	49	4.87	124	4.87	124	3.75	95	.282	7.2
100/125A 4P5W	5.06	129	3.88	99	5.50	140	1.94	49	4.87	124	4.87	124	3.75	95	.282	7.2

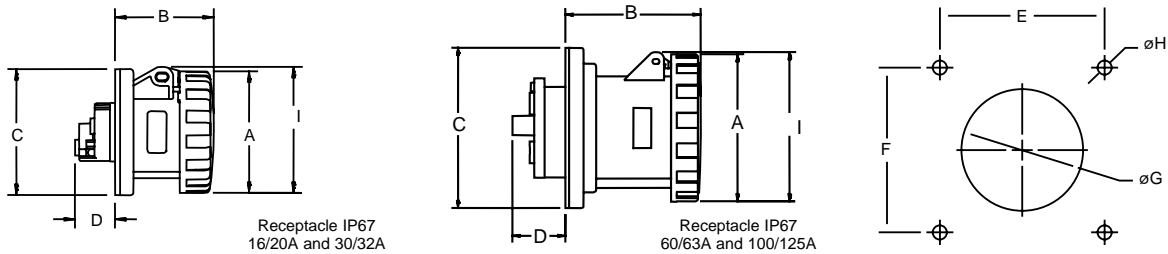

### Receptacle IP67 16/20A and 30/32A

Cat. No.	A		B		C		D		E		F		G		H		I	
	inches	mm	inches	mm	inches	mm	inches	mm	inches	mm	inches	mm	inches	mm	inches	mm	inches	mm
16/20A 2P3W	2.87	73	2.32	59	2.97	76	.94	24	2.36	60	2.36	60	2.50	65	.219	5.5	2.97	75
16/20A 3P4W	3.17	81	2.34	60	2.97	76	.94	24	2.36	60	2.36	60	2.50	65	.219	5.5	3.28	83
16/20A 4P5W	3.48	88	2.37	60	2.97	76	.94	24	2.36	60	2.36	60	2.50	65	.219	5.5	3.75	95
30/32A 2P3W	3.66	93	2.79	71	2.97	76	1.52	39	2.36	60	2.36	60	2.50	65	.219	5.5	4.04	103
30/32A 3P4W	3.66	93	2.79	71	2.97	76	1.52	39	2.36	60	2.36	60	2.50	65	.219	5.5	4.04	103
30/32A 4P5W	3.96	101	2.81	71	2.97	76	1.52	39	2.36	60	2.36	60	2.50	65	.219	5.5	4.03	102

### Receptacle IP67 60/63A and 100/125A

Cat. No.	A		B		C		D		E		F		G		H		I	
	inches	mm	inches	mm	inches	mm	inches	mm	inches	mm	inches	mm	inches	mm	inches	mm	inches	mm
60/63A 2P3W	4.41	112	4.16	106	4.50	114	1.68	43	3.87	98	3.87	98	3.5	89	.282	7.2	4.47	114
60/63A 3P4W	4.41	112	4.16	106	4.50	114	1.68	43	3.87	98	3.87	98	3.5	89	.282	7.2	4.47	114
60/63A 4P5W	4.41	112	4.16	106	4.50	114	1.68	43	3.87	98	3.87	98	3.5	89	.282	7.2	4.47	114
100/125A 3P4W	5.06	129	4.52	115	5.50	140	1.94	49	4.87	124	4.87	124	4.5	114	.282	7.2	5.06	129
100/125A 4P5W	5.06	129	4.52	115	5.50	140	1.94	49	4.87	124	4.87	124	4.5	114	.282	7.2	5.06	129

# Russellstoll®

## UniGard™ IEC 309 Boxes and Adapters

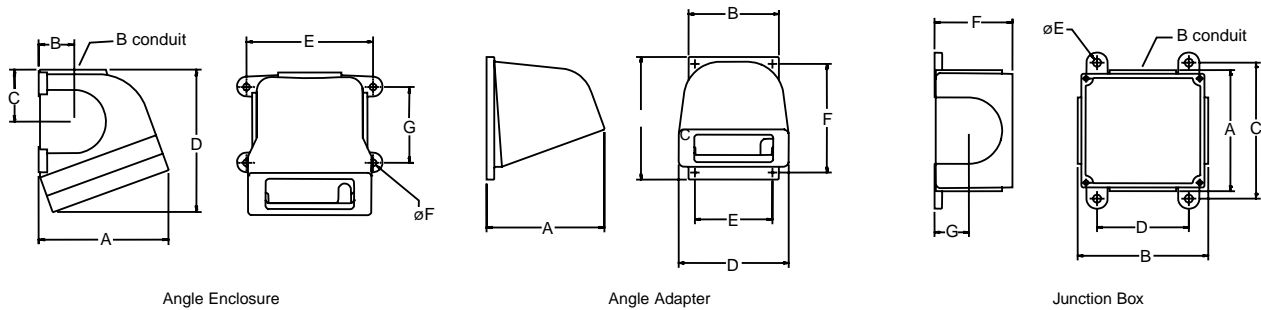

### 20° Angle Enclosures\*

Cat. No.	Conduit Size	Use	A		B		C		D		E		F		G	
			inches	mm	inches	mm	inches	mm	inches	mm	inches	mm	inches	mm	Inches	mm
BE3-B75	¾"	20A & 30A Devices	3.34	85	.97	25	1.12	28	4.12	105	4.00	102	.25	6	2.38	60
BE3-B100	1"	20A & 30A Devices	3.34	85	.97	25	1.12	28	4.12	105	4.00	102	.25	6	2.38	60
AE6-B125	1¼"	60A Devices	5.13	130	1.41	36	2.05	52	5.62	143	5.00	127	.28	7	3.00	76
AE6-B150	1½"	60A Devices	5.13	130	1.41	36	2.05	52	5.62	143	5.00	127	.28	7	3.00	76
AE10-B150	1½"	100A Devices	7.05	179	1.81	46	2.68	68	6.88	175	5.50	140	.34	9	4.00	102
AE10-B200	2"	100A Devices	7.05	179	1.81	46	2.68	68	6.88	175	5.50	140	.34	9	4.00	102

\* For use where there is no existing T&B Russellstoll JB series junction box installed. For 20/30A inlets, use 60A size.

### 20° Angle Adapters\*

Cat. No.	Use	A		B		C		D		E		F	
		inches	mm	inches	mm	inches	mm	inches	mm	inches	mm	inches	mm
AA3	20A & 30A Devices	3.17	81	3.00	76	4.25	108	3.00	76	2.50	64	3.75	95
AA6L	60A Devices	5.23	133	4.00	102	5.43	138	4.88	124	3.44	87	4.81	122
AA10L	100A Devices	7.36	187	5.50	140	5.50	140	6.00	152	4.87	124	4.87	124

\* To be used with JB series junction boxes or surface mount. For 20/30A inlets, use 60A size.

### Rectangular Junction Boxes\*

Cat. No.	Conduit Size	Use	A		B		C		D		E		F		G	
			inches	mm	inches	mm	inches	mm	inches	mm	inches	mm	inches	mm	Inches	mm
JB3-B75	¾"	20A & 30A Devices	2.94	75	4.19	106	3.69	94	2.69	68	.25	6	2.38	60	1.25	32
JB3-B100	1"	20A & 30A Devices	2.94	75	4.19	106	3.69	94	2.69	68	.25	6	2.38	60	1.25	32
JB6-B125	1¼"	60A Devices	4.00	102	5.63	143	4.94	125	3.81	97	.34	9	3.00	76	1.50	38
JB6-B150	1½"	60A Devices	4.00	102	5.63	143	4.94	125	3.81	97	.34	9	3.00	76	1.50	38
JB10-B150	1½"	100A Devices	5.50	140	5.50	140	4.25	108	6.75	171	.34	9	3.75	95	2.00	51
JB10-B200	2"	100A Devices	5.50	140	5.50	140	4.25	108	6.75	171	.34	9	3.75	95	2.00	51

\* Unless otherwise specified, junction boxes are furnished with one conduit size at location B. To be used with AA series angle adapters. For 20/30A inlets, use 60A size.

RUSSELLSTOLL® UNIGARD™

# Russellstoll®

## UniGard™ IEC 309 Safety Interlock

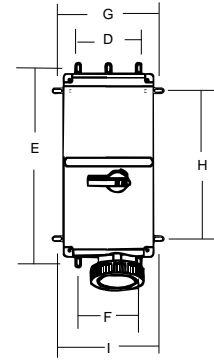
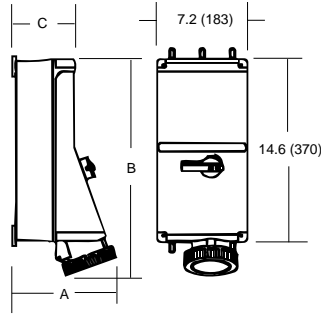
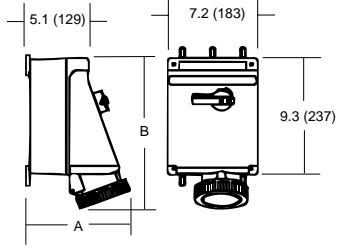

Overall Dimensions (inches-mm)							Overall Dimensions (inches-mm)				
16/20A, 30/32A & 60/63A SWITCH VERSIONS							30A & 60A BREAKER AND 100A/125A SWITCH & BREAKER VERSIONS				
	16/20A		30/32A		60/63A		30A		60A		100/125A
DIM.	IP44	IP67	IP44	IP67	IP44	IP67	IP44	IP67	IP44	IP67	IP67
A	7.5 - 140	8.0 - 203	7.7 - 196	8.2 - 208	8.0 - 203	8.5 - 216	7.7 - 196	8.2 - 208	8.0 - 203	8.5 - 216	9.8 - 249
B	10.8 - 273	10.9 - 277	11.2 - 284	11.4 - 289	11.9 - 302	12.2 - 309	16.4 - 417	16.5 - 418	17.0 - 432	17.4 - 443	17.7 - 450
C	5.1 - 129	5.1 - 129	5.1 - 129	5.1 - 129	5.1 - 129	5.1 - 129	5.1 - 129	5.1 - 129	5.1 - 129	5.1 - 129	5.6 - 149

Mounting Dimension (inches-mm)			
DIM.	16/20A 30/32A 60/63A SWITCH	30A 60A BREAKER	100/125A SWITCH 100A BREAKER
D	5.5 - 140	5.5 - 140	5.5 - 140
E	10.0 - 254	15.2 - 387	15.2 - 387
F	5.5 - 140	5.5 - 140	6.0 - 152
G	8.0 - 203	8.0 - 203	8.0 - 203
H	7.5 - 191	12.8 - 324	12.8 - 324
I	8.0 - 203	8.0 - 203	8.5 - 215

3-pt. and 4-pt. mounting positions available. 100A versions have 4-pt. mounting position only.

Adjustable mounting feet, vertical or horizontal.

Slotted through holes for easier alignment.

# Russellstoll®

## Cross-Reference Ordering Guide

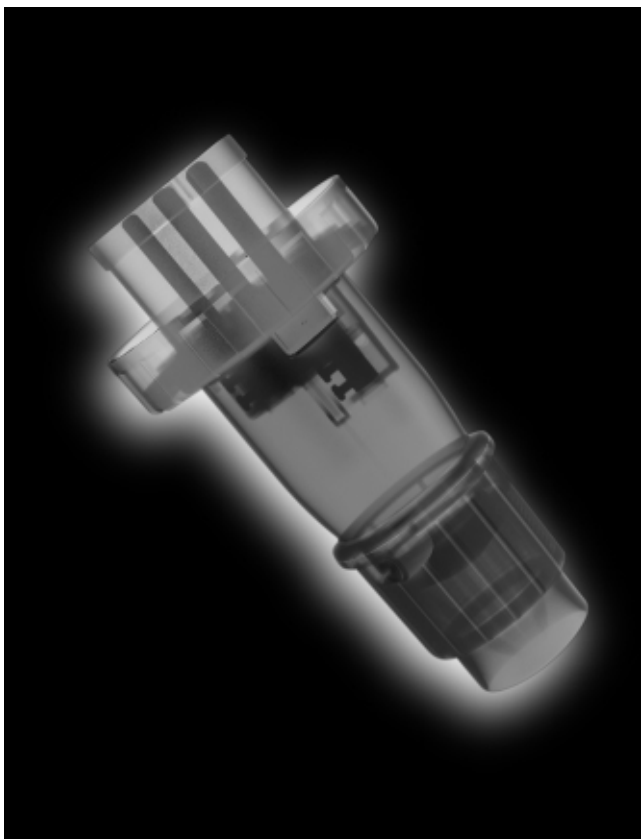

### Russellstoll IEC Benefits

#### Safety

- Fits OTHER competitors, too! IEC 309 standards, UL listed
- Water OK here! (IP67 OR IP44 protection classes)
- You KNOW it's locked and cable TIGHT
- FLAME Rated UL94-V1 (V0 available)
- SOLID sealing protection with gasketed handle and ring cable seal
- Safe Selections: colored specifications for Voltage, Amperage & Poles/Wires...

#### Performance

- ONE-FOURTH the assembly time with EZ-Lok™ clip system
- Easy, fast cable clamping, all-around strong
- Surface mounts easy and smooth, EVERY time
- Easy Maintenance: one side terminal access; cable gland "one piece screw" clamp
- Fits industry common back boxes

#### Durability

- Value Tough - Best cost installation
- QuikGrip™ cable clamp for longer service life
- Stainless hardware - won't rust away
- Use your standard tools
- BEST electrical circuits: Pin & Sleeve self-cleaning contacts

RUSSELLSTOLL® UNIGARD™

### How to Read the Catalogue Numbering System

**RS 430P9W**

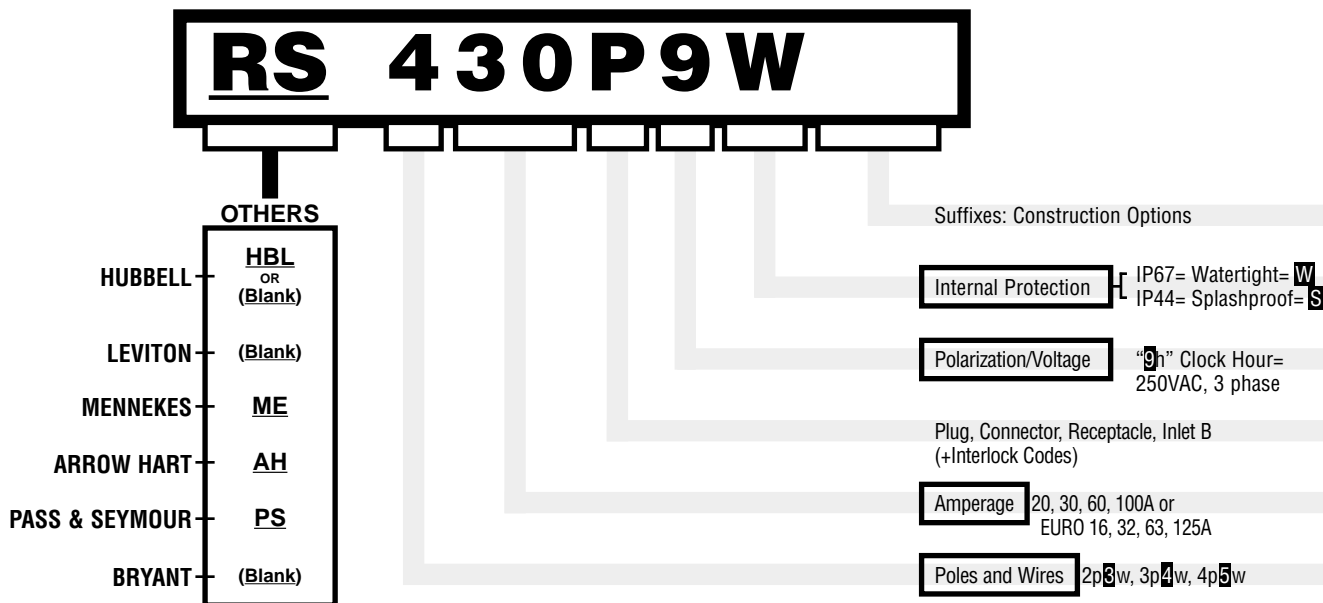

# Russellstoll®

## Product Cross-Reference

### UniGard® Product Comparison

<i>Russellstoll</i>	<i>Arrow-Hart</i>	<i>Hubbell</i>	<i>Leviton</i>	<i>Pass &amp; Seymour</i>	<i>Description of Items</i>					
RS 3 20 B 4 W	AH 3 20 B 4 W	HBL 3 20 B 4 W	3 20 B 4 W	PS 3 20 B 4 W	20A	Inlet	2p3w	4h	120VAC	IP67
RS 3 20 C 4 W	AH 3 20 C 4 W	HBL 3 20 C 4 W	3 20 C 4 W	PS 3 20 C 4 W	20A	Connector	2p3w	4h	120VAV	IP67
RS 3 20 P 4 W	AH 3 20 P 4 W	HBL 3 20 P 4 W	3 20 P 4 W	PS 3 20 P 4 W	20A	Plug	2p3w	4h	120VAC	IP67
RS 3 20 R 4 W	AH 3 20 R 4 W	HBL 3 20 R 4 W	3 20 R 4 W	PS 3 20 R 4 W	20A	Receptacle	2p3w	4h	120VAC	IP67
RS 3 30 C 6 W	AH 3 30 C 6 W	HBL 3 30 C 6 W	3 30 C 6 W	PS 3 30 C 6 W	30A	Connector	2p3w	6h	250VAC	IP67
RS 3 30 P 6 W	AH 3 30 P 6 W	HBL 3 30 P 6 W	3 30 P 6 W	PS 3 30 P 6 W	30A	Plug	2p3w	6h	250VAC	IP67
RS 3 30 R 6 W	AH 3 30 R 6 W	HBL 3 30 R 6 W	3 30 R 6 W	PS 3 30 R 6 W	30A	Receptacle	2p3w	6h	250VAC	IP67
RS 4 60 P 7 W	AH 4 60 P 7 W	HBL 4 60 P 7 W	4 60 P 7 W	PS 4 60 P 7 W	60A	Plug	3p4w	7h	480VAC	IP67
RS 4 60 R 7 W	AH 4 60 R 7 W	HBL 4 60 R 7 W	4 60 R 7 W	PS 4 60 R 7 W	60A	Receptacle	3p4w	7h	480VAC	IP67
RS 4 100 C 7 W	AH 4 100 C 7 W	HBL 4 100 C 7 W	4 100 C 7 W	PS 4 100 C 7 W	100A	Connector	3p4w	7h	480VAC	IP67
RS 4 100 P 7 W	AH 4 100 P 7 W	HBL 4 100 P 7 W	4 100 P 7 W	PS 4 100 P 7 W	100A	Plug	3p4w	7h	480VAC	IP67
RS 4 100 R 7 W	AH 4 100 R 7 W	HBL 4 100 R 7 W	4 100 R 7 W	PS 4 100 R 7 W	100A	Receptacle	3p4w	7h	480VAC	IP67
RS 4 20 B 9 W	AH 4 20 B 9 W	HBL 4 30 B 9 W	4 30 B 9 W	PS 4 30 B 9 W	30A	Inlet	3p4w	9h	250V 3ph	IP67
RS 4 20 C 9 W	AH 4 20 C 9 W	HBL 4 30 C 9 W	4 30 C 9 W	PS 4 30 C 9 W	30A	Connector	3p4w	9h	250V 3ph	IP67
RS 4 30 P 9 W	AH 4 30 P 9 W	HBL 4 30 P 9 W	4 30 P 9 W	PS 4 30 P 9 W	30A	Plug	3p4w	9h	250V 3ph	IP67
RS 4 30 R 9 W	AH 4 30 R 9 W	HBL 4 30 R 9 W	4 30 R 9 W	PS 4 30 R 9 W	30A	Receptacle	3p4w	9h	250V 3ph	IP67
RS 4 60 C 9 W	AH 4 60 C 9 W	HBL 4 60 C 9 W	4 60 C 9 W	PS 4 60 C 9 W	60A	Connector	3p4w	9h	250V 3ph	IP67
RS 4 60 P 9 W	AH 4 60 P 9 W	HBL 4 60 P 9 W	4 60 P 9 W	PS 4 60 P 9 W	60A	Plug	3p4w	9h	250V 3ph	IP67
RS 4 60 R 9 W	AH 4 60 R 9 W	HBL 4 60 R 9 W	4 60 R 9 W	PS 4 60 R 9 W	60A	Receptacle	3p4w	9h	250V 3ph	IP67
RS 4 100 B 9 W	AH 4 100 B 9 W	HBL 4 100 B 9 W	4 100 B 9 W	PS 4 100 B 9 W	100A	Inlet	3p4w	9h	250V 3ph	IP67
RS 4 100 C 9 W	AH 4 100 C 9 W	HBL 4 100 C 9 W	4 100 C 9 W	PS 4 100 C 9 W	100A	Connector	3p4w	9h	250V 3ph	IP67
RS 4 100 P 9 W	AH 4 100 P 9 W	HBL 4 100 P 9 W	4 100 P 9 W	PS 4 100 P 9 W	100A	Plug	3p4w	9h	250V 3ph	IP67
RS 4 100 R 9 W	AH 4 100 R 9 W	HBL 4 100 R 9 W	4 100 R 9 W	PS 4 100 R 9 W	100A	Receptacle	3p4w	9h	250V 3ph	IP67
RS 4 20 B 12 W	AH 4 20 B 12 W	HBL 4 20 B 12 W	4 20 B 12 W	PS 4 20 B 12 W	20A	Inlet	3p4w	12h	125/250V	IP67
RS 4 20 C 12 W	AH 4 20 C 12 W	HBL 4 20 C 12 W	4 20 C 12 W	PS 4 20 C 12 W	20A	Connector	3p4w	12h	125/250V	IP67
RS 4 20 P 12 W	AH 4 20 P 12 W	HBL 4 20 P 12 W	4 20 P 12 W	PS 4 20 P 12 W	20A	Plug	3p4w	12h	125/250V	IP67
RS 4 20 R 12 W	AH 4 20 R 12 W	HBL 4 20 R 12 W	4 20 R 12 W	PS 4 20 R 12 W	20A	Receptacle	3p4w	12h	125/250V	IP67
RS 4 60 C 12 W	AH 4 60 C 12 W	HBL 4 60 C 12 W	4 60 C 12 W	PS 4 60 C 12 W	60A	Connector	3p4w	12h	125/250V	IP67
RS 4 60 P 12 W	AH 4 60 P 12 W	HBL 4 60 P 12 W	4 60 P 12 W	PS 4 60 P 12 W	60A	Plug	3p4w	12h	125/250V	IP67
RS 4 60 R 12 W	AH 4 60 R 12 W	HBL 4 60 R 12 W	4 60 R 12 W	PS 4 60 R 12 W	60A	Receptacle	3p4w	12h	125/250V	IP67
RS 4 100 C 12 W	AH 4 100 C 12 W	HBL 4 100 C 12 W	4 100 C 12 W	PS 4 100 C 12 W	100A	Connector	3p4w	12h	125/250V	IP67
RS 4 100 P 12 W	AH 4 100 P 12 W	HBL 4 100 P 12 W	4 100 P 12 W	PS 4 100 P 12 W	100A	Plug	3p4w	12h	125/250V	IP67
RS 4 100 R 12 W	AH 4 100 R 12 W	HBL 4 100 R 12 W	4 100 R 12 W	PS 4 100 R 12 W	100A	Receptacle	3p4w	12h	125/250V	IP67
RS 5 60 C 7 W	AH 5 60 C 7 W	HBL 5 60 C 7 W	5 60 C 7 W	PS 5 60 C 7 W	60A	Connector	4p5w	7h	277/480 3ph.	IP67
RS 5 60 P 7 W	AH 5 60 P 7 W	HBL 5 60 P 7 W	5 60 P 7 W	PS 5 60 P 7 W	60A	Plug	4p5w	7h	277/480 3ph.	IP67
RS 5 60 R 7 W	AH 5 60 R 7 W	HBL 5 60 R 7 W	5 60 R 7 W	PS 5 60 R 7 W	60A	Receptacle	4p5w	7h	277/480 3ph.	IP67
RS 5 30 C 9 W	AH 5 30 C 9 W	HBL 5 30 C 9 W	5 30 C 9 W	PS 5 30 C 9 W	30A	Connector	4p5w	9h	250V 3ph +N	IP67
RS 5 30 P 9 W	AH 5 30 P 9 W	HBL 5 30 P 9 W	5 30 P 9 W	PS 5 30 P 9 W	30A	Plug	4p5w	9h	250V 3ph +N	IP67
RS 5 30 R 9 W	AH 5 30 R 9 W	HBL 5 30 R 9 W	5 30 R 9 W	PS 5 30 R 9 W	30A	Receptacle	4p5w	9h	250V 3ph +N	IP67
RS 5 60 B 9 W	AH 5 60 B 9 W	HBL 5 60 B 9 W	5 60 B 9 W	PS 5 60 B 9 W	60A	Inlet	4p5w	9h	250V 3ph +N	IP67
RS 5 60 C 9 W	AH 5 60 C 9 W	HBL 5 60 C 9 W	5 60 C 9 W	PS 5 60 C 9 W	60A	Connector	4p5w	9h	250V 3ph +N	IP67
RS 5 60 P 9 W	AH 5 60 P 9 W	HBL 5 60 P 9 W	5 60 P 9 W	PS 5 60 P 9 W	60A	Plug	4p5w	9h	250V 3ph +N	IP67
RS 5 60 R 9 W	AH 5 60 R 9 W	HBL 5 60 R 9 W	5 60 R 9 W	PS 5 60 R 9 W	60A	Receptacle	4p5w	9h	250V 3ph +N	IP67
RS 5 100 C 9 W	AH 5 100 C 9 W	HBL 5 100 C 9 W	5 100 C 9 W	PS 5 100 C 9 W	100A	Connector	4p5w	9h	250V 3ph +N	IP67
RS 5 100 P 9 W	AH 5 100 P 9 W	HBL 5 100 P 9 W	5 100 P 9 W	PS 5 100 P 9 W	100A	Plug	4p5w	9h	250V 3ph +N	IP67
RS 5 100 R 9 W	AH 5 100 R 9 W	HBL 5 100 R 9 W	5 100 R 9 W	PS 5 100 R 9 W	100A	Receptacle	4p5w	9h	250V 3ph +N	IP67

\* HBL prefix is only used for ordering; parts do not display prefix.  
 European Ratings (16,32,63,125A) employ 5 digit numeric-only Cat. No., eg. 12345