

4" SQUARE BOXES

2-1/8" DEEP WITH CLAMPS (NONMETALLIC AND ARMORED CABLE)

Applications

- Boxes are installed in walls or ceilings for lighting fixtures, switches or receptacles
- Square boxes are used where multiple conductor runs are split into two or more directions to bring power to a number of electrical devices

Product Features

- Reference Box Selection section in the front of this catalog for complete description of bracket and clamp types and features
- BOX-LOC® (MS) Bracket Box is a snap to install. Place the bracket on the open side of the stud first. Slots in the bracket engage the lip of the stud and actually crimp it as you press the bracket on the stud. Barbed hooks dig into the flat side of the stud, quickly locking it in place
- Combination screw heads provide for faster installation
- TKO® knockouts offer greater flexibility with RACO® patented combination 1/2" and 3/4" knockout

4" SQUARE BOXES

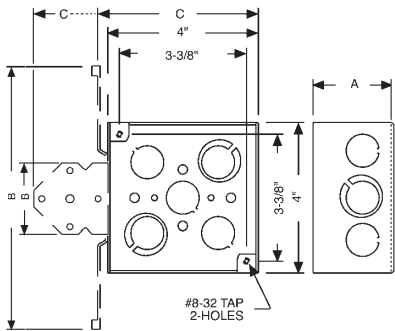

Compliances

- - File E195978



All RACO® single gang, two gang, 4" square, and single gang gangable U.L. listed steel boxes are acceptable for use in 2-hour fire rated walls. For additional information, consult U.L. "Fire Resistance Directory" or the U.L. website at www.ul.com

600V Per U.L. 514-A, suitable for use without a bonding jumper in circuits up to 600 volts

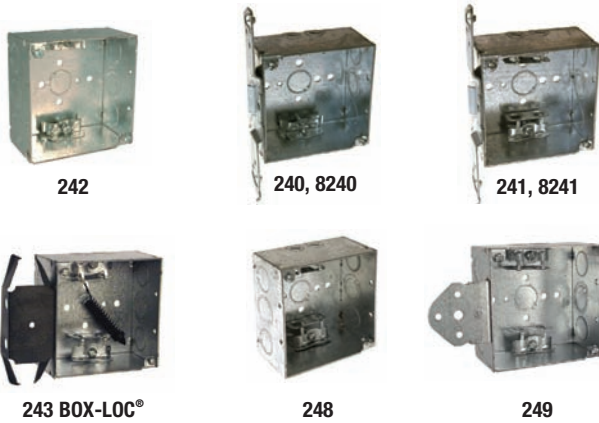

RACO STEEL BOXES & COVERS

ORDERING INFORMATION - DIMENSIONS

4" SQUARE – 2-1/8" DEEP WITH NONMETALLIC SHEATHED CABLE CLAMPS – 30.3 CUBIC INCHES

CATALOG NUMBER	DESCRIPTION BRACKET & SETBACK	KNOCKOUTS			STD. PKG.	UPC BAR CODE
		SIDES		BOTTOM COND.		
		CABLE	COND.			
600V 240	TS, flush	4	2-1/2", 1 – TKO®	1-1/2"	25	—
600V 8240	TS, flush	4	2-1/2", 1 – TKO®	1-1/2"	25	
600V 242	—	4	4-1/2", 2 – TKO®	1-1/2"	25	—

4" SQUARE – 2-1/8" DEEP WITH ARMORED CABLE/METAL CLAD/FLEX CLAMPS – 30.3 CUBIC INCHES

CATALOG NUMBER	DESCRIPTION BRACKET & SETBACK	KNOCKOUTS			STD. PKG.	UPC BAR CODE
		SIDES		BOTTOM COND.		
		CABLE	COND.			
600V 241	TS, flush	4	2-1/2", 2 – TKO®	1-1/2"	25	—
600V 8241	TS, flush	4	2-1/2", 1 – TKO®	1-1/2"	25	
600V 243*	BOX-LOC® (MS) flush	4	2-1/2", 1 – TKO®	1-1/2"	25	
600V 248	—	4	4-1/2", 2 – TKO®	1-1/2"	25	
600V 249	B, flush	4	2-1/2", 1 – TKO®	1-1/2"	25	—

*Provided w/far-side support (part #978)

DIMENSIONS

CATALOG NUMBER	A (INSIDE)	B	C
240, 8240	2-1/8"	7"	4-5/16"
241, 8241	2-1/8"	7"	4-5/16"
242	2-1/8"	—	—
243	2-1/8"	4-5/8"	5-1/2"
248	2-1/8"	—	—
249	2-1/8"	1-31/32"	6"



A28

3-3/4" SQUARE BOXES AND 4" SQUARE RETRO RING®

3-1/2" DEEP/CONDUIT

RACO STEEL BOXES & COVERS

Applications

- Square boxes are used where multiple conductor runs are split into two or more directions to bring power to a number of electrical devices

Product Features

- 3-3/4" opening in wall allows for margin of error when using a 4" square cover
- Will accept all 4" square covers and mudrings
- Red boxes, covers and extensions for dedicated life safety alarm circuits

3-3/4" SQUARE BOXES

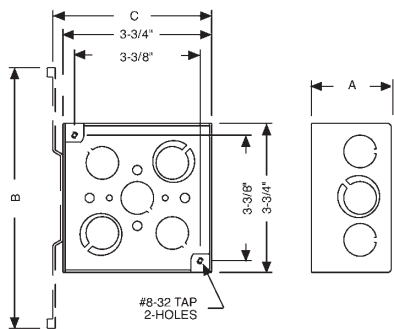

Compliance

- – File E195978

Applications

- RETRO-RING® 205RAC and 206RAC are used to position a 4" sq. steel junction box in a sheet rock covered wall cavity
- Use 205RAC in old work, life safety appliance installations
- 206RAC is used in old work installations where one or two devices are required

Product Features

- Works in 3/8" to 1-1/2" thick wall or ceiling applications
- Small footprint is covered by most popular life safety devices
- Steel old work wings allow for secure mounting of box and device to wall
- Includes one wall template per carton

Compliance

- Listed



255



911-1



256



911-2

ORDERING INFORMATION - DIMENSIONS

3-3/4" SQUARE, LARGE CAPACITY BOXES – 3-1/2" DEEP – WELDED WITH CONDUIT KO'S

CATALOG NUMBER	DESCRIPTION BRACKET & SETBACK	KNOCKOUTS		CU. IN.	STD. PKG.	UPC BAR CODE
		SIDES	BOTTOM			
255*	FM, flush	10, 1/2" - 3/4" conc.	4, 1/2" - 3/4" conc.	40.5	10	
911-1*	FM, flush, Painted Red	10, 1/2" - 3/4" conc.	4, 1/2" - 3/4" conc.	40.5	10	—
256*	No bracket	12, 1/2" - 3/4" conc.	4, 1/2" - 3/4" conc.	40.5	25	
911-2*	No bracket, Painted Red	12, 1/2" - 3/4" conc.	4, 1/2" - 3/4" conc.	40.5	25	—

*Will accept a 4" square cover

DIMENSIONS

CATALOG NUMBER	A	B	C
255	3-1/2"	7- 5/8"	4-1/8"
911-1	3-1/2"	7- 5/8"	4-1/8"
256	3-1/2"	—	—
911-2	3-1/2"	—	—



4714, THE INSIDER® will secure nonmetallic sheathed cable in 1/2" KO (See pg. B87)



205RAC



206RAC, 8206RAC

4" SQUARE RETRO-RINGS®

CATALOG NUMBER	DESCRIPTION	STD. PKG.	UPC BAR CODE
205RAC	Old work ring for alarm installation	20	—
206RAC	Old work ring for device installation	20	—
8206RAC	Old work ring for device installation	10	



4" SQUARE COVERS

Applications

- Covers are used to close an outlet box
- Raised device covers are used for mounting switches or receptacles

Product Features

- Angled mounting slots compensate up to 12° for box misalignment
- Swivel covers restricted to 20° swing from vertical
- KWIK-HANG® allows easy installation of high bay lighting fixtures. Fixture rests in position while wiring is completed
- Red boxes, covers and extensions for dedicated life safety alarm circuits

Compliances

- UL – File E195978
- CSA – File LR-1082

*5 Bundles of 10

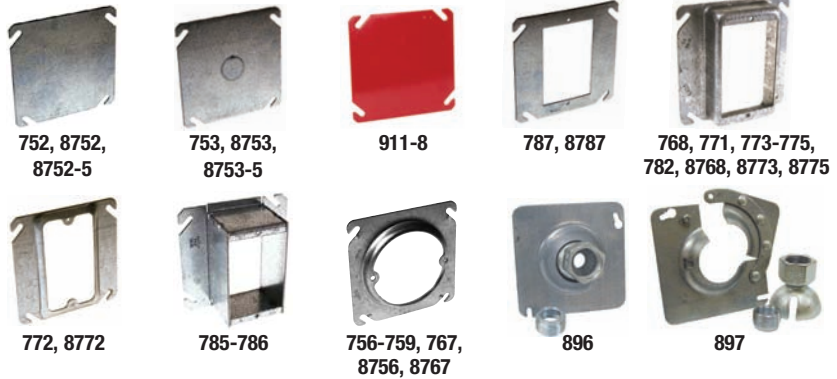
RACO STEEL BOXES
& COVERS

ORDERING INFORMATION - DIMENSIONS

4" SQUARE COVERS						
CATALOG NUMBER	DESCRIPTION	CU. IN. CAP.	STD. PKG.	UPC BAR CODE	RECOMMENDED MAX. SUPPORT LOADS	
					CEILING FAN (DYNAMIC) LBS.	FIXTURE (STATIC) LBS.
752	Flat, blank	—	50	—	No	No
8752	Flat, blank	—	50		No	No
8752-5	Flat, blank	—	50*		No	No
753	Flat, 1/2" KO in center	—	50	—	No	No
8753	Flat, 1/2" KO in center	—	50		No	No
8753-5	Flat, 1/2" KO in center	—	50*		No	No
911-8	Flat, blank, Painted Red	—	50	—	No	No

4" SQUARE DEVICE AND TILE COVERS - SINGLE DEVICE						
CATALOG NUMBER	DESCRIPTION	CU. IN. CAP.	STD. PKG.	UPC BAR CODE	RECOMMENDED MAX. SUPPORT LOADS	
					CEILING FAN (DYNAMIC) LBS.	FIXTURE (STATIC) LBS.
767	Raised 1/2" open, ears 2-3/4" O.C.	3.0	25	—	No	50
8767	Raised 1/2" open, ears 2-3/4" O.C.	3.0	25		No	50
756	Raised 5/8" open, ears 2-3/4" O.C.	4.0	100	—	No	50
8756	Raised 5/8" open, ears 2-3/4" O.C.	4.0	25		No	50
759	Raised 3/4" open, ears 2-3/4" O.C.	5.0	25		No	50
757	Raised 1" open, ears 2-3/4" O.C.	6.8	25		No	50
758	Raised 1-1/4" open, ears 2-3/4" O.C.	8.5	25	—	No	50
787	Flat	—	50	—	—	—
8787	Flat	—	50		—	—
771	Raised 1/4"	1.5	100	—	—	—
8771	Raised 1/4"	1.5	25		—	—
772	Raised 1/2" drawn	3.5	100	—	—	—
8772	Raised 1/2" drawn	3.5	50		—	—
782	Raised 1/2" tile	3.5	25		—	—
768	Raised 5/8"	4.5	50	—	—	—
8768	Raised 5/8"	4.5	25		—	—
773	Raised 3/4"	5.5	50	—	—	—
8773	Raised 3/4"	5.5	50		—	—
774	Raised 1"	7.5	25		—	—
775	Raised 1-1/4"	9.5	25	—	—	—
8775	Raised 1-1/4"	9.5	25		—	—
785	Raised 1-1/2"	11.3	25	—	—	—
786	Raised 2"	14.5	25		—	—

SWIVEL FIXTURE COVERS						
CATALOG NUMBER	DESCRIPTION	CU. IN. CAP.	STD. PKG.	UPC BAR CODE	RECOMMENDED MAX. SUPPORT LOADS	
					CEILING FAN (DYNAMIC) LBS.	FIXTURE (STATIC) LBS.
896	For 4" sq. boxes, 1/2" or 3/4" pipe	—	25	—	No	50
897	KWIK-HANG® For 4" sq. boxes 1/2" or 3/4" pipe	—	25	—	No	50



A30**4" SQUARE COVERS AND PARTITIONS**RACO STEEL BOXES
& COVERS**Applications**

- Covers are used to close an outlet box
- Raised device covers are used for mounting switches or receptacles

Product Feature

- Angled mounting slots compensate up to 12° for box misalignment

Low Voltage Partitions Applications

- Low voltage partitions may be added to conduit-type boxes to divide power from voice/data
- Must be used with raised covers

Product Features

- Partition divides 4" square boxes into two compartments
- Use with two-device covers which have a slot for the partition
- Partition is scored, so it can be broken at the proper depth of box and cover combination
- Helpful hint: Assemble the box with the partition in place before breaking off at the scored tab. This will prevent you from breaking off more tab than needed

Compliances

- UL – File E195978
- SR – File LR-1082
- Low voltage partitions are not UL listed

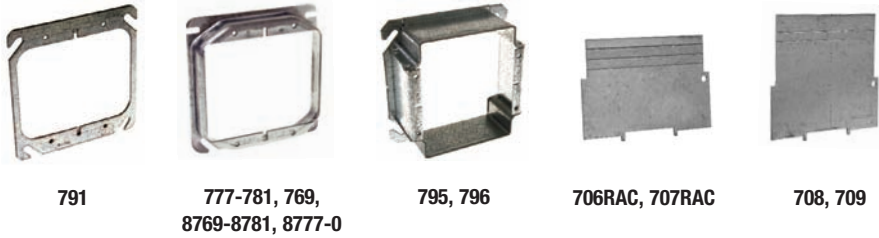
**ORDERING INFORMATION - DIMENSIONS**

4" SQUARE COMBINATION DEVICE AND TILE COVERS TWO DEVICE				
CATALOG NUMBER	DESCRIPTION	CU. IN.	STD. PKG.	UPC BAR CODE
791	Flat	—	50	
777	Raised 1/4", drawn	3.0	50	—
8777-0	Raised 1/4", drawn	3.0	10	
778	Raised 1/2", drawn	5.5	50	—
8778	Raised 1/2", drawn	5.5	25	
769	Raised 5/8", drawn	7.3	50	—
8769	Raised 5/8", drawn	7.3	25	
779	Raised 3/4", drawn	8.8	50	—
8779	Raised 3/4", drawn	8.8	50	
780	Raised 1", drawn	12.0	25	
781	Raised 1-1/4", drawn	15.0	25	—
8781	Raised 1-1/4", drawn	15.0	25	
795	Raised 1-1/2", welded	15.5	25	—
796	Raised 2", welded	20.5	25	—

LOW VOLTAGE PARTITIONS – FOR 1-1/2" & 2-1/8" DEEP			
CATALOG NUMBER	DESCRIPTION	STD. PKG.	UPC BAR CODE
For 1-1/2" Deep Box and 2-Device Raised Cover*:			
706RAC	1/4", 1/2", 3/4" or 1" (777, 778, 8778, 779, 8779, 780)	25	—
708	1-1/4", 1-1/2", or 2" (781, 8781, 795, 796)	25	—
For 2-1/8" Deep Box and 2-Device Raised Cover*:			
707RAC	1/4", 1/2", 3/4" or 1" (777, 778, 8778, 779, 8779, 780)	25	—
709	1-1/4", 1-1/2", or 2" (781, 8781, 795, 796)	25	—

* Boxes, covers, and partitions must be ordered separately

* For 1-1/2" deep box with 5/8" cover, partition not available

* For 2-1/8" deep box with 5/8" cover, use #708 partition

* Partitions are usable but not UL listed for 4-11/16" sq. box

4" SQUARE EXPOSED WORK COVERS

Application

- Surface covers are used to support switches or receptacles in areas where the box is surface mounted or positioned in exposed work applications.

Product Features

- RACO® exposed work covers include required hardware for mounting the receptacle(s)
- RACO® exposed work covers meet the requirements of the 2008 NEC Article 250.146 (A). No bonding jumper is required for covers with (1) crushed corners (2) two or more device attachment screws and (3) a lockwasher or equivalent
- Hardware and cover are packed in a poly-bag with printed catalog number, compliances and installation instructions

HELPFUL HINT: Remove a portion of the GFCI receptacle ear to mount device to 4" square cover

NOTE: 808, 809, 814, 915 covers are not crushed corners and require longer screws to attach to box. Longer screws are provided with covers

Compliances

-  – File E195978
 -  – File LR-1082

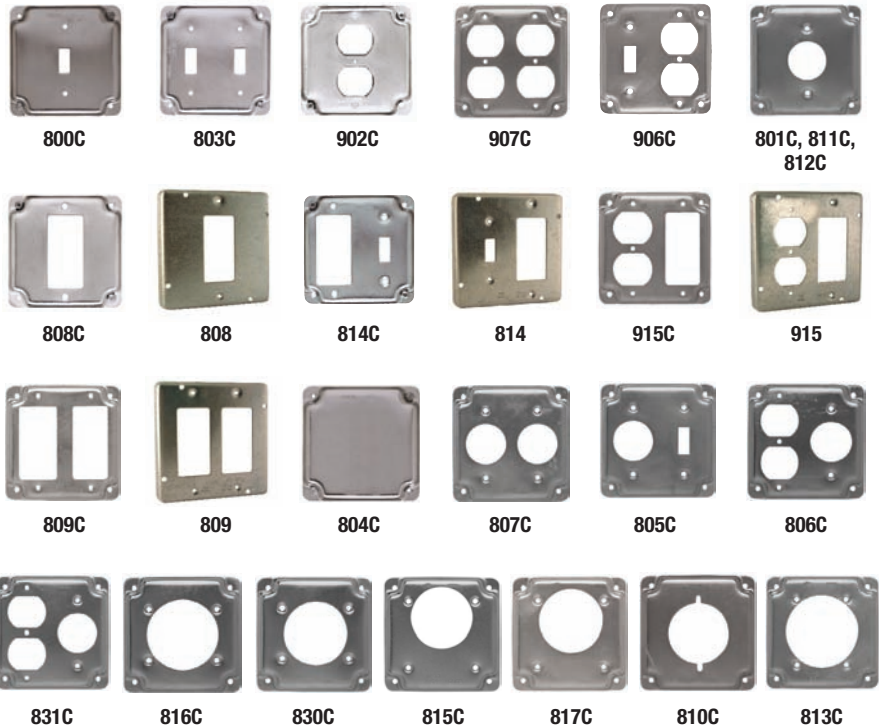
RACO STEEL BOXES
& COVERS**ORDERING INFORMATION - DIMENSIONS**

4" SQUARE SURFACE COVERS – RAISED 1/2"						
CATALOG NUMBER	DESCRIPTION	CU. IN.	STD. PKG.	CRUSHED CORNERS	UPC BAR CODE	
800C	1 Toggle switch	6.5	10	Yes		
801C	1 Receptacle 1.406" dia.	6.5	10	Yes		
803C	2 Toggle switches	6.5	10	Yes		
804C	Blank, no holes	6.5	10	Yes		
805C	1 Toggle switch & 1 1.406" dia.	6.5	10	Yes		
806C	1 Duplex & 1 1.406" dia.	6.5	10	Yes		
807C	2 Receptacles, 1.406" dia. holes	6.5	10	Yes		
808C	1 GFCI	6.5	10	Yes		
808	1 GFCI	7.3	10	No		
809C	2 GFCI	6.5	10	Yes		
809	2 GFCI	7.3	10	No		
810C	30-50A Receptacle 2.141" dia.	6.5	10	Yes		
811C	30A locking 1.719" dia.	6.5	10	Yes		
812C	20A Receptacle 1.594" dia.	6.5	10	Yes		
813C	30-60A Receptacle 2.625" dia.	6.5	10	Yes		
814C	1 GFCI & 1 toggle switch	6.5	10	Yes		
814	1 GFCI & 1 toggle switch	7.3	10	No		
815C	1 Receptacle, 2.165" dia. hole, offset	6.5	10	Yes		
816C	1 Receptacle, 2.480" dia. hole	6.5	10	Yes		
817C	1 Receptacle, 2.275" dia. hole	6.5	10	Yes		
830C	1 Receptacle, 2.55" dia. hole	6.5	10	Yes		
831C	1 Duplex, 1 20A Twist Lock® 1.620" dia.	6.5	10	Yes		
902C	1 Duplex receptacle	6.5	10	Yes		
906C	1 Dup. & 1 toggle switch	6.5	10	Yes		
907C	2 Duplex receptacles	6.5	10	Yes		
915C	1 GFCI & 1 duplex receptacle	6.5	10	Yes		
915	GFCI & 1 duplex receptacle	7.3	10	No		

A32

4-11/16" SQUARE BOXES

1-1/2" AND 2-1/8" DEEP

RACO STEEL BOXES & COVERS

Applications

- Boxes are used for a wide variety of industrial applications where larger-sized conductors or wiring devices are needed and more volume is required
- Drawn boxes are ideal for exposed work applications (surface mounted wiring)

Product Features

- Reference Box Selection section in the front of this catalog for complete description of bracket and clamp types and features
- BOX-LOC® (MS) Bracket Box is a snap to install. Place the bracket on the open side of the stud first. Slots in the bracket engage the lip of the stud and actually crimp it as you press the bracket on the stud. Barbed hooks dig into the flat side of the stud, quickly locking it in place
- Combination screw heads provide for faster installation
- TKO® knockouts offer greater flexibility with RACO® patented combination 1/2" and 3/4" knockout
- UBS Support - Welded to box, preset bend points to work with wall thickness 2-1/2" to 6"
- Red boxes, covers and extensions for dedicated life safety alarm circuits

4-11/16" SQUARE BOXES

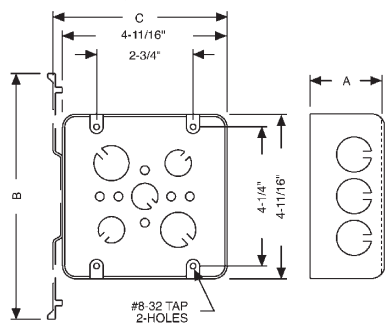

Compliances

- – File E195978
- **600V** Per U.L. 514-A, suitable for us without a bonding jumper in circuits up to 600 volts



ORDERING INFORMATION - DIMENSIONS

4-11/16" SQUARE BOXES – 1-1/2" DEEP – DRAWN WITH CONDUIT KO'S – 29.5 CUBIC INCHES

CATALOG NUMBER	DESCRIPTION BRACKET & SETBACK	KNOCKOUTS		STD. PKG.	RAISED GROUND PROVISION	UPC BAR CODE
		SIDES COND.	BOTTOM COND.			
245	—	12-1/2"	3-1/2", 2-3/4"	25	—	—
246	—	10-3/4"	3-1/2", 2-3/4"	25	—	—
247	—	8-1/2", 4- 3/4"	3-1/2", 2-3/4"	25	—	—

4-11/16" SQUARE BOXES – 2-1/8" DEEP – WELDED WITH CONDUIT KO'S – 42.0 CUBIC INCHES

CAT. NUMBER	DESCR. BRACKET & SETBACK	KNOCKOUTS		STD. PKG.	UBS SUP-PORT	PIG-TAIL	RSD. GRND. PRVSN.	UPC BAR CODE
		SIDES COND.	BOTTOM COND.					
600V 257	—	12-TKO®	1-1/2", 3-TKO®	25	No	—	Yes	—
600V 8257	—	12-TKO®	1-1/2", 3-TKO®	25	No	—	Yes	
600V 257F	—	12-TKO®	1-1/2", 3-TKO®	20	Yes	Yes	Yes	—
600V 257H	HM	12-TKO®	1-1/2", 3-TKO®	20	Yes	Yes	Yes	—
600V 257HS*	HM	12-TKO®	1-1/2", 3-TKO®	20	Yes	Yes	Yes	—
600V 257M	HM	12-TKO®	1-1/2", 3-TKO®	20	Yes	Yes	Yes	—
600V 257SM	—	12-TKO®	1-1/2", 3-TKO®	25	No	Yes	Yes	
600V 258	—	8-1"	1-1/2", 3-TKO®	25	No	—	Yes	—
600V 258SM	—	8-1"	1-1/2", 3-TKO®	25	No	Yes	Yes	
600V 259	—	6-1-1/4"	1-1/2", 3-TKO®	25	No	—	Yes	—
600V 265	—	4-3/4", 4-1"	1-1/2", 3-TKO®	25	No	—	Yes	—
600V 8265	—	4-3/4", 4-1"	1-1/2", 3-TKO®	25	No	—	Yes	
600V 254	FM brkt.	9-TKO®	1-1/2", 3-TKO®	25	No	—	Yes	
600V 266	BOX-LOC®	9-TKO, MS fish.	1-1/2", 3-TKO®	25	No	—	Yes	
600V 911-12	—	12-TKO®	1-1/2", 2-3/4", 2-TKO	25	No	—	No	—

*Box has stranded pigtail assembled

4-11/16" SQUARE BOXES – 2-1/8" DEEP – WELDED WITH ARMORED CABLE/METAL CLAD/FLEX CLAMPS – 42.0 CUBIC INCHES

CATALOG NUMBER	DESCRIPTION BRACKET & SETBACK	KNOCKOUTS		STD. PKG. CODE	UPC BAR	
		SIDES CABLE	BOTTOM COND.			
600V 252	—	4	6-TKO	1-1/2"	25	

DIMENSIONS

CATALOG NUMBER	A (INSIDE)	B	C
245, 246, 247	1-1/2"	—	—
257H, 257HS, 257M	2-1/8"	—	—
266	2-1/8"	4-5/8"	6-3/16"
254	2-1/8"	7-5/8"	5-1/16"
252, 257, 8257, 257F, 257SM 258, 258SM, 259, 265, 8265	2-1/8"	—	—



4714, THE INSIDER® will secure nonmetallic sheathed cable in 1/2" KO (See pg. B87)

4-11/16" SQUARE COVERS AND EXTENSIONS

1-1/2" DEEP AND 2-1/8" DEEP



Applications

- Extension rings provide a means for adding additional cubic capacity or as an outlet box for surface conduit
- Covers are used to close an outlet box
- Raised device covers are used for mounting switches or receptacles

Product Feature

- Angled mounting slots compensate up to 12° for box misalignment
- Red boxes, covers and extensions for dedicated life safety alarm circuits

Compliances

-  – File E195978
-  – File LR-1082



RACO STEEL BOXES & COVERS

ORDERING INFORMATION - DIMENSIONS

4-11/16" SQUARE EXTENSION – 1-1/2" DEEP (INSIDE) – DRAWN WITH CONDUIT KO'S – 29.5 CUBIC INCHES

CATALOG NUMBER	DESCRIPTION BRACKET & SETBACK	KNOCKOUTS		STD. PKG.	STD. PKG.
		SIDE COND.	BOTTOM COND.		
250	—	8-1/2", 4-3/4"	—	25	

4-11/16" SQUARE EXTENSION – 2-1/8" DEEP (INSIDE) – DRAWN WITH CONDUIT KO'S – 43.0 CUBIC INCHES

CATALOG NUMBER	DESCRIPTION BRACKET & SETBACK	KNOCKOUTS		STD. PKG.	STD. PKG.
		SIDE COND.	BOTTOM COND.		
262	—	8-1/2", 4-3/4"	—	25	

4-11/16" SQUARE COVERS

CATALOG NUMBER	DESCRIPTION	CU. IN. CAP.	STD. PKG.	UPC BAR CODE
832	Flat, blank	—	50	
833	Flat, 1/2"KO centered	—	50	
8833-5	Flat, 1/2" KO centered	—	50*	
911-11	Red, Flat, blank	—	50	—

*5 Bundles of 10

4-11/16" SQUARE FIXTURE COMBINATION DEVICE AND TILE COVERS – SINGLE DEVICE

CATALOG NUMBER	DESCRIPTION	CU. IN. CAP.	STD. PKG.	UPC BAR CODE	RECOMMENDED MAX. SUPPORT LOADS	
					CEILING FAN (DYNAMIC) LBS.	FIXTURE (STATIC) LBS.
829	Raised 1/2", open, ears 2-3/4" O.C.	3.0	25		—	50
835	Raised 5/8", open, ears 2-3/4" O.C.	4.0	25	—	—	50
837	Raised 1/2"	3.5	25	—	—	—
8837	Raised 1/2"	3.5	25		—	—
843	Raised 5/8"	4.5	25		—	—
838	Raised 3/4"	5.5	25	—	—	—
839	Raised 1"	7.5	25	—	—	—
842	Raised 1-1/4"	9.5	25	—	—	—
898	Raised 1-1/2"	11.0	20	—	—	—
899	Raised 2"	16.0	20	—	—	—

A34

4-11/16" SQUARE COVERS



Applications

- Raised device covers are for mounting switches or receptacles
- Exposed work covers are used to support switches or receptacles independent of the box

Product Features

- RACO® exposed work covers meet the requirements of the 2008 NEC Article 250.146 (A). No bonding jumper is required for covers with (1) flat corners (2) two or more device attachment screws and (3) a lockwasher or equivalent
- RACO® exposed work covers include required hardware needed for mounting the device(s)
- Hardware and cover are packed in a poly-bag printed with catalog number, compliances and installation instructions

Compliances

-  – File E195978
-  – File LR-1082

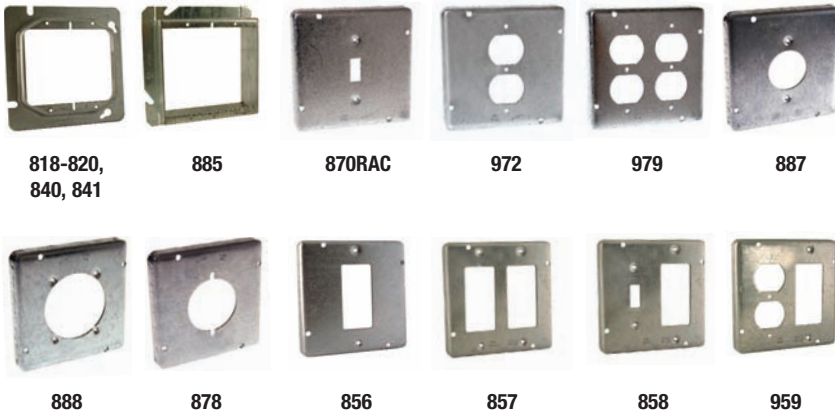
**ORDERING INFORMATION - DIMENSIONS**

4-11/16" SQUARE COMBINATION DEVICE AND TILE COVERS – TWO DEVICE				
CATALOG NUMBER	DESCRIPTION	CU. IN.	STD. PKG.	UPC BAR CODE
841	Raised 1/2"	5.5	25	
818	Raised 5/8"	7.3	25	—
840	Raised 3/4"	8.8	25	—
819	Raised 1"	12.0	25	—
820	Raised 1-1/4"	15.0	25	—
885	Raised 1-1/2"	15.5	20	—

4-11/16" SQUARE SURFACE COVERS – RAISED 1/2"				
CATALOG NUMBER	DESCRIPTION	CU. IN.	STD. PKG.	UPC BAR CODE
856	1 Decorator dev. or GFCI	10.3	10	
857	2 Decorator dev. or GFCI	10.3	10	
858	1 Toggle & 1 GFCI	10.3	10	
870RAC	1 Toggle switch	10.3	10	
878	30-50A Receptacle 2.141" dia.	10.3	10	
887	20A Receptacle 1.594" dia.	10.3	10	
888	30-60A Receptacle 2.625" dia.	10.3	10	
959	1 Duplex & 1 GFCI	10.3	10	
972	1 Duplex receptacle	10.3	10	
979	2 Duplex receptacles	10.3	10	

HANDY BOXES

1-1/2" AND 1-7/8" DEEP

Applications

- Handy Boxes, also called utility boxes, are used for convenience outlets, switch boxes or small junction boxes
- They are popular for exposed work applications (surface mounted wiring)
- The NEC requires that surface-mounted wiring be enclosed with a protective covering such as EMT conduit

Product Features

- Reference Box Selection section in the front of this catalog for complete description of bracket types and features

STEEL HANDY BOXES

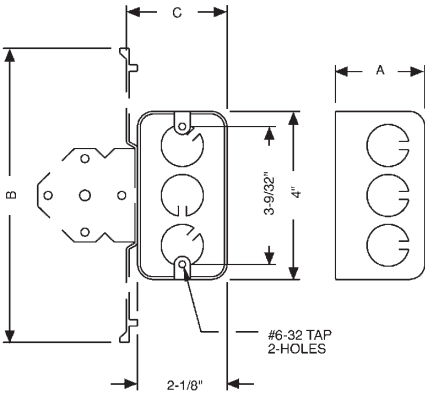

Compliances

- – File E195978
- – File LR-1082 (611 only)

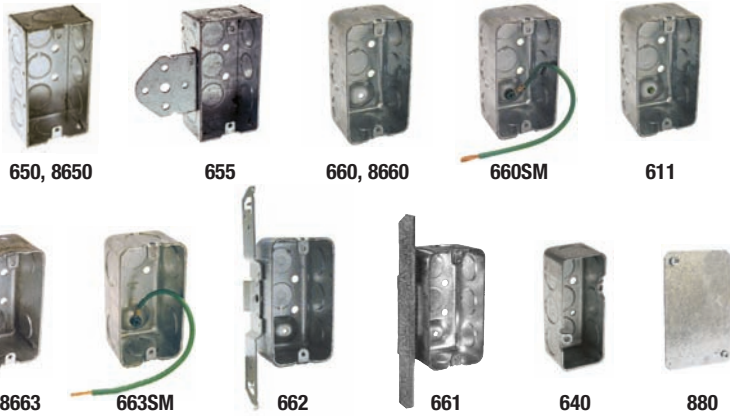

RACO STEEL BOXES & COVERS

ORDERING INFORMATION - DIMENSIONS

4" x 2" HANDY BOXES – 1-1/2" DEEP (INSIDE) – WELDED WITH CONDUIT KO'S – 11.5 CUBIC INCHES								
CATALOG NUMBER	DESCRIPTION BRACKET & SETBACK	KNOCKOUTS			STD. PKG.	PIG-TAIL	RSD. GRND. PRVSN.	UPC BAR CODE
		SIDES	ENDS	BOTTOM				
650	—	6-1/2"	2-1/2"	3-1/2"	50	—	—	—
8650	—	6-1/2"	2-1/2"	3-1/2"	50	—	—	
655	B brkt., 1/4"	3-1/2"	2-1/2"	3-1/2"	50	—	—	—

4" x 2" HANDY BOXES – 1-7/8" DEEP (INSIDE) – DRAWN WITH CONDUIT KO'S – 13.0 CUBIC INCHES								
CATALOG NUMBER	DESCRIPTION BRACKET & SETBACK	KNOCKOUTS			STD. PKG.	PIG-TAIL	RSD. GRND. PRVSN.	UPC BAR CODE
		SIDES	ENDS	BOTTOM				
611	Ground screw incl.	6-1/2"	2-1/2"	2-1/2"	50	No	Yes	—
660	—	6-1/2"	2-1/2"	2-1/2"	50	No	Yes	—
8660	—	6-1/2"	2-1/2"	2-1/2"	50	No	Yes	
660SM	—	6-1/2"	2-1/2"	2-1/2"	50	Yes	Yes	
661	A brkt., 5/8"	3-1/2"	2-1/2"	2-1/2"	50	No	Yes	
662	TS brkt., 1/2"	3-1/2"	2-1/2"	2-1/2"	50	No	Yes	
663	—	4-3/4"	2-3/4"	1-3/4"	50	No	Yes	—
8663	—	4-3/4"	2-3/4"	1-3/4"	50	No	Yes	
663SM	—	4-3/4"	2-3/4"	1-3/4"	50	Yes	Yes	

3-3/4" x 1-9/16" INDUSTRIAL HANDY BOX & COVER – 1-1/2" DEEP (INSIDE) – DRAWN WITH CONDUIT KO'S – 7.3 CUBIC INCHES						
CATALOG NUMBER	DESCRIPTION BRACKET & SETBACK	KNOCKOUTS			STD. PKG.	UPC BAR CODE
		SIDES	ENDS	BOTTOM		
640	—	6-1/2"	2-1/2"	3-1/2"	50	—
880	Blank cover & captive screws	—	—	—	50	—

DIMENSIONS			
CATALOG NUMBER	A	B	C
661	1-7/8"	6-7/16"	2-11/32"
662	1-7/8"	7"	2-3/8"
655	1-1/2"	1-31/32"	4"



4714, THE INSIDER® will secure nonmetallic sheathed cable in 1/2" KO (See pg. B87)

A36

HANDY BOXES

2-1/8" DEEP

RACO STEEL BOXES & COVERS

Applications

- Handy Boxes, also called utility boxes, are used for convenience outlets, switch boxes or small junction boxes
- They are popular for exposed work applications (surface mounted wiring)
- The NEC requires that surface mounted wiring be enclosed with a protective covering such as EMT conduit

Product Features

- Reference Box Selection section in the front of this catalog for complete description of bracket types and features

STEEL HANDY BOXES

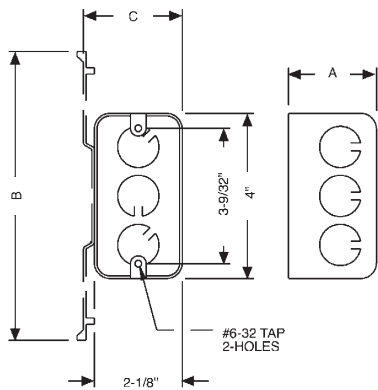

670RAC, 8670

674

678

671

ORDERING INFORMATION - DIMENSIONS

4" x 2" HANDY BOXES – 2-1/8" DEEP (INSIDE) – WELDED WITH CONDUIT KO'S – 16.5 CUBIC INCHES							
CATALOG NUMBER	DESCRIPTION BRACKET & SETBACK	KNOCKOUTS			STD. PKG.	RAISED GROUNDING PROVISION	UPC BAR CODE
		SIDES	ENDS	BOTTOM			
670RAC	—	6-1/2"	2-1/2"	3-1/2"	50	—	—
8670	—	6-1/2"	2-1/2"	3-1/2"	50	—	
674	—	4-3/4"	2-3/4"	2-3/4"	50	—	
678	TS brkt., 1/2	3-1/2"	2-1/2"	3-1/2"	50	—	
671	A brkt., 5/8"	3-1/2"	2-1/2"	3-1/2"	50	—	

DIMENSIONS			
CATALOG NUMBER	A	B	C
670RAC, 8670	2-1/8"	—	—
674	2-1/8"	—	—
678	2-1/8"	7"	2-3/8"
671	2-1/8"	6-7/16"	2-11/32"

Compliances

- – File E195978

All RACO® Handy Box, U.L. listed steel boxes are acceptable for use in 2-hour fire rated walls. For additional information, consult U.L. "Fire Resistance Directory" or the U.L. website at www.ul.com

4714, THE INSIDER® will secure nonmetallic sheathed cable in 1/2" KO (See pg. B87)



HANDY BOX COVERS AND EXTENSION



Applications

- Handy Box covers are used to close a Handy Box
- Covers also may be used as single-gang wall plates
- Extension rings provide a means for adding additional cubic capacity or as an outlet box for surface conduit

Product Features

- RACO® Handy Box covers are designed to match the contours of the box
- Cover corners are rounded
- All covers have captive screws

Compliances

-  – File E195978 (Cat. #861 not UL Listed)
-  – File LR-1082 (Covers only)

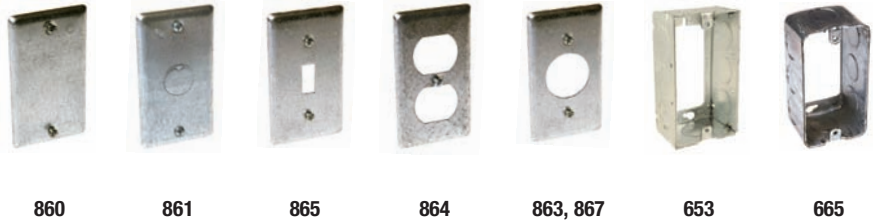

RACO STEEL BOXES
& COVERS

ORDERING INFORMATION - DIMENSIONS

4" x 2" HANDY BOX COVERS – 2-5/16" WIDE x 4-3/16" LENGTH			
CATALOG NUMBER	DESCRIPTION	STD. PKG.	UPC BAR CODE
860	Blank	25	
861	1/2" KO centered	25	
865	Toggle switch	25	
864	Duplex receptacle	25	
863	Single receptacle 1.406" dia.	25	
867	20A Receptacle 1.594" dia.	25	

4" x 2" HANDY BOX EXTENSION – 1-1/2" DEEP (INSIDE) – WELDED WITH CONDUIT KO'S – 11.5 CUBIC INCHES						
CATALOG NUMBER	DESCRIPTION BRACKET & SETBACK	KNOCKOUTS			STD. PKG.	UPC BAR CODE
		SIDES	ENDS	BOTTOM		
653	—	6-1/2"	2-1/2"	—	25	

4" x 2" HANDY BOX EXTENSION – 1-7/8" DEEP (INSIDE) – DRAWN WITH CONDUIT KO'S – 13.0 CUBIC INCHES						
CATALOG NUMBER	DESCRIPTION BRACKET & SETBACK	KNOCKOUTS			STD. PKG.	UPC BAR CODE
		SIDES	ENDS	BOTTOM		
665	—	6-1/2"	2-1/2"	—	50	

A38

SWITCH BOXES

SINGLE GANG - 1" DEEP

RACO STEEL BOXES
& COVERS**Application**

- Shallow switch boxes are made for use with furring strips and 1/4" paneling

Product Features

- RACO® "D" bracket is pre-scored and can be broken off if needed
- Reference Box Selection section in the front of this catalog for complete description of bracket types and features
- 418 will accept 4" square mud ring or cover

Compliances

-  – File E195978 (Cat. #404 and #405 not UL Listed)



All RACO® single gang, two gang, 4" square, and single gang gangable U.L. listed steel boxes are acceptable for use in 2-hour fire rated walls. For additional information, consult U.L. "Fire Resistance Directory" or the U.L. website at www.ul.com



404



405



418

ORDERING INFORMATION - DIMENSIONS

3-3/4" x 2" SWITCH BOXES – 1" DEEP – NONGANGABLE – WITH NONMETALLIC SHEATHED CABLE CLAMPS – 6.5 CUBIC INCHES

CATALOG NUMBER	DESCRIPTION BRACKET & SETBACK	KNOCKOUTS				STD. PKG.	UPC BAR CODE
		SIDES COND.	ENDS		BOTTOM COND.		
			CABLE	COND.			
404	Q clamp, 1/4"	—	2	1-1/2"	—	25	
405	Q clamp, 1/4"	—	4	—	—	25	

4" x 4" SWITCH BOX – 1" DEEP – NONGANGABLE – WITH NONMETALLIC SHEATHED CABLE CLAMPS – 14.8 CUBIC INCHES

CATALOG NUMBER	DESCRIPTION BRACKET & SETBACK	KNOCKOUTS				STD. PKG.	UPC BAR CODE
		SIDES COND.	ENDS		BOTTOM COND.		
			CABLE	COND.			
418	(2) Q clamp, 1/4"	—	4	2-1/2"	—	25	

SWITCH BOXES

SINGLE GANG - 1-1/2" AND 2" DEEP

Application

- Switch boxes are used to house wiring devices such as switches or outlets

Product Features

- Gangable switch boxes offer the option of constructing a box to hold two or more devices
- Plaster ears allow box to be used in "old work" applications

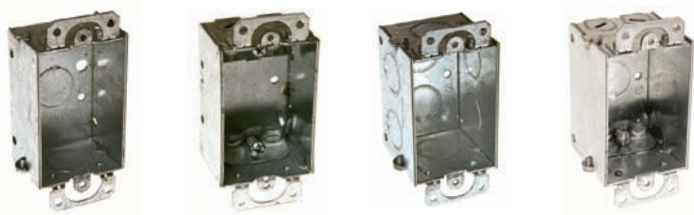

400 410 420, 8420 445

RACO STEEL BOXES & COVERS

STEEL SWITCH BOXES

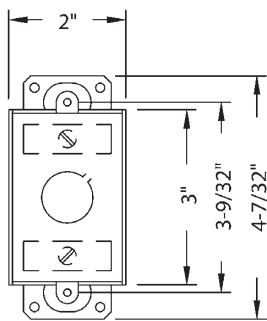

Compliances

- – File E195978

All RACO® single gang, two gang, 4" square, and single gang gangable U.L. listed steel boxes are acceptable for use in 2-hour fire rated walls. For additional information, consult U.L. "Fire Resistance Directory" or the U.L. website at www.ul.com

ORDERING INFORMATION - DIMENSIONS

3" x 2" SWITCH BOX – 1-1/2" DEEP – GANGABLE WITH CONDUIT KO'S – 7.5 CUBIC INCHES						
CATALOG NUMBER	DESCRIPTION BRACKET & SETBACK	KNOCKOUTS			STD. PKG.	UPC BAR CODE
		SIDES	ENDS	BOTTOM		
400	Ears	—	2-1/2"	1-1/2"	20	

3" x 2" SWITCH BOX – 1-1/2" DEEP – NONGANGABLE WITH NONMETALLIC SHEATHED CABLE CLAMPS – 7.5 CUBIC INCHES							
CATALOG NUMBER	DESCRIPTION BRACKET & SETBACK	KNOCKOUTS			STD. PKG.	UPC BAR CODE	
		SIDES COND.	ENDS				BOTTOM COND.
			CABLE	COND.			
410	Ears	—	4	—	50		

3" x 2" SWITCH BOX – 2" DEEP – GANGABLE WITH CONDUIT KO'S – 10.0 CUBIC INCHES						
CATALOG NUMBER	DESCRIPTION BRACKET & SETBACK	KNOCKOUTS			STD. PKG.	UPC BAR CODE
		SIDES	ENDS	BOTTOM		
420	Ears	4-1/2"	2-1/2"	2-1/2"	50	—
8420	Ears	4-1/2"	2-1/2"	2-1/2"	50	

3" x 2" SWITCH BOX – 2" DEEP – GANGABLE WITH NONMETALLIC SHEATHED CABLE CLAMPS – 10.0 CUBIC INCHES							
CATALOG NUMBER	DESCRIPTION BRACKET & SETBACK	KNOCKOUTS			STD. PKG.	UPC BAR CODE	
		SIDES COND.	ENDS				BOTTOM COND.
			CABLE	COND.			
445	Ears	—	4	—	50	—	

4714, THE INSIDER® will secure nonmetallic sheathed cable in 1/2" KO (See pg. B87)



A40

SWITCH BOXES

SINGLE GANG - 2", 2-1/8" AND 2-1/4" DEEP

RACO STEEL BOXES & COVERS

Application

- Switch boxes are used to house wiring devices such as switches or outlets

Product Features

- Gangable boxes offer the option of constructing a box to hold two or more devices
- Beveled corner boxes are designed to prevent the clamp screws from protruding into back wall
- Plaster ears allow box to be used in "old work" applications
- Reference box selection section in the front of this catalog for complete description of clamp types and features

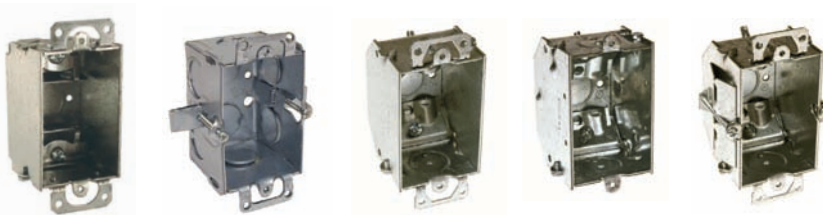

440 513 471, 8471 473 487

STEEL SWITCH BOXES

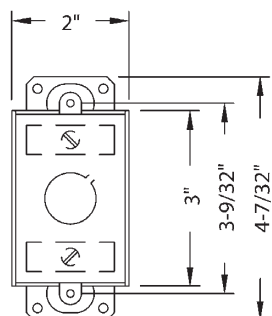

Compliance

- – File E195978 (Cat. #513 not UL Listed)



All RACO® single gang, two gang, 4" square, and single gang gangable U.L. listed steel boxes are acceptable for use in 2-hour fire rated walls. For additional information, consult U.L. "Fire Resistance Directory" or the U.L. website at www.ul.com

ORDERING INFORMATION - DIMENSIONS

3" x 2" SWITCH BOX – 2" DEEP – GANGABLE WITH ARMORED CABLE/METAL CLAD/FLEX CLAMPS – 10.0 CUBIC INCHES							
CATALOG NUMBER	DESCRIPTION BRACKET & SETBACK	KNOCKOUTS			STD. PKG.	UPC BAR CODE	
		SIDES COND.	CABLE	COND.			BOTTOM COND.
440	Ears	—	4	—	1-1/2"	50	—

3" x 2" SWITCH BOX – 2-1/8" DEEP – NONGANGABLE – "SNAP IN CLIP" "OLD WORK" WITH CONDUIT KO'S – 11.0 CUBIC INCHES							
CATALOG NUMBER	DESCRIPTION BRACKET & SETBACK	KNOCKOUTS			STD. PKG.	UPC BAR CODE	
		SIDES	ENDS	BOTTOM			
513	Old Work With Snap In Clips And Ears	4-1/2"	2-1/2"	2-1/2"	24		

3" x 2" SWITCH BOXES – 2-1/4" DEEP – GANGABLE – BEVELED CORNERS WITH NONMETALLIC SHEATHED CABLE CLAMPS – 10.5 CUBIC INCHES							
CATALOG NUMBER	DESCRIPTION BRACKET & SETBACK	KNOCKOUTS			STD. PKG.	UPC BAR CODE	
		SIDES COND.	CABLE	COND.			BOTTOM COND.
471	One screw, Ears	—	4	—	1-1/2"	50	—
8471	One screw, Ears	—	4	—	1-1/2"	50	
473	Level bumps	—	4	2-1/2"	1-1/2"	20	
487	Old work, Tigergr [®]	—	4	—	1-1/2"	20	



SWITCH BOXES

SINGLE GANG - 2-1/2" DEEP

Application

- Switch boxes are used to house wiring devices such as switches or outlets

Product Features

- Reference Box Selection section in the front of this catalog for complete description of bracket types and features
- Gangable switch boxes offer the option of constructing a box to hold two or more devices
- Plaster ears allow the box to be used in "old work" applications

STEEL SWITCH BOXES

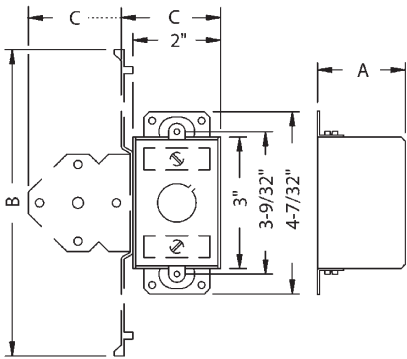

Compliance

- **UL** – File E195978

All RACO® single gang, two gang, 4" square, and single gang gangable U.L. listed steel boxes are acceptable for use in 2-hour fire rated walls. For additional information, consult U.L. "Fire Resistance Directory" or the U.L. website at www.ul.com

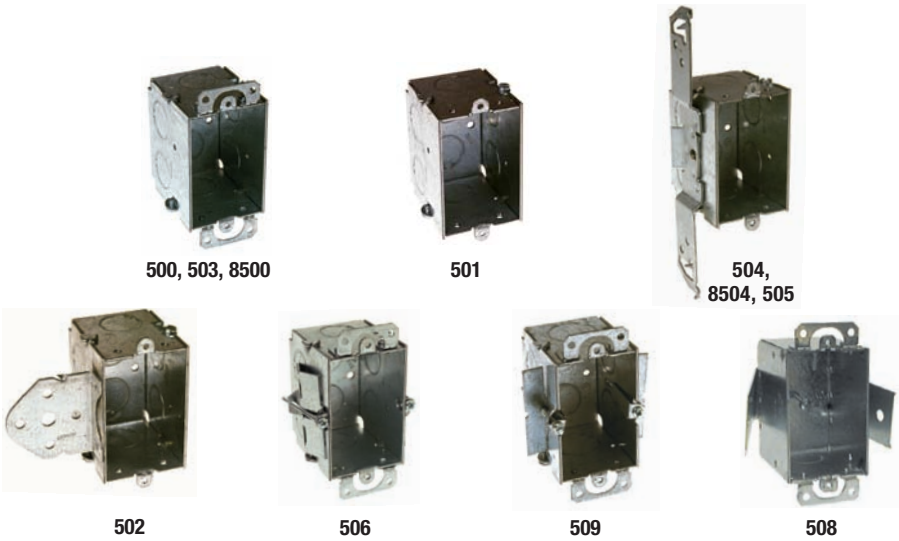

RACO STEEL BOXES & COVERS

ORDERING INFORMATION - DIMENSIONS

3" x 2" SWITCH BOXES – 2-1/2" DEEP – GANGABLE WITH CONDUIT KO'S – 12.5 CUBIC INCHES

CATALOG NUMBER	DESCRIPTION BRACKET & SETBACK	KNOCKOUTS			STD. PKG.	UPC BAR CODE
		SIDES	ENDS	BOTTOM		
500	Ears	4-1/2"	2-1/2"	2-1/2"	50	—
8500	Ears	4-1/2"	2-1/2"	2-1/2"	25	
501	Without ears	4-1/2"	2-1/2"	2-1/2"	50	
502	B brkt., 5/8"	4-1/2"	2-1/2"	2-1/2"	10	—
503	Ears	4-1/2"	2-3/4"	2-1/2"	50	—
504	TS brkt., 1/2"	2-1/2"	2-1/2"	2-1/2"	50	—
8504	TS brkt., 1/2"	2-1/2"	2-1/2"	2-1/2"	20	
505	TS brkt., 1/2"	2-1/2"	2-3/4"	2-1/2"	50	—
506	Old work, Tigergrip®	—	2-1/2"	2-1/2"	20	
509	Old work	—	2-1/2"	2-1/2"	20	

3" x 2" SWITCH BOX – 2-1/2" DEEP – NONGANGABLE WITH CONDUIT KO'S – 12.5 CUBIC INCHES

CATALOG NUMBER	DESCRIPTION BRACKET & SETBACK	KNOCKOUTS			STD. PKG.	UPC BAR CODE
		SIDES COND.	ENDS CABLE COND.	BOTTOM COND.		
508	Old work, 3/4" sheet rock max.	—	—	2-1/2"	20	

DIMENSIONS

CATALOG NUMBER	A	B	C
500, 8500	2-1/2"	—	—
501	2-1/2"	—	—
502	2-1/2"	1-31/32"	4"
503	2-1/2"	—	—
504, 8504	2-1/2"	7"	2-13/64"
505	2-1/2"	7"	2-13/64"
506	2-1/2"	—	—
508	2-1/2"	—	—
509	2-1/2"	—	—

4714, THE INSIDER® will secure nonmetallic sheathed cable in 1/2" KO (See pg. B87)



A42

SWITCH BOXES

SINGLE GANG - 2-1/2" DEEP WITH NONMETALLIC CABLE CLAMPS

RACO STEEL BOXES & COVERS

Application

- Switch boxes are used to house wiring devices such as switches or outlets

Product Features

- Reference Box Selection section in the front of this catalog for complete description of bracket and clamp types and features
- Gangable switch boxes offer the option of constructing a box to hold two or more devices
- Plaster ears allow box to be used in "old work" applications

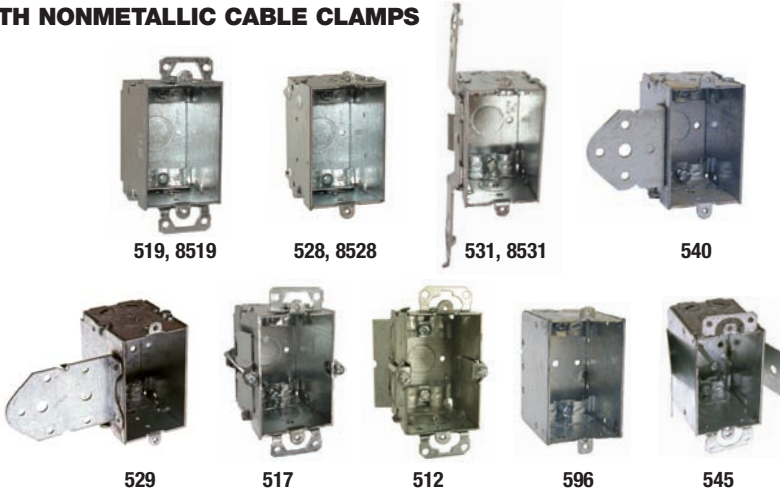

STEEL SWITCH BOXES

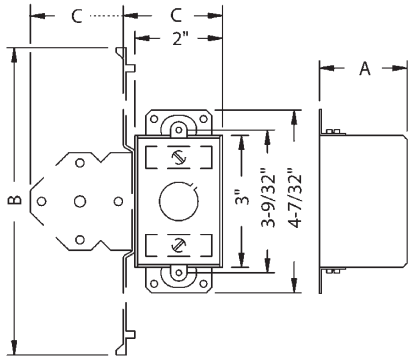

Compliance

- – File E195978

All RACO® single gang, two gang, 4" square, and single gang gangable U.L. listed steel boxes are acceptable for use in 2-hour fire rated walls. For additional information, consult U.L. "Fire Resistance Directory" or the U.L. website at www.ul.com

ORDERING INFORMATION - DIMENSIONS

3" x 2" SWITCH BOXES – 2-1/2" DEEP – GANGABLE WITH NONMETALLIC SHEATHED CABLE CLAMPS – 12.5 CUBIC INCHES							
CATALOG NUMBER	DESCRIPTION BRACKET & SETBACK	KNOCKOUTS			STD. PKG.	UPC BAR CODE	
		SIDE COND.	ENDS CABLE COND.	BOTTOM COND.			
512	Ears, Old work	—	4	—	1-1/2"	20	—
517	Ears, Old work, Tigergrip®	—	4	—	1-1/2"	20	
519	Ears	—	4	—	1-1/2"	50	—
8519	Ears	—	4	—	1-1/2"	50	
528	Level bumps	—	4	2-1/2"	1-1/2"	50	—
8528	Level bumps	—	4	2-1/2"	1-1/2"	25	
529	LB brkt., 5/8"	—	4	2-1/2"	1-1/2"	20	
531	TS brkt., 1/2"	—	4	2-1/2"	1-1/2"	50	—
8531	TS brkt., 1/2"	—	4	2-1/2"	1-1/2"	50	
540	B brkt., 1/4"	—	4	2-1/2"	1-1/2"	50	—

3" x 2" SWITCH BOXES – 2-1/2" DEEP – NONGANGABLE WITH NONMETALLIC SHEATHED CABLE CLAMPS – 12.5 CUBIC INCHES							
CATALOG NUMBER	DESCRIPTION BRACKET & SETBACK	KNOCKOUTS			STD. PKG.	UPC BAR CODE	
		SIDE COND.	ENDS CABLE COND.	BOTTOM COND.			
545	Ears, Old work, 3/4" sheet rock max.	—	4	2-1/2"	—	20	
596	Without ears	—	4	2-1/2"	—	50	—

DIMENSIONS			
CATALOG NUMBER	A	B	C
512	2-1/2"	—	—
517	2-1/2"	—	—
519, 8519	2-1/2"	—	—
528, 8528	2-1/2"	—	—
529	2-1/2"	1-31/32"	5-3/64"
531, 8531	2-1/2"	7"	2-13/64"
540	2-1/2"	1-31/32"	4"
545	2-1/2"	—	—
596	2-1/2"	—	—



SWITCH BOXES

SINGLE GANG - 2-1/2" DEEP WITH ARMORED CABLE CLAMPS

Application

- Switch boxes are used to house wiring devices such as switches or outlets

Product Features

- Reference Box Selection section in the front of this catalog for complete description of bracket and clamp types and features
- Gangable switch boxes offer the option of constructing a box to hold two or more devices
- Plaster ears allow box to be used in "old work" applications

STEEL SWITCH BOXES

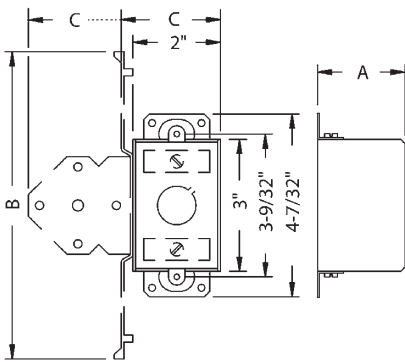

Compliance

- – File E195978

All RACO® single gang, two gang 4" square, and single gang gangable boxes U.L. listed steel boxes are acceptable for use in 2-hour fire rated walls. For additional information, consult U.L. "Fire Resistance Directory" or the U.L. website at www.ul.com

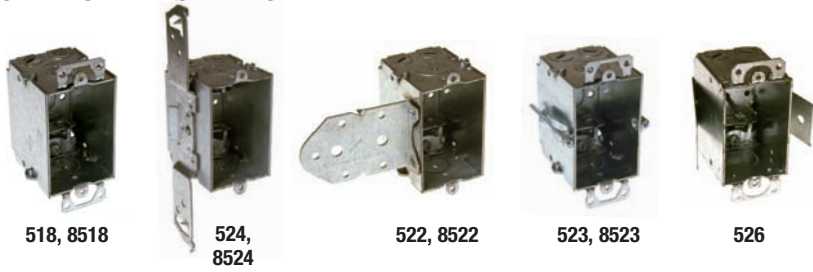

RACO STEEL BOXES & COVERS

ORDERING INFORMATION - DIMENSIONS

3" x 2" SWITCH BOXES – 2-1/2" DEEP – GANGABLE WITH ARMORED CABLE/METAL CLAD/ FLEX CLAMPS – 12.5 CUBIC INCHES

CATALOG NUMBER	DESCRIPTION BRACKET & SETBACK	KNOCKOUTS			STD. PKG.	UPC BAR CODE	
		SIDES COND.	ENDS				BOTTOM COND.
	CABLE		COND.				
518	Ears	—	4	—	1-1/2"	50	—
8518	Ears	—	4	—	1-1/2"	50	
522	LB brkt., 5/8"	—	4	2-1/2"	1-1/2"	50	—
8522	LB brkt., 5/8"	—	4	2-1/2"	1-1/2"	50	
523	Ears, Old work, Griptite	—	4	—	1-1/2"	—	
8523	Ears, Old work, Griptite	—	4	—	1-1/2"	50	
524	TS brkt., 1/2"	—	4	2-1/2"	1-1/2"	50	—
8524	TS brkt., 1/2"	—	4	2-1/2"	1-1/2"	50	

3" x 2" SWITCH BOX – 2-1/2" DEEP – NONGANGABLE WITH ARMORED CABLE/METAL CLAD/ FLEX CLAMPS – 12.5 CUBIC INCHES

CATALOG NUMBER	DESCRIPTION BRACKET & SETBACK	KNOCKOUTS			STD. PKG.	UPC BAR CODE	
		SIDES COND.	ENDS				BOTTOM COND.
	CABLE		COND.				
526	Ears, Old work, 3/4" sheet rock max.	—	4	—	—	20	

DIMENSIONS

CATALOG NUMBER	A	B	C
518, 8518	2-1/2"	—	—
522, 8522	2-1/2"	1-31/32"	5-3/64"
523, 8523	2-1/2"	—	—
524, 8524	2-1/2"	7"	2-13/64"
526	2-1/2"	1-3/8"	3-13/32"



A44

SWITCH BOXES

SINGLE GANG - 2-3/4" AND 2-27/32" DEEP

RACO STEEL BOXES & COVERS

Application

- Switch boxes are used to house wiring devices such as switches or outlets

Product Features

- RACO® 353, 355 and 8355 are extra-wide for ease of GFCI device installation
- Reference Box Selection section in the front of this catalog for complete description of bracket and clamp types and features
- Plaster ears allow the box to be used in "old work" applications



353



355, 8355



560, 8560, 565



561



562

CAT. NO. 353, 355, 8355

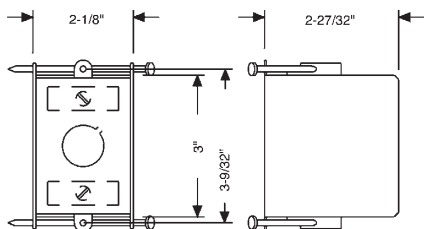

STEEL SWITCH BOXES

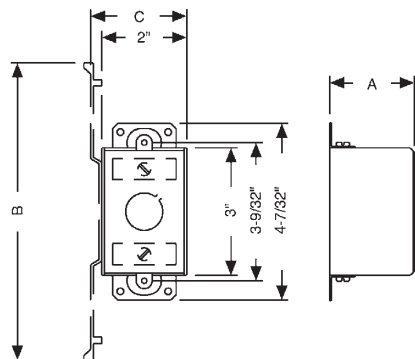

Compliance

- – File E195978



All RACO® single gang, two gang, 4" square, and single gang gangable U.L. listed steel boxes are acceptable for use in 2-hour fire rated walls. For additional information, consult U.L. "Fire Resistance Directory" or the U.L. website at www.ul.com

ORDERING INFORMATION - DIMENSIONS

3" x 2-1/8" SWITCH BOX – 2-27/32" DEEP – NONGANGABLE WITH ARMORED CABLE/ METAL CLAD/FLEX CLAMPS – 15.8 CUBIC INCHES

CATALOG NUMBER	DESCRIPTION BRACKET & SETBACK	KNOCKOUTS				STD. PKG.	UPC BAR CODE
		SIDES	ENDS		BOTTOM		
		COND.	CABLE COND.	COND.			
353	S brkt., Nails	—	4	—	1-1/2"	50	

3" x 2-1/8" SWITCH BOX – 2-27/32" DEEP – NONGANGABLE WITH NONMETALLIC SHEATHED CABLE CLAMPS – 15.8 CUBIC INCHES

CATALOG NUMBER	DESCRIPTION BRACKET & SETBACK	KNOCKOUTS				STD. PKG.	UPC BAR CODE
		SIDES	ENDS		BOTTOM		
		COND.	CABLE COND.	COND.			
355	S brkt., Nails	—	4	—	1-1/2"	50	—
8355	S brkt., Nails	—	4	—	1-1/2"	20	

3" x 2" SWITCH BOXES – 2-3/4" DEEP – GANGABLE WITH CONDUIT KO'S – 14.0 CUBIC INCHES

CATALOG NUMBER	DESCRIPTION BRACKET & SETBACK	KNOCKOUTS			STD. PKG.	UPC BAR CODE
		SIDES	ENDS	BOTTOM		
		560	Ears	4-1/2"		
8560	Ears	4-1/2"	2-1/2"	2-1/2"	50	
565	Ears	4-3/4"	2-3/4"	2-1/2"	50	—
561	Without ears	4-1/2"	2-1/2"	2-1/2"	50	—
562	TS brkt., 1/2"	2-1/2"	2-1/2"	2-1/2"	50	—

DIMENSIONS

CATALOG NUMBER	A	B	C
560, 8560	2-3/4"	—	—
561	2-3/4"	—	—
562	2-3/4"	7"	2-13/64"
565	2-3/4"	—	—



4714, THE INSIDER® will secure nonmetallic sheathed cable in 1/2" KO (See pg. B87)



SWITCH BOXES

SINGLE GANG - 2-3/4" DEEP

Application

- Switch boxes are used to house wiring devices such as switches or outlets

Product Features

- Reference Box Selection section in the front of this catalog for complete description of bracket and clamp types and features
- Plaster ears allow the box to be used in "old work" applications

STEEL SWITCH BOXES

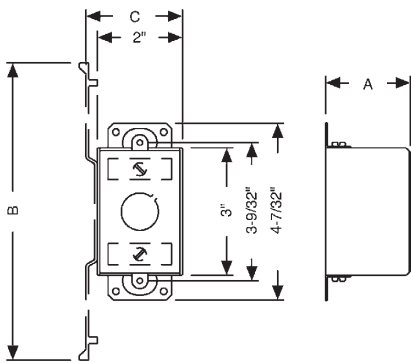

Compliances

- – File E195978

All RACO® single gang, two gang, 4" square, and single gang gangable U.L. listed steel boxes are acceptable for use in 2-hour fire rated walls. For additional information, consult U.L. "Fire Resistance Directory" or the U.L. website at www.ul.com

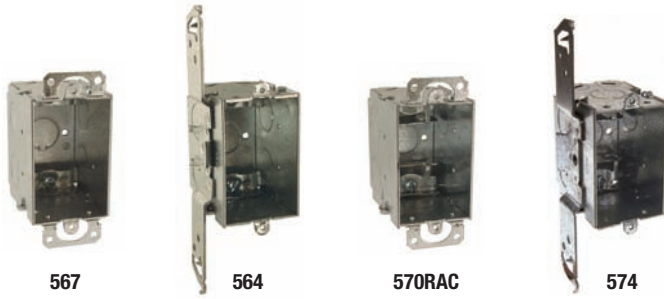

RACO STEEL BOXES & COVERS

ORDERING INFORMATION - DIMENSIONS

3" x 2" SWITCH BOXES – 2-3/4" DEEP – GANGABLE WITH NONMETALLIC SHEATHED CABLE CLAMPS – 14.0 CUBIC INCHES

CATALOG NUMBER	DESCRIPTION BRACKET & SETBACK	KNOCKOUTS				STD. PKG.	UPC BAR CODE
		SIDES COND.	ENDS		BOTTOM COND.		
			CABLE	COND.			
567	Ears	4-1/2"	4	2-1/2"	1-1/2"	50	
564	TS brkt., 1/2"	2-1/2"	4	2-1/2"	1-1/2"	50	

3" x 2" SWITCH BOXES – 2-3/4" DEEP – GANGABLE WITH ARMORED CABLE/METAL CLAD/FLEX CLAMPS – 14.0 CUBIC INCHES

CATALOG NUMBER	DESCRIPTION BRACKET & SETBACK	KNOCKOUTS				STD. PKG.	UPC BAR CODE
		SIDES COND.	ENDS		BOTTOM COND.		
			CABLE	COND.			
570RAC	Ears	4-1/2"	4	2-1/2"	1-1/2"	50	—
574	TS brkt., 1/2"	2-1/2"	4	2-1/2"	1-1/2"	25	

DIMENSIONS

CATALOG NUMBER	A	B	C
567	2-3/4"	—	—
564	2-3/4"	7"	2-13/64"
570RAC	2-3/4"	—	—
574	2-3/4"	7"	2-13/64"



A46

SWITCH BOXES

SINGLE GANG - 3-1/2" DEEP

RACO STEEL BOXES & COVERS

Application

- Switch boxes are used to house wiring devices such as switches or outlets

Product Features

- Reference Box Selection section in the front of this catalog for complete description of bracket and clamp types and features
- Gangable switch boxes offer the option of constructing a box to hold two or more devices
- Plaster ears allow the box to be used in "old work" applications

STEEL SWITCH BOXES

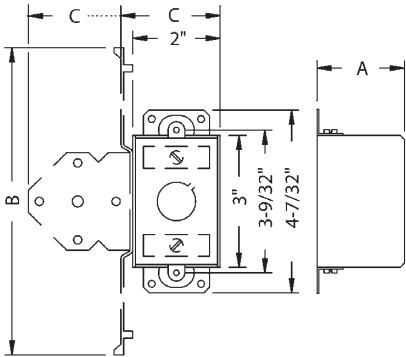

Compliance

- – File E195978



All RACO® single gang, two gang, 4" square, and single gang gangable U.L. listed steel boxes are acceptable for use in 2-hour fire rated walls. For additional information, consult U.L. "Fire Resistance Directory" or the U.L. website at www.ul.com

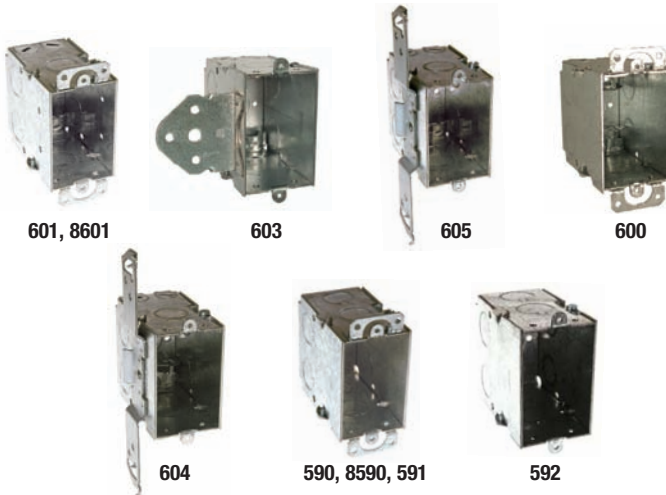

ORDERING INFORMATION - DIMENSIONS

3" x 2" SWITCH BOXES – 3-1/2" DEEP – GANGABLE WITH NONMETALLIC SHEATHED CABLE CLAMPS – 18.0 CUBIC INCHES

CATALOG NUMBER	DESCRIPTION BRACKET & SETBACK	KNOCKOUTS			STD. PKG.	UPC BAR CODE	
		SIDES COND.	ENDS CABLE COND.	BOTTOM COND.			
601	Ears	4-1/2"	4	2-1/2"	1-1/2"	25	—
8601	Ears	4-1/2"	4	2-1/2"	1-1/2"	25	
603	B brkt., 5/8"	4-1/2"	4	2-1/2"	1-1/2"	25	—
605	TS brkt., 1/2"	4-1/2"	4	2-1/2"	1-1/2"	25	

3" x 2" SWITCH BOXES – 3-1/2" DEEP – GANGABLE WITH ARMORED CABLE/METAL CLAD/FLEX CLAMPS – 18.0 CUBIC INCHES

CATALOG NUMBER	DESCRIPTION BRACKET & SETBACK	KNOCKOUTS			STD. PKG.	UPC BAR CODE	
		SIDES COND.	ENDS CABLE COND.	BOTTOM COND.			
600	Ears	4-1/2"	4	2-1/2"	1-1/2"	25	—
604	TS brkt., 1/2"	4-1/2"	4	2-1/2"	1-1/2"	25	

3" x 2" SWITCH BOXES – 3-1/2" DEEP – GANGABLE WITH CONDUIT KO'S – 18.0 CUBIC INCHES

CATALOG NUMBER	DESCRIPTION BRACKET & SETBACK	KNOCKOUTS			STD. PKG.	UPC BAR CODE
		SIDES	ENDS	BOTTOM		
590	Ears	4-1/2"	4-1/2"	1-1/2"	50	—
8590	Ears	4-1/2"	4-1/2"	1-1/2"	25	
591	Ears	4-3/4"	4-3/4"	1-1/2"	50	
592	Without ears	4-1/2"	4-1/2"	1-1/2"	50	—

DIMENSIONS

CATALOG NUMBER	A	B	C
590, 8590	3-1/2"	—	—
591	3-1/2"	—	—
592	3-1/2"	—	—
600	3-1/2"	—	—
601, 8601	3-1/2"	—	—
603	3-1/2"	1-31/32"	4"
604	3-1/2"	7"	2-13/64"
605	3-1/2"	7"	2-13/64"



4714, THE INSIDER® will secure nonmetallic sheathed cable in 1/2" KO (See pg. B87)

SWITCH BOXES AND WALL PLATES

TWO GANG, 2-1/8" DEEP

Applications

- Installers can save time and cut installation costs with two gang switch boxes
- Larger capacity boxes are ideal for today's designs where there is a need to install two devices at one location
- Drawn boxes are ideal for exposed work applications (surface mounted wiring)

Product Features

- 681, 685 bracketed boxes are set back 1/2" eliminating the need for a plaster ring
- Reference Box Selection section in the front of this catalog for complete description of bracket and clamp types and features
- Covers are unpainted and manufactured from pre-galvanized steel

TWO GANG SWITCH BOXES

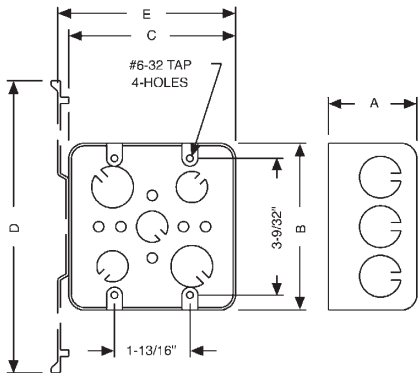

Compliance

- - File E195978

All RACO® single gang, two gang, 4" square, and single gang gangable U.L. listed steel boxes are acceptable for use in 2-hour fire rated walls. For additional information, consult U.L. "Fire Resistance Directory" or the U.L. website at www.ul.com

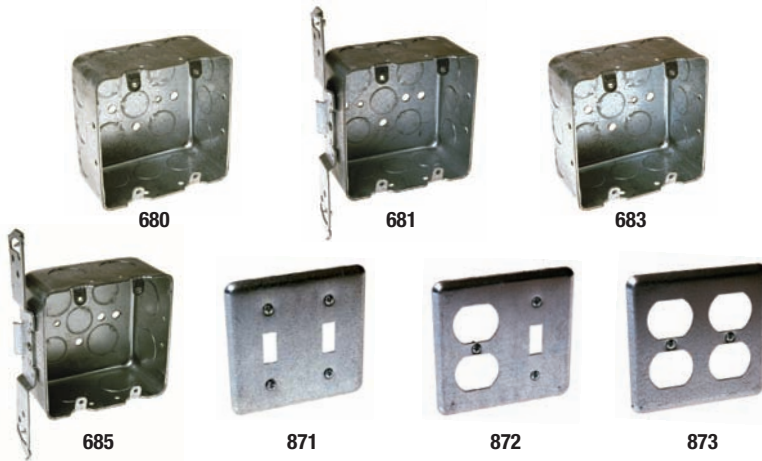

RACO STEEL BOXES & COVERS

ORDERING INFORMATION - DIMENSIONS

4" SQUARE TWO DEVICE SWITCH BOX – 2-1/8" DEEP – DRAWN WITH CONDUIT KO'S – 30.3 CUBIC INCHES					
CATALOG NUMBER	DESCRIPTION BRACKET & SETBACK	KNOCKOUTS		STD. PKG.	UPC BAR CODE
		SIDES	BOTTOM		
680	—	12-1/2"	5-1/2"	25	
681	TS brkt., 1/2"	9-1/2"	5-1/2"	25	
683	—	8-1/2", 4-3/4"	3-1/2", 2-3/4"	25	
685	TS brkt., 1/2"	6-3/4"	3-1/2", 2-3/4"	25	

4" SQUARE – TWO-DEVICE WALL PLATES*			
CATALOG NUMBER	DESCRIPTION	STD. PKG.	UPC BAR CODE
871	2 Toggle switches	25	
872	1 Dup. & 1 Toggle switch	25	
873	2 Duplex receptacles	25	

*Cover face surface is 1/4" from wall when installed

DIMENSIONS					
CATALOG NUMBER	A	B	C	D	E
680	2-1/8"	4"	4"	—	—
681	2-1/8"	4"	4"	7"	4-9/32"
683	2-1/8"	4"	4"	—	—
685	2-1/8"	4"	4"	7"	4-9/32"

4714, THE INSIDER® will secure nonmetallic sheathed cable in 1/2" KO (See pg. B87)



A48

SWITCH BOXES AND PARTITIONS

MULTI-GANG - 2-1/2" DEEP

RACO STEEL BOXES & COVERS

Applications

- Installers can save time and cut installation costs with multi-gang switch boxes
- These larger capacity boxes are ideal for today's designs where there is a need to install more than two devices at one location

Product Features

- Reference Box Selection section in the front of this catalog for complete description of bracket types and features



MULTI-GANG SWITCH BOXES

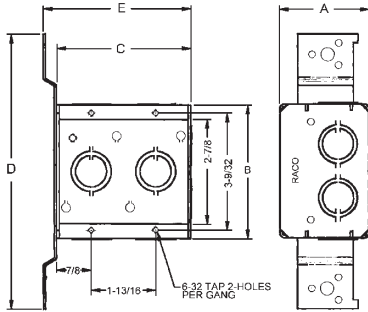

Compliance

- – File E195978 (Cat. #971 not UL Listed)

ORDERING INFORMATION - DIMENSIONS

MULTI-DEVICE SWITCH BOXES – 2-1/2" DEEP – WELDED WITH CONDUIT KO'S							
CATALOG NUMBER	DESCRIPTION BRACKET & SETBACK	KNOCKOUTS			CU. IN. CAP.	STD. PKG.	UPC BAR CODE
		ENDS	SIDES	BOTTOM			
686	3-Gang 1/2" setback	2-1/2", 2-3/4"	6-1/2", 6-3/4"	3-1/2", 3-3/4"	47.8	10	
687	4-Gang 1/2" setback	2-1/2", 2-3/4"	8-1/2", 8-3/4"	4-1/2", 4-3/4"	63.5	10	
971	Low voltage partition	—	—	—	—	25	—

DIMENSIONS					
CATALOG NUMBER	A	B	C	D	E
686	2-1/2"	3-3/4"	5-9/16"	7-5/8"	5-31/32"
687	2-1/2"	3-3/4"	7-3/8"	7-5/8"	7-25/32"

4714, THE INSIDER® will secure nonmetallic sheathed cable in 1/2" KO (See pg. B87)

