

IN-LINE CHECK VALVES

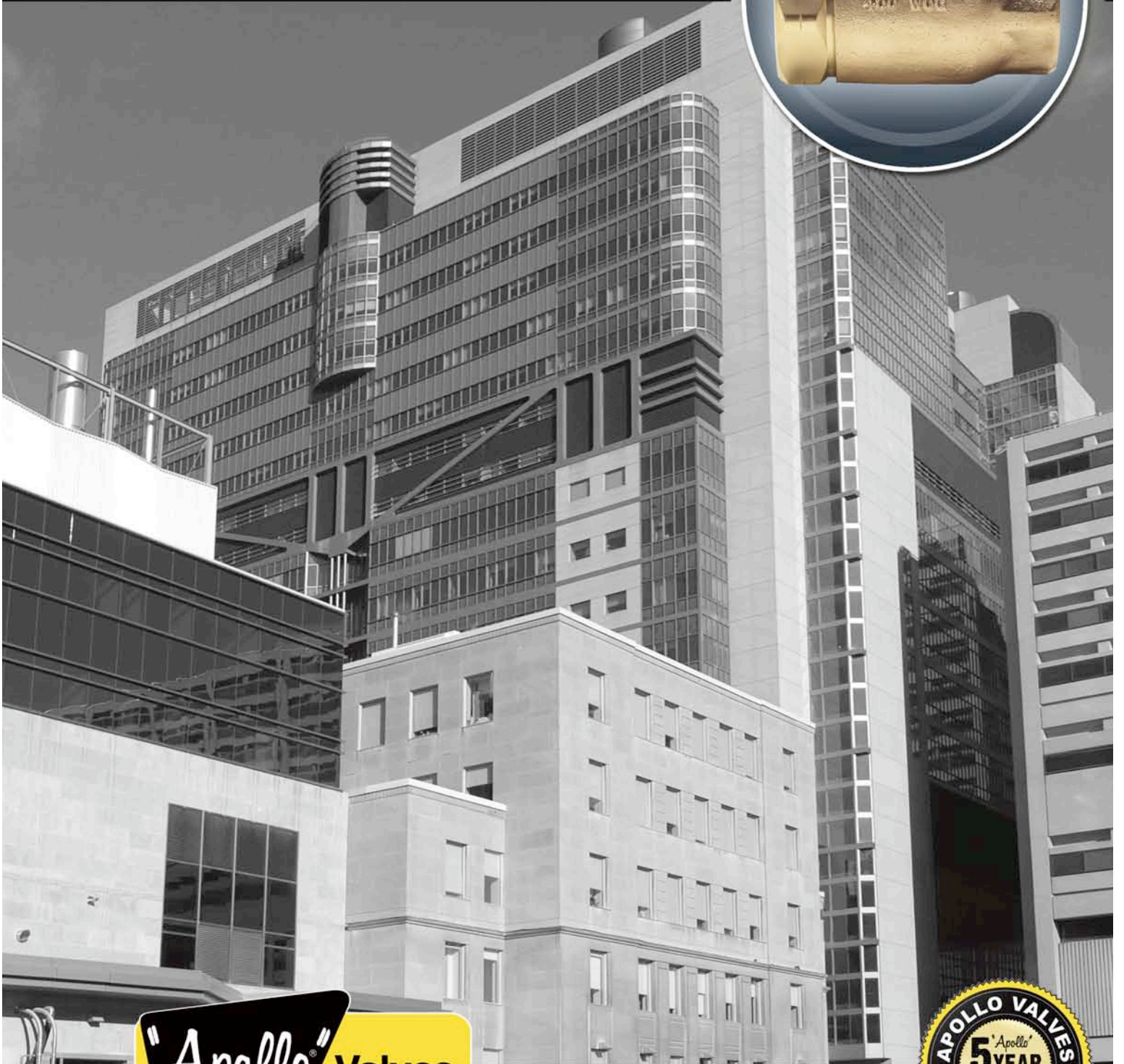

"Apollo" Valves
manufactured in the USA
by CONBRACO Industries



In-Line Check Valves

TABLE OF CONTENTS

Protection Against Reverse Flow	3
61-100 Series	4
61-200 Series	4
Check Valve Numbering System	5
62-100 Series	5
61-500 / 61-600	6
62-500 Series	7
61-700 Mini Check Valves	8
70-100-BC Series	8
Repair Kits Available	9

Warranty and Limitations of Liability

Conbraco Industries, Inc. warrants, to its initial purchaser only, that its products which are delivered to this initial purchaser will be of the kind described in the order or price list and will be free of defects in workmanship or material for a period of two years from the date of delivery to you, our initial purchaser.

Should any failure to conform to this warranty appear within one year after the date of the initial delivery to our initial purchaser, Conbraco will, upon written notification thereof and substantiation that the goods have been stored, installed, maintained and operated in accordance with Conbraco's recommendations and standard industry practice, correct such defects by suitable repair or replacement at Conbraco's own expense.

New For April 2009: Extension of Warranty for Apollo products manufactured in the USA. Conbraco warrants those products that are manufactured in our USA facilities for an additional 3 years; making the total warranty FIVE years. This extended warranty applies to Apollo brand product with "Made in the USA" markings only.
New For April 2009: Extension of Warranty for Apollo products manufactured in the USA. Conbraco warrants those products that are manufactured in our USA facilities for an additional 3 years; making the total warranty FIVE years. This extended warranty applies to Apollo brand product with "Made in the USA" markings only.

THIS WARRANTY IS EXCLUSIVE AND IS IN LIEU OF ANY IMPLIED WARRANTY OF MERCHANTABILITY, FITNESS FOR A PARTICULAR PURPOSE OR OTHER WARRANTY, WHETHER EXPRESS OR IMPLIED, EXCEPT THE WARRANTY OF TITLE AND AGAINST PATENT INFRINGEMENT. Correction of non-conformities, in the manner and for the period of time provided above, shall constitute fulfillment of all liabilities of Conbraco to our initial purchaser, with respect to the goods, whether based on contract, negligence, strict tort or otherwise. It is the intention of Conbraco Industries, Inc. that no warranty of any kind, whether express or implied shall pass through our initial purchaser to any other person or corporation.

LIMITATION OF LIABILITY: Conbraco Industries, Inc. SHALL NOT UNDER ANY CIRCUMSTANCES BE LIABLE FOR SPECIAL OR CONSEQUENTIAL DAMAGES SUCH AS, BUT NOT LIMITED TO, DAMAGE TO LOSS OF OTHER PROPERTY OR EQUIPMENT, LOSS OF PROFITS OR REVENUE, COST OF CAPITAL, COST OF PURCHASED OR REPLACEMENT GOODS, OR CLAIMS OF CUSTOMERS OF OUR INITIAL PURCHASER. THE REMEDIES OF OUR INITIAL PURCHASER, AND ALL OTHERS, SET FORTH HEREIN, ARE EXCLUSIVE, AND THE LIABILITY OF CONBRACO WITH RESPECT TO SAME SHALL NOT, EXCEPT AS EXPRESSLY PROVIDED HEREIN, EXCEED THE PRICE OF THE CONBRACO GOODS UPON WHICH SUCH LIABILITY IS BASED.



Throughout this catalog, products that have a Lead Free¹ option will be identified with this logo and the following statement applies:

¹LEAD FREE: The wetted surfaces of these products shall contain no more than 0.25% lead by weighted average. Complies with CA AB 1953 and VT S.152. ANSI 3rd party certified & listed.

Spring Loaded Check Valves Extend System Life

In any liquid or gas system where reverse flow cannot be tolerated, a quick-responding check valve is a necessity. Check valves that close slowly permit flow reversal to occur in the line which can cause severe mechanical shock. As the valve finally seats, high peak pressure pulses and shock waves are generated on the downstream side due to the media being forced to a sudden stop. Upstream, the momentum is not restricted which can create voids in the flow, filling with air or vapor to cause additional, lower frequency shock waves.

These shock waves added together are known as water hammer. It can cause extensive damage or failure to pipelines, gaskets, supports, hardware and equipment. The result can be expensive, troublesome, even dangerous.

With Apollo's spring loaded 61 and 62 Series check valves, the potential for water hammer is greatly reduced since the check returns to its seat before flow velocity reaches zero.

Apollo's in-line check valves set the standard for compact, economical protection against reverse flow. They provide reliable service in liquids or gases at various temperature and pressure combinations.

Apollo check valves are rated 400 psig CWP, cold non-shock. Their straight-through configuration minimizes changes in flow velocity.

Because of their simple design, they're versatile and easy to maintain.

Choose Bronze Or Stainless Steel

Series 61 check valves feature bronze body construction and are available in sizes 1/4" to 3" for use with water, steam, oil, air and inert gases.

Series 62 model in stainless steel with investment cast body are sized from 1/4" to 2" for use in more severe applications and corrosive environments.

Both come equipped with 316 stainless steel springs. All wetted parts are bronze/brass (61 Series) or stainless steel (62 Series).

Spring Assisted Closing

Apollo's 61 and 62 Series feature short check travel and spring assisted closing. This ensures the valve closes quickly, before reversal of flow, helping to eliminate water hammer, its associated noise, and damage to piping and machinery.

Low Cracking Pressure

Apollo's standard 61 and 62 Series checks operate at low cracking pressures. An extra-light-spring version of the valve is available as an option. A 5-pound or 10-pound cracking pressure spring is also available on models through 1".

**Protection
Against Reverse
Flow**

Broad Range of Applications

Apollo 61 and 62 Series in-line check valves are at home in applications from residential boilers to tough process systems, including:

- Evaporators
- Water Lines
- Cookers
- Steam Tracer Lines
- Rubber/Plastic Presses
- Sterilizers
- Metering Pumps
- Condensate Return Lines
- Boiler Feed
- Steam Lines
- Chiller Systems
- Salt Water Injection
- Autoclaves
- Air and Gas Lines
- Casing Vents
- Chemical Lines

Industries where Apollo's in-line check valves are used include Pulp & Paper, Chemical Processing, Agrichemical, Rubber, Petroleum, Primary Metals, Mining, Power Generation, Textiles, Food and Beverage, Building Construction and Maintenance.

Tight... Or Bubble Tight

Patented Conbraco Ball Cone® check valves (61-100, 61-200 and 62-100) feature a tight-sealing RPTFE ball-shaped check which seats against the conical interior face of the valve's metal retainer. This simple design provides exceptional resistance to wear and corrosion. Seat tightness to MSS-SP80. (Liquids: 10 ml/hr/inch, Gasses: 1 ml SCF/hr/inch).

But where even tighter sealing is required, choose the 61-500 or 61-600, featuring EPDM (elastomer) seat or 62-500, featuring a Fluorocarbon (Viton®) seat, for a bubble-tight seal. A Buna-N seat is optional.

Use In Any Position

Horizontal, vertical or upside down, Conbraco's in-line checks operate in any orientation, though vertical orientation with upward flow is best where frequent opening and closing cycles occur. This saves you time and money, eliminating the need to stock separate vertical and horizontal-operating valves. It also makes new or replacement installation less of a headache.

Quality Built In America

All Apollo check valves are produced in the U.S. at ISO 9001 registered manufacturing facilities to assure integrity of design and the highest level of performance.

This brochure should provide you with all the information necessary to help you select the right Apollo in-line check valve for your application. However, if you need more information, the name of your nearest Apollo distributor or would like to place an order, please contact: Conbraco Industries, Inc. Customer Service, Phone: (704) 841-6000; Fax: (704) 841-6020.

Ball Cone Check Valves

61 Series Bronze Ball Cone® Check Valves



61-100
Female x Female Threaded
1/4" through 3"



61-200
Male x Female Threaded
1/4" through 2"

Well-suited for a broad range of applications, including 125 psig saturated steam. The rugged bronze body and RPTFE ball check provide reliable, protection against reverse flow.

Patented design (U.S. Pat. No. 4,172,465) with reinforced RPTFE ball-cone check and stainless steel springs, these valves offer reliable protection against reverse flow and exceptional resistance to chemicals and corrosion. No radial alignment is needed.

FEATURES

- 1/2" psi opening pressure
- Bronze sizes from 1/4"-3"(Female x Female) 1/4"-2" (Male x Female)
- Tight shut-off with liquid media
- 400 psig CWP
- 125 psig steam rating @350°F max
- Straight-through design minimizes velocity changes
- ASTM B584 Bronze
- American-made construction
- Numerous options are available
- Optional CE/PED (Pressure Equipment Directive) compliance
- Lead Free Option¹



Materials of Construction

1	Body	Bronze - ASTM B584, UNS Alloy C84400
2	Retainer	Brass - ASTM B16, (1/4" - 1") Bronze - ASTM B584, (1 1/4" - 3")
3	Ball Check	RPTFE - Reinforced Teflon(tm)
4	Guide	Brass - ASTM B16
5	Spring	Steel - AISI 316 Stainless Steel

Pressure Temperature Ratings

Degree (F)	PSIG
-20 to 100	400
200	200
250	160
275	150
300	140
325	130
353	125

Flow Rate (C_v)

Size	GPM
1/4"	0.85
3/8"	1.21
1/2"	1.4
3/4"	3.53
1"	6
1-1/4"	44
1-1/2"	65
2"	81
2-1/2"	175
3"	265

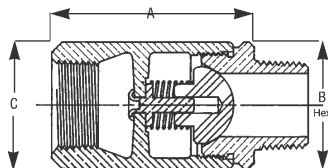
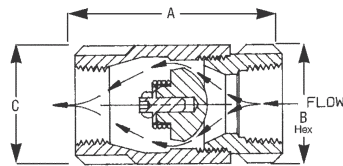

Bronze FNPT x FNPT	Bronze MNPT x FNPT	Size	Dimensions (in.)			61 Series Wt./100	62 Series Wt./100
			A	B	C		
61-101-01	61-201-01	1/4	2.06	1.12	1.12	38.0	38.3
61-102-01	61-202-01	3/8	2.12	1.12	1.12	38.0	37.3
61-103-01	61-203-01	1/2	2.31	1.12	1.12	38.0	36.3
61-104-01	61-204-01	3/4	2.87	1.37	1.50	75.0	76.6
61-105-01	61-205-01	1	3.50	1.75	1.93	145.0	145.0
61-106-01	61-206-01	1 1/4	4.18	2.12	2.37	275.0	237.5
61-107-01	61-207-01	1 1/2	4.93	2.50	2.81	394.0	381.3
61-108-01	61-208-01	2	6.00	3.00	3.68	630.0	636.0
61-109-01	-	2 1/2	7.00	3.50	4.50	1400.0	-
61-100-01	-	3	8.12	4.12	5.31	1665.0	-

Precautionary Note

Not recommended for use with reciprocating pumps and similar applications which may induce repetitious vibrations. Low flow rates which do not fully open the valve, may result in undesirable noise and premature valve failure. Upstream flow disturbances, which create turbulence, may also result in rapid wear. Therefore, it is recommended that a minimum of 10 diameters of straight pipe be provided between the check valve and any upstream flow disturbances such as pumps, control valves, elbows, etc.

Ball Cone Check Valves

The 62-100 Series is uniquely suited for applications in corrosive environments, including chemical processing, pulp and paper and other process industries. The rugged stainless steel body and RPTFE ball check provide reliable, patented protection against reverse flow.

Features

Unique (U.S. Patent # 4,172,465) design provides tight shutoff in reverse flow conditions. The body of the valve is investment cast stainless steel for longer life in severe environments. It is spring-loaded for fast seating action and center guided so that radial alignment is never needed. Straight-through flow minimizes velocity change. It is rated 400 psig CWP, cold non-shock; 125 psig saturated steam. Tight to MSS.SP80

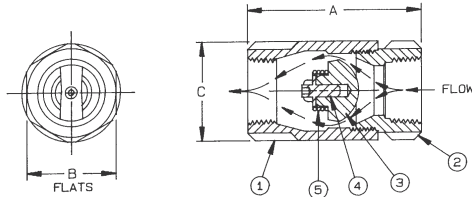

62 Series Stainless Steel Ball Cone® Check Valves



62-100
Female x Female Threaded
1/4" through 2"

Materials of Construction

1	Body	Stainless Steel - ASTM A351, CF8M
2	Retainer	Stainless Steel - ASTM A276, 316 (1/4"-1") Stainless Steel - ASTM A351,CF8M (11/4"-2")
3	Ball Check	RPTFE - Reinforced Teflon(tm)
4	Guide	Stainless Steel - ASTM A276, 316
5	Spring	Steel - AISI 316 Stainless Steel

Dimensional Specifications

Number	Size	A	B	C	Wt./100
62-101-01	1/4"	2.06	1.12	1.12	38
62-102-01	3/8"	2.12	1.12	1.12	38
62-103-01	1/2"	2.31	1.12	1.12	38
62-104-01	3/4"	2.87	1.37	1.50	75
62-105-01	1"	3.50	1.75	1.93	145
62-106-01	1 1/4"	4.18	2.12	2.37	237
62-107-01	1 1/2"	4.93	2.50	2.81	381
62-108-01	2"	6.00	3.00	3.68	636

Pressure Temperature Ratings

Degree (F)	PSIG
-20 to 100	400
200	200
250	160
275	150
300	140
325	130
353	125

Flow Rate (C_v)

Size	GPM
1/4"	0.85
3/8"	1.21
1/2"	1.4
3/4"	3.53
1"	6
1-1/4"	44
1-1/2"	65
2"	81
2-1/2"	175
3"	265

Check Valve Part Numbering System

6 X - X X X - X X

TYPE	CHECK	SPRING TYPE	SIZE	OPTIONS
1-Brass	1-Ball Cone (NPT-F x F)	0-5 psig Cracking Pressure	1-1/4"	01 - Standard
2-Stainless Steel	2-Ball Cone (NPT-M x F)	2-2 psig Cracking Pressure	2-3/8"	011 - International 1/2 BSP
	0-Ball Cone Repair Kit		3-1/2"	17 - Satin Chrome Plated
			4-3/4"	21 - BSPP Thread
			5-1"	57 - Oxygen Cleaned
			6-1-1/4"	A1 - Less Spring
			7-1-1/2"	A8 - No Pipe Thread
			8-2"	Retainer End
			9-2-1/2"	E05 - 5 psig Opening Pressure*
			0-3"	E10 - 10 psig Opening Pressure*

*Available in 1/4" through 1" Only.
(Note: Not all combinations are available.
Contact Customer Service for verification.)

Soft Seated Check Valves

61-500 / 61-600 Series Bronze Check Valves



61-500
Female x Female Threaded
1/4" through 2"



61-600
Female x Female Sweat
1/2" through 2"

Ideally suited for hydronic heating and other low flow applications, since seat disc and EPDM soft seat are less prone to vibration. The rugged bronze body and check provide reliable protection against reverse flow.

Features

The 61-500/61-600 features an EPM soft seat for bubble tight shutoff, reduced noise and less vibration. It is spring-loaded for fast seating action and center guided so that radial alignment is never needed. Straight-through flow minimizes velocity change. The spring is fully protected from the flow stream, helping extend life of the valve. A light spring is available as an option. It is rated 400 psig CWP, cold non-shock; Maximum Temperature 250°F.

NEW! 61LF-500 Lead Free option¹ now available in select sizes.

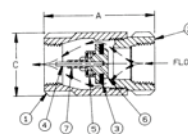
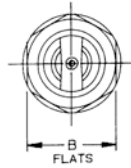

61-500

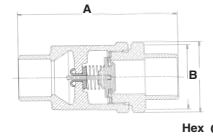

61-600

Materials of Construction

1	Body	Bronze - ASTM B584, UNS Alloy C84400
2	Retainer	Brass - ASTM B16 (1/4" - 1")
3	Seat	EPDM
4	Guide Pin	Steel - AISI 420 Stainless Steel
5	Spring	Steel - AISI 316 Stainless Steel
6	Check	Brass - ASTM B16
7	Guide	Brass - ASTM B16

61-500 Dimensional Specifications

Number	Size (in.)	A	B	C	Wt./100
61-501-01	1/4	2.31	1.12	1.12	38
61-502-01*	3/8	2.31	1.12	1.12	38
61-503-01*	1/2	2.31	1.12	1.12	38
61-504-01*	3/4	2.87	1.37	1.50	75
61-505-01	1	3.50	1.75	1.93	145
61-506-01	1-1/4	4.18	2.12	2.37	275
61-507-01	1-1/2	4.93	2.50	2.81	394
61-508-01	2	6.00	3.00	3.68	630

* 61LF-500 Lead Free Option¹ Available

61-600 Dimensional Specifications

Number	Size (in.)	A	B	C	Wt./100
61-603-01	1/2	2.75	1.12	1.25	38
61-604-01	3/4	3.68	1.50	1.62	75
61-605-01	1	4.50	1.93	2.12	145
61-606-01	1-1/4	6.11	2.13	2.38	330
61-607-01	1-1/2	6.87	2.50	2.81	610
61-608-01	2	7.46	3.38	3.75	1010

Flow Rate (C_v)
GPM=gallons per minute
all at 1 psi pressure differential

61-500		61-600	
Size	GPM	Size	GPM
1/4"	0.47	1/2"	2.20
3/8"	1.57	3/4"	4.78
1/2"	2.2	1"	6
3/4"	4.78	1-1/4"	44
1"	6	1-1/2"	65
1-1/4"	44	2"	81
1-1/2"	65		
2"	81		

EPDM Seat

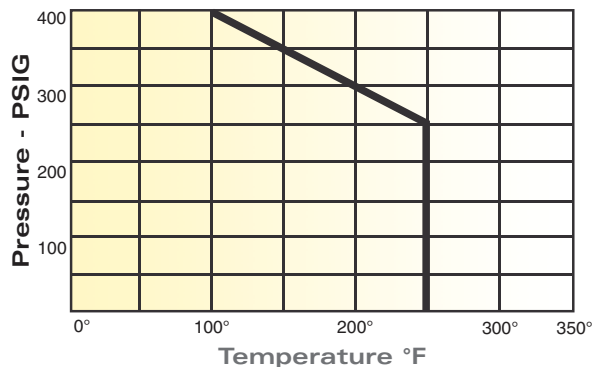

Soft Seated Check Valves

Perfect for lower flow applications in tough industrial environments, since seat disc and soft seat are less prone to vibration. The stainless steel body and check provide lasting protection against reverse flow.

The 62-500 features a Fluorocarbon (Viton®) soft seat for bubble tight shutoff, reduced noise and vibration. It is spring-loaded for fast seating action and center guided so that radial alignment is never needed. Straight-through flow minimizes velocity change. The spring is fully protected from the flow stream, helping extend the life of the valve. A light spring is available as an option. The 62-500 is rated 400 psig CWP, cold non-shock; Maximum Temperature 350°F.

FEATURES

- Female NPT sizes: 1/4" to 1"
- Bubble-tight shut-off, ideally suited for gaseous service
- NPT threaded; 400 psig CWP non-shock
- EPDM check disc
- SS check features Viton® check disc
- Straight-through design minimizes velocity changes
- Approximate opening pressure 1/2 psi
- Approximate opening pressure 1/2 psi
- Numerous options available
- RoHS Compliant

62-500 Series Stainless Steel Check Valves



62-500
Female x Female Threaded
1/4" through 1"

Materials of Construction

1 Body	Stainless Steel - ASTM A351,CF8M
2 Retainer	Stainless Steel - ASTM A276, 316
3 Seat	Fluorocarbon Rubber-Viton®
4 Spring	Stainless Steel - AISI 316
5 Check	Stainless Steel - ASTM A276, 316

Check Valve Part Numbering System

6 X - X X X - X X

TYPE	CHECK	SPRING TYPE	SIZE	OPTIONS
1-Brass	5-Soft Seat (NPT-F x F)	0-.5 psig Cracking Pressure	1-1/4"	01 - Standard
2-Stainless Steel	6-Soft Seat (Sweat F x F)	2-.2 psig Cracking Pressure	2-3/8"	01I - International 1/2 BSP
	9-Soft Seat Repair Kit (EPR only)		3-1/2"	17 - Satin Chrome Plated
	0-Ball Cone Repair Kit		4-3/4"	21 - BSPP Thread
			5-1"	57 - Oxygen Cleaned
				A1 - Less Spring
				A8 - No Pipe Thread Retainer End
				B1 - Nitrile Seat (Soft Seat Only)
				E05 - 5 psig Opening Pressure*
				E10 - 10 psig Opening Pressure*

*Available in 1/4" through 1" Only.
(Note: Not all combinations are available.
Contact Customer Service for verification.)

Flow Rate (C _v)	
GPM=gallons per minute all at 1 psi pressure differential	
Size	GPM
1/4"	0.47
3/8"	1.57
1/2"	2.20
3/4"	4.78
1	6.00

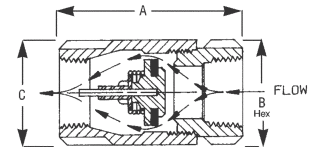
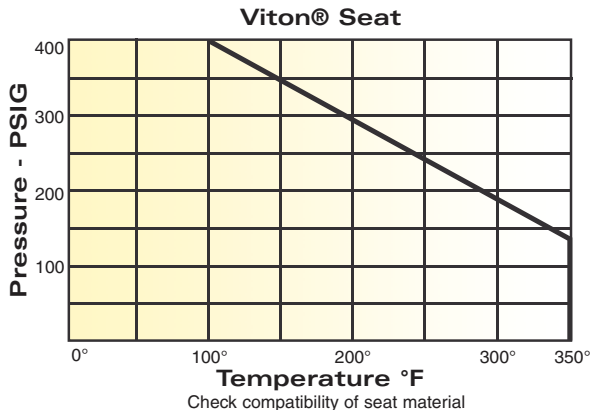

SS FNPT x FNPT	Size(in.)	Dimensions (in.)			Wt./100
		A	B	C	
62-501-01	1/4	2.312	1.125	1.125	38
62-502-01	3/8	2.312	1.125	1.125	38
62-503-01	1/2	2.312	1.125	1.125	38
62-504-01	3/4	2.875	1.375	1.500	75
62-505-01	1	3.500	1.750	1.937	150

Precautionary Note

Not recommended for use with reciprocating pumps and similar applications which may induce repetitious vibrations. Low flow rates which do not fully open the valve may result in undesirable noise and premature valve failure. Upstream flow disturbances, which create turbulence, may also result in rapid wear. Therefore, it is recommended that a minimum of 10 diameters of straight pipe be provided between the check valve and any upstream flow disturbances such as pumps, control valves, elbows, etc.

In-Line Check Valves

61-700 Series Mini Check Valves & 70-100-BC Unidirectional Ball Valves



61-700
Female x Female Threaded
1/4" through 1"

Ideally suited for cold water, air, and some non-hazardous gases and oils. Check compatibility with intended usage. The 61-700 operates on horizontal or vertical flow (up) installation. It is spring-loaded for fast seating action. It does not generate hammering and has been air tested for leakage. It is rated at 230 PSIG with a maximum temperature of 200°F.

Features

- 0.5 psi cracking pressure
- MSS-SP80 compliant
- Acetyl silicone check with: Silicone rubber seat (1/4 & 3/8) Nitrile seat (1/2-1)

Flow Rate (C _v)	
GPM=gallons per minute	
all at 1 psi pressure differential	
Size	GPM
1/4"	0.78
3/8"	1.81
1/2"	5.13
3/4"	10.51
1	14.25

Materials of Construction

1	Body	Brass, ASTM B16
2	Check Assembly	Acetal/Brass/Silicone/Buna-N
3	Spring	Stainless Steel 302

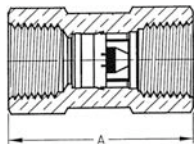
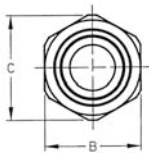

Dimensional Specifications

Number	Size (in.)	A	B	C	Wt./100
61-701-01	1/4	1.72	0.81	0.92	22
61-702-01	3/8	1.79	0.93	1.05	29
61-703-01	1/2	2.02	1.06	1.17	38
61-704-01	3/4	2.50	1.25	1.40	54
61-705-01	1	2.95	1.62	1.76	110



70-100-BC
Female x Female Threaded
1/2" through 2"

The 70-100-BC Series ball valve combines two functions in a single design: positive shut-off and bubble-tight check capabilities. The BC Series is a unidirectional version of the industry-standard Apollo 70 Series ball valve. An easy flow design and superior check valve make these valves a smart choice for water or air in OEM applications or mechanical systems.

Features

Blowout-proof stems. RPTFE seats and stuffing box ring. Adjustable packing gland. Chromium-plated ball. Positive shut-off and bubble-tight check capability.

Materials of Construction

1	Body	B584-C84400
2	Retainer	B16 (1/2"-1") B584-C84400 (1-1/4"-2")
3	Ball	B16 Chrome Plated
4	Check Valve Insert	Acetal
5	Stem	B16
6	Gland Nut	B16
7	Lever and Grip	Steel, Zinc-plated w/vinyl
8	Lever Nut	Steel, Zinc-plated
9	O-Ring	Buna-N
10	Seat (2)	Reinforced TFE
11	Body Seal	TFE (1-1/4" - 2")
12	Stem Packing	Reinforced TFE
13	Stem Bearing	Reinforced TFE
14	Seal	EPDM (1/2")
15	Retaining Ring	Spring Steel (1/2")

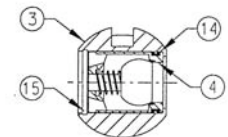
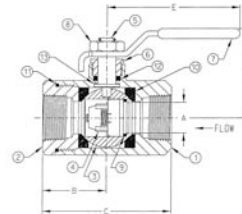

Dimensional Specifications

Number	Size	A	B	C	D	E	Wt./100
70-103-BC	1/2"	0.50	1.12	2.25	1.80	3.87	0.63
70-104-BC	3/4"	0.68	4.50	3.00	2.12	4.87	1.33
70-105-BC	1"	0.87	1.68	3.37	2.25	4.87	1.77
70-106-BC	1 1/4"	1.00	2.00	4.00	2.73	5.50	3.29
70-107-BC	1 1/2"	1.25	2.18	4.37	3.09	8.00	4.63
70-108-BC	2"	1.50	2.34	4.68	3.28	8.00	6.01

RTFE Seats

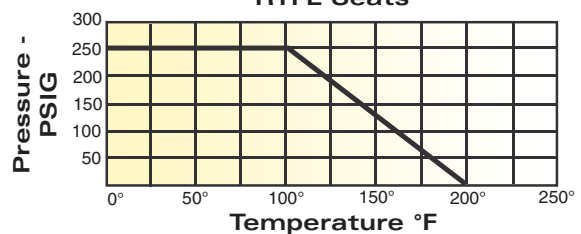

In-Line Check Valves

Repair Kits

61-100 Repair Kits

Repair Kit Part Number	Size (in.)	Check Valve Part Number
61-001-01	1/4	61-101-01
61-002-01	3/8	61-102-01
61-003-01	1/2	61-103-01
61-004-01	3/4	61-104-01
61-005-01	1	61-105-01
61-006-01	1-1/4	61-106-01
61-007-01	1-1/2	61-107-01
61-008-01	2	61-108-01
61-009-01	2-1/2	61-109-01
61-010-01	3	61-100-01



61-600 Repair Kits

Repair Kit Part Number	Size (in.)	Check Valve Part Number
61-903-01	1/2	61-603-01
61-904-01	3/4	61-604-01
61-905-01	1	61-605-01
61-906-01	1-1/4	61-606-01
61-907-01	1-1/2	61-607-01
61-908-01	2	61-608-01

61-200 Repair Kits

Repair Kit Part Number	Size (in.)	Check Valve Part Number
61-001-01	1/4	61-201-01
61-002-01	3/8	61-202-01
61-003-01	1/2	61-203-01
61-004-01	3/4	61-204-01
61-005-01	1	61-205-01
61-006-01	1-1/4	61-206-01
61-007-01	1-1/2	61-207-01
61-008-01	2	61-208-01

62-100 Repair Kits

Repair Kit Part Number	Size (in.)	Check Valve Part Number
62-001-01	1/4	62-101-01
62-002-01	3/8	62-102-01
62-003-01	1/2	62-103-01
62-004-01	3/4	62-104-01
62-005-01	1	62-105-01
62-006-01	1-1/4	62-106-01
62-007-01	1-1/2	62-107-01
62-008-01	2	62-108-01

61-500 Repair Kits

Repair Kit Part Number	Size	Check Valve Part Number
61-901-01	1/4	61-501-01
61-902-01	3/8	61-502-01
61-903-01	1/2	61-503-01
61-904-01	3/4	61-504-01
61-905-01	1	61-505-01
61-906-01	1-1/4	61-506-01
61-907-01	1-1/2	61-507-01
61-908-01	2	61-508-01

62-500 Repair Kits

Repair Kit Part Number	Size (in.)	Check Valve Part Number
62-901-01	1/4	62-501-01
62-902-01	3/8	62-502-01
62-903-01	1/2	62-503-01
62-904-01	3/4	62-504-01
62-905-01	1	62-505-01



Sales and Customer Service

Phone: (704) 841-6000

Fax: (704) 841-6020

www.apollovalves.com

			E-Mail Address	Phone	Fax
Southeast Region	Spirit Group	Florida (except Pan Handle)	info@spiritgroupinc.com	407-291-6035	407-299-0378
	Spotswood Associates	Georgia/Alabama	dlewis@spotswoodassociates.com	770-447-1227	770-263-6899
	Pro Marketing, Inc.	North Carolina/South Carolina/Tennessee-East	sales@promarketinginc.net	864-578-4334	864-578-4889
	Mid South Marketing, Inc.	Virginia/Maryland/Washington, D.C./WV-East	midsouth7@aol.com	804-213-3801	804-213-3802
Southern Region	Southern Marketing Group	MS/TN-West/AR/Bowie Cty.-TX	SMG49@bellsouth.net	901-547-0042	901-547-0035
	AVC Mechanical Sales, Inc.	Oklahoma (Plmb & Ind'l)/Texas-North (All)	valvesales@avale.com	214-201-0100	214-201-0104
	Armstrong/Weatherly Associates	Texas-South/Louisiana	sales@armstrong-weatherly.com	713-692-5566	713-692-6021
	Lightsey Marketing	Oklahoma (Irrigation, Fire Protection, Water Works)	karenandmarilyn@yahoo.com	918-251-2828	918-251-7742
Midwestern Region	New Tech Marketing	IL/WI-East/IN-North/MI-Upper Peninsula/IA-River Counties	sales@new-techmarketing.com	630-378-4300	630-378-0343
	New Tech Marketing	Eastern Missouri/Southern Illinois/Kansas City	ntm112@aol.com	618-394-0329	618-394-0427
	Whitfill-McCarthy, LLC	Kentucky/Indiana-South/Ohio-South	whitfill@win.net	502-459-4545	502-459-9944
	V.E. Sales Co., Inc.	Michigan (Except Upper Peninsula)	tomv@vesalesinc.com	586-774-7760	586-774-1490
	Formation Sales	Minnesota/North & South Dakota/Wisconsin-West	dean@formationsales.com	763-262-4700	763-262-4740
	Marshall-Rodeno Heartland	Nebraska/Iowa (Except River Counties)	trodeno@marshallrodeno.com	303-575-6701	303-575-6706
	Midwest Spec	Ohio-North/Pennsylvania-West/West Virginia-West	glsales@mwspec.com	330-538-0406	330-538-0410
Western Region	Warren Thoma Associates	MI/WI/IL/IN/KY/OH (Irrigation Only)	pennyt@thomaassociates.com	815-477-1814	815-477-2009
	Spec Management Group	California-South (Irrigation), Hawaii (All Products)	msmarch4@cox.net	949-481-4225	949-487-0990
	Specified Process Equipment Co.	California - North	jd@specifiedprocess.com	707-747-3466	707-747-4957
	Marshall-Rodeno Associated	CO/WY/MT/ID-SE/UT/NV-NE/NM/EI Paso-TX	trodeno@marshallrodeno.com	303-575-6701	303-575-6706
	Suntoya Corporation	WA, OR, AK, Northern counties ID	kim@suntoya.com	509-534-1516	509-535-6546
	Southwestern Industrial Sales Co.	Arizona/Nevada-SW	eduardop@sw-ind.com	480-458-5838	480-458-5843
	Jack Prust Sales	California-North (Irrigation)	jack@jpsales.com	530-878-2922	530-878-2341
	Active Sales Northwest, Inc	Oregon, WA, Western Idaho (Irrigation)	skactive@aol.com	541-726-0320	541-726-1148
	Southwest Valve LLC	California (Waterworks and Fire Protection)	d.burrell@southwestvalve.com	559-261-2703	559-261-2711
	Northeast Region	Urell, Inc.	Massachusetts/New England States	conbraco@urell.com	617-923-9500
Conroy & Griese Sales, Inc.		New York-East/New Jersey-North	iezzi52@aol.com	856-663-4440	856-663-6644
Layden Company		PA-East/DE/NJ-South/NY-Upstate & West	joejr@laydencompany.com	610-363-6657	877-529-3361
Keith Engle & Associates		OEM accounts	keith.engle@verizon.net	610-827-9560	610-827-9561
Waterlines, Inc.		New England/Upstate, Metro NY/PA/VA (Irrigation Only)	waterlines@nac.net	973-209-7777	973-209-7421
Canada	Conbraco Industries, Canada	178 Pennsylvania Ave., Unit 1, Concord, Ontario L4K 4B1	conbraco.canada@conbraco.com	905-761-6161	905-761-6666
	Barclay Sales Ltd.	British Columbia	bbarclay@barclaysales.com	604-945-1010	604-945-3030
	D & M Mechanical Sales	Ontario/East	don@dandmsales.ca	613-384-7084	613-384-3407
	Dynamic Agencies, Ltd.	Saskatchewan	doug.dynamicage@sasktel.net	306-343-1901	306-343-1901
	Tom Beggs Agencies Ltd.	Manitoba/NW Ontario	tba@mts.net	204-953-1900	204-774-6915
	Task Controls, Inc.	Ontario	infotoronto@taskcontrols.com	416-291-3004	416-754-3481
	Agences J. Pierre Sylvain, Inc.	Quebec	agencespsylvain@golden.net	450-655-9588	450-641-2737
	Kern Industries, Ltd.	Alberta-North	kernind@telusplanet.net	780-451-2056	780-454-6687
	Kern Industries Calgary, Ltd.	Alberta-South	marty.yucytus@kernindustries.ca	403-730-7791	403-239-8179
	J. Levandier Sales, Inc.	Nova Scotia, New Brunswick, Prince Edward Island and Newfoundland	jlsales@istar.ca	506-858-1615	506-858-1084
Int'l.	Key to the North Sales Agency, Inc.	Ontario-North	hmehes@keytothenorth.ca	705-524-6714	705-566-0148
	Sadek Trading	Middle East (except Israel)	ysadek@aol.com	704-618-6613	980-233-8437
	Conbraco International Sales:	Mexico	jose.arias@conbraco.com	956-631-4542	956-631-4681
		Caribbean	luis.guzman@conbraco.com	787-739-5620	
		Central & South America	esteban.bejarano@conbraco.com	506-8836-0759	
		Asia Pacific	jonathan.yap@conbraco.com	65-9626-9241	65-6753-0131
		Europe	allen.bellamy@conbraco.com	44-161-212-3745	44-161-212-3747
		Africa/Australia/Israel/India	donna.bult@conbraco.com	954-252-9781	954-252-8698
		Regional Sales Managers:			
		Brian Blalock (East)	brian.blalock@conbraco.com	704-624-3744	704-841-6021
	Steve Brown (Northwest)	steve.brown@conbraco.com	425-985-5095	253-862-3548	
	Skip Wilson (West)	skip.wilson@conbraco.com	760-330-3293	775-854-5722	