



40403



40413



40411

Standard Features for All Models

- 100 CFM dust collector included with all steel cabinets
- HD 14 gauge steel* - welded seams**
- Full width top door
- Optional additional side door
- Optional foot pedals or ALC pistol grip trigger gun
- High quality lined 24" gloves
- Cushioned foam armholes

Knockdown cabinets:

- * 20 gauge steel
- ** Assemble with fasteners



Cabinet Blaster Specifications and Part Numbers

Model	Work Area	Height	Door Options	Top Door Opening	Side Door Opening	Gun Options	Weight
40393*	36"W x 24"H x 24"D	60"	Top Door	13" x 35"	N/A	Trigger Gun	265
40394*	36"W x 24"H x 24"D	60"	Double Doors	13" x 35"	11" x 17"	Foot Pedal	272
40395*	48"W x 24"H x 24"D	60"	Double Doors	13" x 47"	11" x 17"	Foot Pedal	303
40400	36"W x 24"H x 24"D	60"	Top Door	13" x 35"	N/A	Trigger Gun	265
40401	36"W x 24"H x 24"D	60"	Top Door	13" x 35"	N/A	Foot Pedal	269
40402	36"W x 24"H x 24"D	60"	Double Doors	13" x 35"	11" x 17"	Trigger Gun	269
40403	36"W x 24"H x 24"D	60"	Double Doors	13" x 35"	11" x 17"	Foot Pedal	272
40408	48"W x 24"H x 24"D	60"	Top Door	13" x 47"	N/A	Trigger Gun	296
40409	48"W x 24"H x 24"D	60"	Top Door	13" x 47"	N/A	Foot Pedal	300
40410	48"W x 24"H x 24"D	60"	Double Doors	13" x 47"	11" x 17"	Trigger Gun	300
40411	48"W x 24"H x 24"D	60"	Double Doors	13" x 47"	11" x 17"	Foot Pedal	303
40413	60"W x 24"H x 24"D	60"	Double Doors	13" x 59"	11" x 17"	Foot Pedal	333

*Knockdown models - Assembly required. Dust collector not included.

41412 Dust Collector - Polymer

40412 Dust Collector - Steel



- Free standing unit
- Vacuum draw - 100 CFM
- Horsepower - 1.3
- Hose - 2-1/2" x 6'
- Filter bag design
- Filtration - 5 micron @ 95% efficiency
- Fully enclosed motor housing
- 110 volt 50/60 Hz
- Hose is packed in bottom canister
- Model 41412 ships regular UPS



40390 Benchtop Cabinet Blaster

- Made of tough LDPE polymer
- 30" x 20" work area
- One-piece construction (no leaks)
- Self-adhesive underlay
- Pistol grip trigger gun
- **11666** Optional foot pedal
- Overside top window/door
- **40338** Optional light kit available
- 34 lbs.
- Ships UPS



40389 Benchtop Cabinet Blaster

- Made of tough LDPE polymer
- 23" x 19" work area
- One-piece construction (no leaks)
- Self-adhesive underlay
- Pistol grip trigger gun
- Optional foot pedal
- Overside top window/door
- **40338** Optional light kit available
- 24 lbs.
- Ships UPS



40391 Floor Model Cabinet Blaster

- Made of tough LDPE polymer
- HD 14gg steel legs
- 36" x 24" work area
- One-piece construction (no leaks)
- Self-adhesive underlay
- Pistol grip trigger gun
- **11666** Optional foot pedal
- Overside top window/door
- 55 lbs.

Recommend use of Shop Vacuum as Dust Collector for 40389, 40390, 40391 and 40392



40392 Clam Shell Design Cabinet Blaster

- Made of tough LDPE polymer
- Unique clam shell design
- Entire top tilts back to an open 48" x 24" work area
- HD 14gg steel legs
- Rear support frame
- Requires 48" x 48" floor space
- Recommended use with shop vacuum (not provided)
- 200 lbs.

Polymer Cabinet Specifications and Part Numbers

Model	Work Area	Height	Door	Gun	Dust Collector	Light	Weight
40389	23"W x 20"H x 19"D	24"	Top	*Trigger	**Use Shop Vacuum	No	25
40390	30"W x 27"H x 20"D	28"	Top	*Trigger	**Use Shop Vacuum	Yes	34
40391	36"W x 24"H x 24"D	58"	Top	*Trigger	**Use Shop Vacuum	Yes	55
40392	48"W x 28"H x 24"D	58"	Clam Shell	*Trigger	**Use Shop Vacuum	Yes	200

* 11666 Foot Pedal Kit - Optional

** Dust collector not provided, use your own shop vacuum

- 41905 Strainer
- 41907 Funnel Strainer
- 41908 Fine Mesh Strainer



- These strainers separate debris from any media, new or reused
- Prevents clogged nozzles from pieces of paint, rust and other particles. Use with all blasters- siphon, pressure and cabinets
- Great for reusing abrasives
- Blaster not included



40012 Bottle Blaster (F-5)



- Handheld unit
- Use abrasives or liquids
- One quart capacity
- Maximum 125 psi
- 15 CFM@80 psi
- Lightweight and portable
- Easy setup
- Steel nozzle - 1/4"



40015 Portable Blaster (F-30)



- Use abrasives or liquids
- Hose length - 10 ft.
- Unlimited capacity
- Maximum 125 psi
- 7 CFM@80 psi minimum
- Lightweight and portable
- Easy setup
- Steel nozzles - 13/64", 1/4"



40017 50# Blaster Kit (F-50)



- Use dry abrasives only
- Hose length - 7 ft.
- Tank capacity - 50 lbs.
- Free standing open top tank
- Maximum 125 psi
- 7 CFM@80 psi minimum
- Lightweight and portable
- Easy setup
- Steel nozzles - 13/64", 1/4", 5/16"



40018 90# Portable Blaster (F-90)



- Use dry abrasives only
- Hose length - 10 ft.
- Tank capacity - 90 lbs.
- Strong tubular steel cart
- Wheels - 6"
- Maximum 125 psi
- 7 CFM@80 psi minimum
- Lightweight and portable
- Easy setup
- Steel nozzles - 13/64", 1/4", 5/16"



40013 Spot Blaster (F-6)



- Handheld unit
- Self recycling - Dustfree
- One pound of abrasive included
- Ceramic nozzle - 5/16"
- 20 CFM@80 psi
- Perfect for small jobs
- Optional head accessories available
- See page 50/51 for additional accessories



40364 Spark Plug Cleaner



- Cleans any size spark plug
- Can blast with or without abrasive
- **40124** 1# abrasive



Model	Air Pressure	Hose Size	Steel Nozzle Size	Air jet Size	Hood/Goggles	Blast Time	Minimum Air Volume*	Container Volume	Approx. Abrasive Capacity	Height	Shipping Weight
40012	80-125 psi	—	1 ea. - 1/4"	1 ea. - 1/8"	—	5-10 min.	7-15-20 CFM	1qt.	4 lbs.	—	2 lbs.
40015	80-125 psi	3/8" ID x 10'	2 ea. - 13/64" 1 ea. - 1/4"	1 ea. - 5/64" 1 ea. - 1/8"	—	Unlimited	7-15-20 CFM	Unlimited	Unlimited	—	4 lbs.
40017	80-125 psi	3/8" ID x 7'	1 ea. - 13/64" 1 ea. - 1/4" 1 ea. - 5/16"	1 ea. - 5/64" 1 ea. - 1/8" 1 ea. - 5/32"	40020 hood 40021 goggles	40 min.	7-15-20 CFM	3 gal.	50 lbs.	18"	8 lbs.
40018	80-125 psi	3/8" ID x 10'	1 ea. - 13/64" 1 ea. - 1/4" 1 ea. - 5/16"	1 ea. - 5/64" 1 ea. - 1/8" 1 ea. - 5/32"	40020 hood 40021 goggles	70-80 min.	7-15-20 CFM	8 gal.	90 lbs.	28"	20 lbs.
40013	80-125 psi	—	1 ea. - 5/16"	1 ea. - 5/32"	—	Unlimited	7-15-20 CFM	1 lb.	1 lb.	—	3 lbs.

* Depends on size of nozzle: 13/64", 1/4", 5/16"



40000 Deadman Blaster (F-45DM)



- Manual pull up tank closure
- Adjustable abrasive flow valve
- Pressure relief valve - 125 psi
- Pressure gauge
- Pressure relieving ball valve
- Blast hood included
- Blast hose - 1/2" ID x 8'
- Tank volume - .45 cu. ft.
- Wheels - 6"
- Rugged tubular steel cart
- Approximate capacity - 45 lbs.

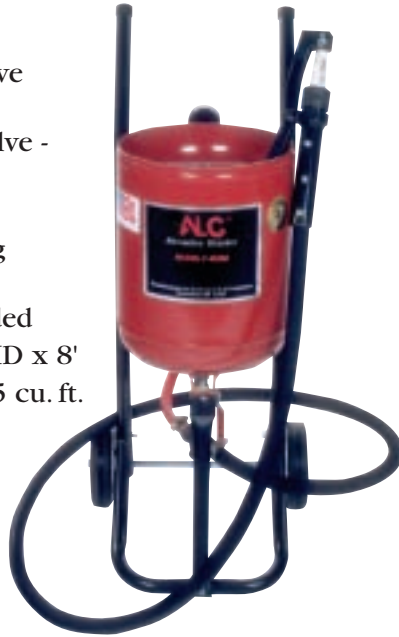

40001 Deadman Blaster (F-65DM) 40006 Remote Blaster (F-65R)



- Manual pull up tank closure
- Adjustable abrasive flow valve
- Pressure relief valve - 125 psi
- Pressure gauge
- Pressure relieving ball valve
- Blast hood with bump hat
- Blast hose - 1/2" ID x 10'
- Tank volume - .65 cu. ft.
- Wheels - 6"
- Welded steel frame
- ASME Certified tank
- Approximate capacity - 65 lbs.

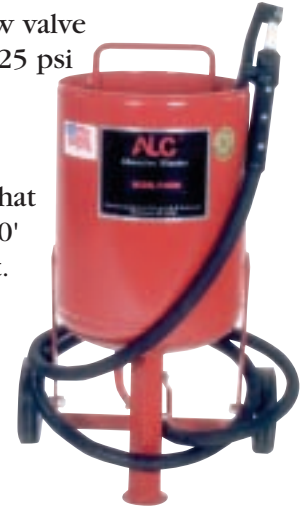

Model	Shipping Weight	Ship UPS	Blast Time	Hose Size	Ceramic Nozzle Size	Hood	Moisture Separator
40000	44 lbs.	Yes	15-20 Min.	1/2" ID x 8'	1 ea. - 1/8" 1 ea. - 3/32"	40019	Optional
40001 40006	55 lbs.	Yes	20-30 Min.	1/2" ID x 10'	2 ea. - 1/8" 1 ea. - 3/32"	40024	Optional
40002	53 lbs.	Yes	30-45 Min.	1/2" ID x 8'	1 ea. - 1/8" 1 ea. - 3/32"	40019	Optional
40003 40007	63 lbs.	Yes	35-50 Min.	1/2" ID x 10'	2 ea. - 1/8" 1 ea. - 3/32"	40024	Optional
40004 40008	76 lbs. (2 pieces)	Yes	45-60 Min.	1/2" ID x 15'	2 ea. - 1/8" 1 ea. - 5/32"	40024	40207
40005 40009	133 lbs. (2 pieces)	No	1-2 Hours	1/2" ID x 25'	2 ea. - 1/8" 3 ea. - 5/32"	40024	40207
40011	425 lbs. (skidded)	No	2-3 Hours	1" ID x 25'	1 ea. - 1/4" Tung Carb	40027	40328

Model	Air Pressure	Minimum Air Volume	Height	Tank Dimensions	Tank Volume	Approximate Abrasive Capacity	ASME Certified
40000	80-125 psi	7 CFM @ 80 psi	35"	10" x 14"	0.45 cu. ft.	45 lbs.	No
40001 40006	80-125 psi	7 CFM @ 80 psi	29.5"	12" x 17"	0.65 cu. ft.	65 lbs.	Yes
40002	80-125 psi	7 CFM @ 80 psi	34"	10" x 25"	0.9 cu. ft.	90 lbs.	No
40003 40007	80-125 psi	7 CFM @ 80 psi	32"	12" x 22"	1.1 cu. ft.	110 lbs.	Yes
40004 40008	80-125 psi	7 CFM @ 80 psi	37"	12" x 27"	1.5 cu. ft.	150 lbs.	Yes
40005 40009	80-125 psi	7 CFM @ 80 psi	40"	16" x 28"	2.5 cu. ft.	250 lbs.	Yes
40011	80-125 psi	40 CFM @ 80 psi	52"	24" x 39"	6 cu. ft.	600 lbs.	Yes



40002 Deadman Blaster (F-100DM)



- Manual pull up tank closure
- Adjustable abrasive flow valve
- Pressure relief valve - 125 psi
- Pressure gauge
- Pressure relieving ball valve
- Blast hood included
- Blast hose - 1/2" ID x 8'
- Tank volume - .9 cu. ft.
- Wheels - 6"
- Welded steel frame
- Approximate capacity - 90 lbs.



**40003 Deadman Blaster (F-110DM)
40007 Remote Blaster (F-110R)**



- Manual pull up tank closure
- Adjustable abrasive flow valve
- Pressure relief valve - 125 psi
- Pressure gauge
- Pressure relieving ball valve
- Blast hood with bump hat
- Blast hose - 1/2" ID x 10'
- Tank volume - 1.1 cu. ft.
- Wheels - 8"
- Welded steel frame
- ASME certified tank
- Approximate capacity - 110 lbs.



40004 Deadman Blaster (F-150DM)



40008 Remote Blaster (F-150R)

- Manual pull up tank closure
- Adjustable abrasive flow valve
- Pressure relief valve - 125 psi
- Pressure gauge
- Pressure relieving ball valve
- Blast hood with bump hat
- Blast hose - 1/2" ID x 15'
- Tank volume - 1.5 cu. ft.
- Wheels - 8"
- Welded steel frame
- ASME certified tank
- Approximate capacity - 150 lbs.



40005 Deadman Blaster (F-300DM)



40009 Remote Blaster (F-300R)

- Manual pull up tank closure
- Adjustable abrasive flow valve
- Pressure relief valve - 125 psi
- Pressure gauge
- Pressure relieving ball valve
- Blast hood with bump hat
- Blast hose - 1/2" ID x 25 Ft
- Tank volume - 2.5 cu. ft.
- Wheels - 10"
- Welded steel frame
- ASME certified tank
- Approximate capacity - 250 lbs.



40011 Remote Blaster (F-600R)



- Automatic tank closure
- Adjustable abrasive flow valve
- Pressure relief valve - 125 psi
- Pressure gauge
- Pressure relieving ball valve
- Pressure choke valve
- Manual pressure release
- Dual remote media valves
- Tungsten carbide nozzle - 1/4"
- Heavy-duty blast hood
- Blast hose - 1" ID x 25'
- Tank volume - 6.0 cu. ft.
- Wheels - 16"
- Welded steel frame
- ASME certified tank
- Approximate capacity - 600 lbs.



Deadman System

- Automatic shut off if handle is dropped
- Abrasive flow is sealed at nozzle end by square sealing block
- Abrasive hose remains pressurized
- Full control of blasting at the handle
- Heavy-duty design, few wear components, economical



Remote System

- Automatic shut off if handle is dropped
- Abrasive flow is sealed at tank using diaphragm abrasive valve
- Abrasive hose is relieved of pressure during shut off
- Pneumatic shut off is operated at the handle
- Full control of blasting at the handle



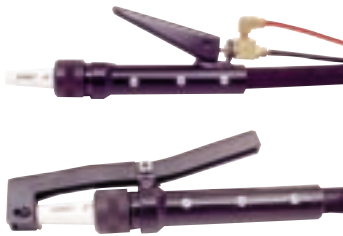

Pressure Blaster Handles - Parts

Model	Description	Model	Description
40166	Deadman handle	40188	Media Valve (remote)
40164	Rubber sealing block (3 pk)	40187	Rubber diaphragm for 40188
40196	Nozzle retainer washer	40327	Remote handle for 40011
40191	Remote handle	40305	Media valve (remote 40011)
40190	Control valve for 40191/40327	40306	Rubber diaphragm for 40305

Pressure Blaster Nozzles

Size	Nozzle CFM	DEADMAN & REMOTE		REMOTE ONLY	APPROXIMATE	
		Ceramic Nozzle Model Number	Carbide Nozzle Model Number	Carbide Nozzle for 40011(F-600)	Blast Area Feet per Minute	Media Use Pounds per Hour
3/32"	7CFM @ 80 psi	40067	N/A	N/A	0.5	100
1/8"	15CFM @ 80 psi	40068	40073	N/A	1 - 1.5	150
5/32"	25CFM @ 80 psi	40069	N/A	N/A	2 - 2.5	200
3/16"	40CFM @ 80 psi	40070	40074	40324	3 - 3.5	400
1/4"	80CFM @ 80 psi	40071	40075	40325	4 - 4.5	500
5/16"	125CFM @ 80 psi	40072	40076	40326	5 - 5.5	800

Pressure Blaster Hoses - Tank Parts

Model	Description	Model	Description
40117	1/2" ID x 10' pressure hose	40228	Tank closure gasket - all except 40011
40118	1/2" ID x 15' pressure hose	11560	Tank closure gasket for 40011
40119	1/2" ID x 20' pressure hose	40207	Moisture separator
40120	1/2" ID x 25' pressure hose	40192	Steel hose adapter
40121	1/2" ID x 50' pressure hose	40224	1/4" gauge 0-160 psi, bottom connection
40122	1/2" ID pressure hose per foot	40320	1" ID x 25' pressure hose for 40011

Cabinet Blaster Parts

Model	Description	Model	Description
40248	Gloves 24" x 6" cloth lined	11666	Foot pedal kit
11640	Rubber gloves - 18"	11594	Foot pedal for 11666
40251	Window lens for all steel cabinets 12" x 24"	11665	Gun for 11666 w/o trigger
11647	Window lens for 40391 15-1/2" x 33"	12700	Economy foot pedal kit
11643	Window lens for 40390 15" x 27"	11738	Foot pedal w/hoses
10387	Window lens for 40389 16-1/2" x 20"	12800	Gun for 12700 w/o trigger
40251	Window lens for 40392 12" x 24"	11595	Gun pressure hose for all cabinets
40252	Window underlay for all steel cabinets 10 pc roll 12" x 24"	11596	Foot pedal pressure hose for 11666
40253	Window underlay for all steel cabinets 50 pc	11604	Trigger gun for 40390/40391 15 CFM
11699	Window underlay for 40391 (5pk) 12" x 30"	40371	Suction hose for 11604
11698	Window underlay for 40390 (5pk) 12" x 24"	40153	Trigger gun for cabinets 15 CFM
10357	Window underlay for 40389 (1 pc roll) 13-1/2" x 17"	11597	Suction hose for 40153
40252	Window underlay for 40392 (10 pc roll) 12" x 24"	40254	Bronze gun (clam shell cabinets) 12 CFM
40235	Light kit for all cabinets	40258	Air jet assembly for 40254 12 CFM
40338	Economy Light Kit	40243	Carbide nozzle for 40254 12 CFM
40151	Pick-up tube for 40390, 40391, 40392	40255	Bronze gun (clam shell cabinets) 25 CFM
40343	Pick-up tube for 40389	40259	Air jet assembly for 40255 25 CFM
40287	Replacement motor for dust collector	40245	Carbide nozzle for 40255 25CFM
40267	Filter bag for dust collector	40249	Lined gloves 33" x 7"
		40250	Lined gloves 33" x 8"
		40240	Glove clamps



Siphon Blaster Gun Parts

Model	Description	Fits Model Number
40135	Complete gun with large ceramic nozzle	40013
40152	Complete gun with medium 3" nozzle	40016
40153	Complete gun with (3) medium nozzles	40017
40162	Complete gun with (3) large nozzles	40018
40138	Siphon head with nozzle and air jet	All
40139	Siphon head with nozzle and air jet	40013
40140	Siphon head with nozzle and air jet	40016
40141	Siphon head with nozzle and air jet	40012
40142	Air jet washer	All
40136	Gun handle only	All
40144	Blast gun trigger	All
40146	Valve spring and seat	All
40147	Blast gun valve nut	All

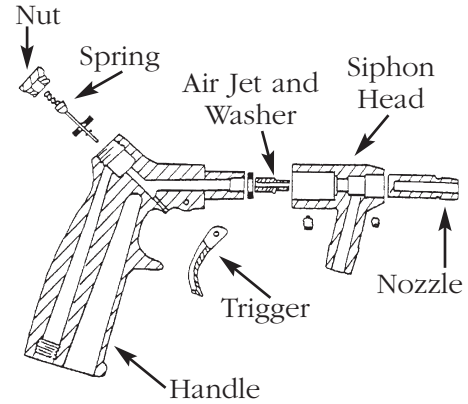

Siphon Blaster Nozzles - Air Jets

Model	Description	CFM	Diameter	Color	Material	Size	Nozzle Kits
40050	Nozzle	7 CFM @ 80 psi	13/64"	Gold	Steel	Small	40053 Contents: 3 nozzles Air jet Wrench
40051	Nozzle	15 CFM @ 80 psi	1/4"	Silver	Steel	Medium	
40052	Nozzle	20 CFM @ 80 psi	5/16"	Black	Steel	Large	
40056	Nozzle	7 CFM @ 80 psi	13/64"	—	Ceramic	Small	40059 Contents: 2 nozzles Air jet Wrench
40057	Nozzle	15 CFM @ 80 psi	1/4"	—	Ceramic	Medium	
40058	Nozzle	20 CFM @ 80 psi	5/16"	—	Ceramic	Large	
40062	Nozzle	15 CFM @ 80 psi	1/4"	Gray	Carbide	Medium	40002
40047	Air Jet	7 CFM @ 80 psi	5/64"	Gold	Steel	Small	
40048	Air Jet	15 CFM @ 80 psi	1/8"	Silver	Steel	Medium	
40049	Air Jet	20 CFM @ 80 psi	5/32"	Black	Steel	Large	

When replacing nozzles and air jets, it is important to replace with the same size.

Example: Small (gold) nozzle and small (gold) air jet.

When changing size of nozzle, the appropriate sized air jet must be replaced too.



Siphon Blaster Hoses

Model	Description	Fits Model Number
40111	3/8" ID x 10' straight	40015
40115	3/8" ID x 7' with molded elbow	40017
40116	3/8" ID x 10' with molded elbow	40018
40371	10' siphon hose	11665/11604

40022/40023 Blasting Gloves

- All-leather glove with full internal lining
- Overall length 13", Gauntlet length 6"
- **40023** Premium blasting gloves
- **40022** Standard blasting gloves
- Colors may vary

Spot Blaster Parts - Accessories

Model	Description	Fits Model Number
40081	Round adapter	Standard with 40013
40082	Edge adapter	Optional for 40013
40083	Outside corner adapter	Optional for 40013
40084	Inside corner adapter	Optional for 40013
40085	Spot adapter (1/2")	Optional for 40013
40086	Adapter kit (4 piece)	Contains 40082, 83, 84, 85
40132	Master adapter	Standard with 40013

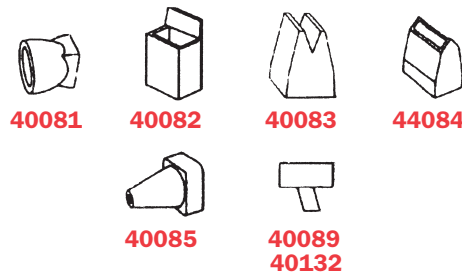



40019 Standard Hood
40024 Standard Hood w/Bump Cap

- Complete fabric hood
- Complete head coverage
- **40025** Lens 5" x 6"
- Rear breather vents
- **40024** Internal bump cap



Corn Cob

Corn Cob abrasive is used on “soft” applications such as wooden surfaces like baseboards, staircases, etc and aluminum, brass and other surfaces where no pitting is desired. Leaves a smooth, dull finish. (50 lb. Container)

Coal Slag

Coal Slag is used when paint and rust have to be removed from steel, such as car bodies, tanks or heavy machinery. **Coal Slag** is superior to silica because it has only .1% free silica, is faster cutting, can be re-used, is moisture free and will not pack or absorb moisture. (25 lb. Container)

ALC Mix #1

ALC Mix #1 is used when removing paint and rust from panels. It has more cutting power and lasts longer than sand (not recommended). Use ALC Mix #1 in any reclaim system or in any blast cabinet. (1 lb. - 4 lb. - 25 lb. Container)

Steel Grit

Steel Grit is extremely fast cutting on rusty metal and hard-to-remove paint. Steel Grit is becoming popular because it leaves a very smooth finish. It is also comparable in price to most other specialty abrasives. It should be used in reclaim systems or cabinets. (25 lb. Container)

Abrasives

Abrasives	1 lb.	4 lb.	25 lb.	50 lb.
ALC Mix #1 - Medium	40090	40091	40092	—
Coal Slag - Medium	—	—	40093	—
Aluminum Oxide - Fine	—	40094	40097	40100
Aluminum Oxide - Medium	—	40095	40098	40101
Aluminum Oxide - Coarse	—	40096	40099	40102
Glass Bead - Medium	—	40103	40105	40107
Glass Bead - Coarse	—	40104	40106	40108
Steel Grit - Medium	—	—	40109	—
Plastic Grit - Medium	—	41110*	40110	—
Walnut Shells	—	40112*	—	—
Corn Cob	—	—	—	40125

Walnut Shells

Walnut shells are recommended for use on “soft” surfaces such as aluminum, brass, wood, fiberglass and other surfaces where no pitting is desired. Leaves a smooth, dull finish. (10 lb. container)

* 10 lb.

40339 Deluxe Hood

- Premium fabric hood
- Internal bump cap
- Complete head coverage
- **40028** Lens 3" x 5"
- **40029** Screen 3" x 5"
- Rear breather vents



40556 Deluxe Industrial Hood

- Premium fabric hood
- Internal bump cap
- Complete head coverage
- **40025** Lens 5" x 6"
- Rear breather vents



Aluminum Oxide

Aluminum Oxide is a high quality abrasive that is sharper than sand (not recommended) and cuts twice as fast. It leaves a smooth textured finish with no pits or burrs. Aluminum Oxide is tougher than glass bead and can be used over and over again. It is one of the most economical abrasives you can use in any reclaim system. (4 lb. - 25 - 50 lb. Container)

Glass Bead

Glass Bead is an abrasive that should be used in blast rooms and cabinets. It is generally used in creating a satin or matte finish. (4 lb. - 25 lb. - 50 lb. Container)

Plastic Grit

Primarily used to strip aluminum. Great for stripping paint, light oxidation and surface rust. Recommended for use in blast cabinets because it creates very little dust. Works quickly, lasts a long time and increases visibility within the cabinet. (10 lb. - 25 lb. Container)